

DISCLAIMER:  
This map/plan is illustrative only and all information should be independently verified on site before taking any action.  
Copyright Auckland Council. Land Parcel Boundary information from LINZ (Crown Copyright Reserved). Whilst due care has been taken, Auckland Council gives no warranty as to the accuracy and plan completeness of any information on this map/plan and accepts no liability for any error, omission or use of the information. Height datum: NZVD 2016.

### Built Environment

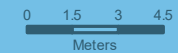

Scale @ A4  
= 1:250

Date Printed:  
4/05/2026



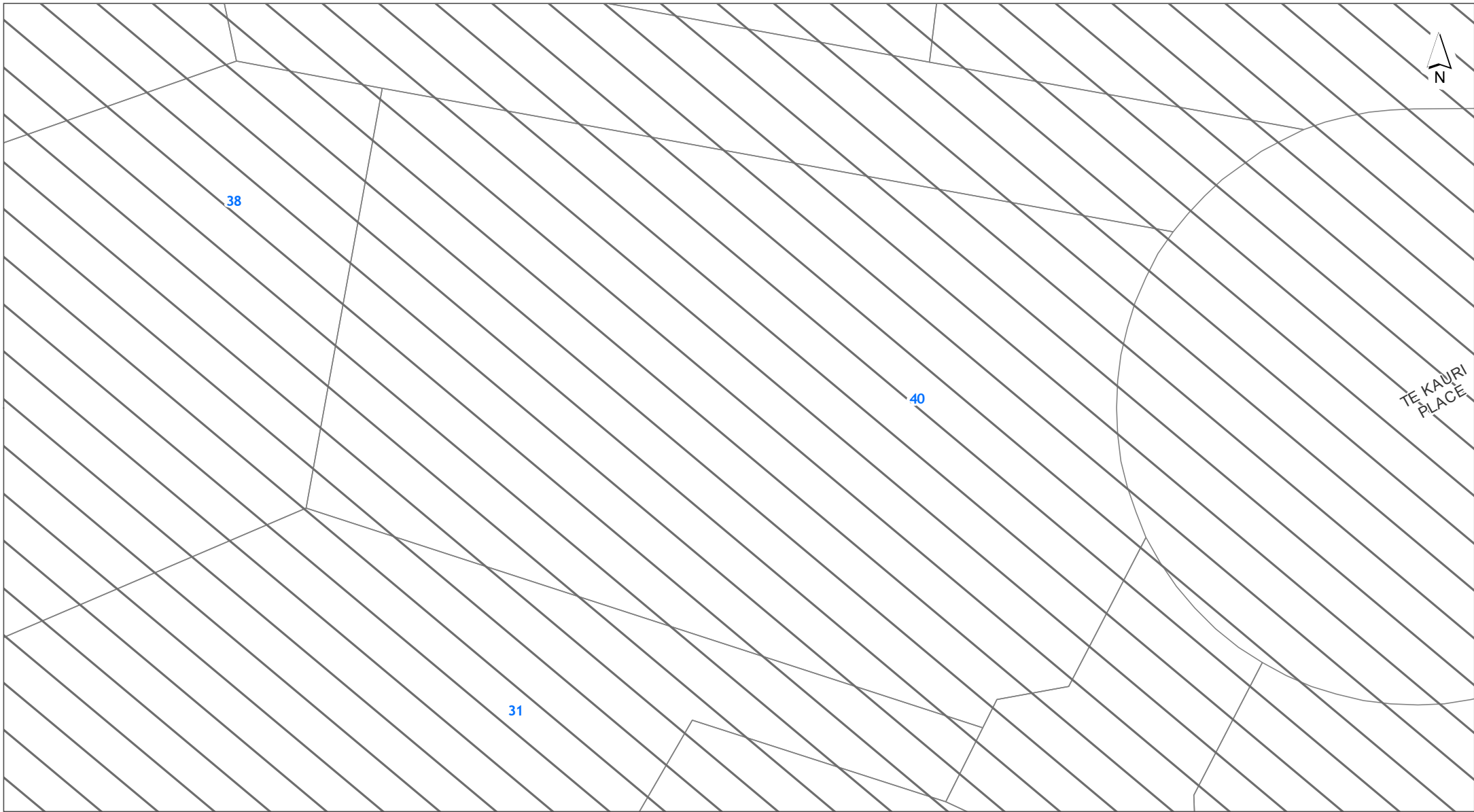

DISCLAIMER:  
This map/plan is illustrative only and all information should be independently verified on site before taking any action.  
Copyright Auckland Council. Land Parcel Boundary information from LINZ (Crown Copyright Reserved). Whilst due care has been taken, Auckland Council gives no warranty as to the accuracy and plan completeness of any information on this map/plan and accepts no liability for any error, omission or use of the information. Height datum: NZVD 2016.

### Controls



Scale @ A4  
= 1:250

Date Printed:  
4/05/2026



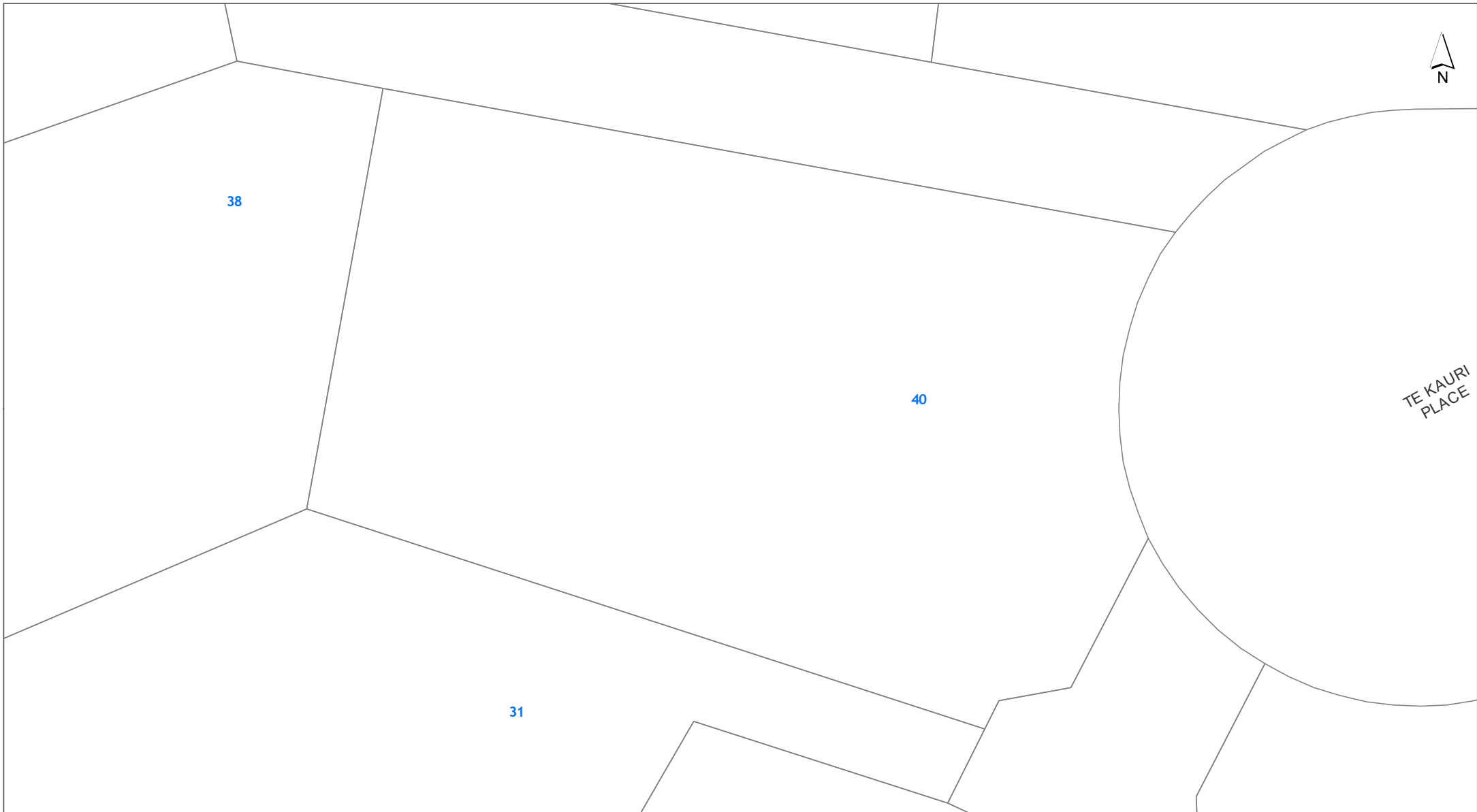

DISCLAIMER:  
This map/plan is illustrative only and all information should be independently verified on site before taking any action. Copyright Auckland Council. Land Parcel Boundary information from LINZ (Crown Copyright Reserved). Whilst due care has been taken, Auckland Council gives no warranty as to the accuracy and plan completeness of any information on this map/plan and accepts no liability for any error, omission or use of the information. Height datum: NZVD 2016.

### Designations



Scale @ A4  
= 1:250

Date Printed:  
4/05/2026



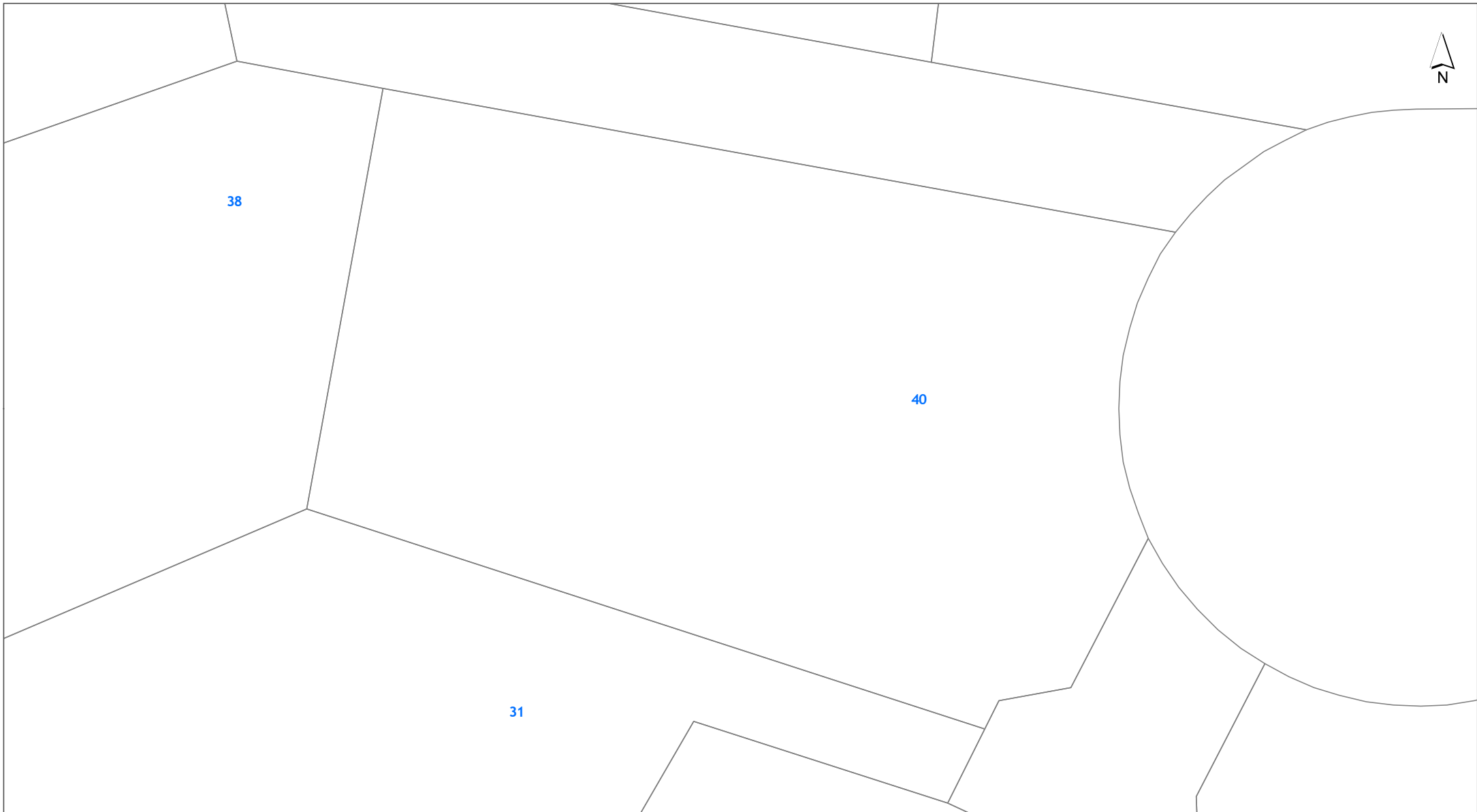

**DISCLAIMER:**  
This map/plan is illustrative only and all information should be independently verified on site before taking any action. Copyright Auckland Council. Land Parcel Boundary information from LINZ (Crown Copyright Reserved). Whilst due care has been taken, Auckland Council gives no warranty as to the accuracy and plan completeness of any information on this map/plan and accepts no liability for any error, omission or use of the information. Height datum: NZVD 2016.

### Historic Heritage and Special Character



Scale @ A4  
= 1:250

Date Printed:  
4/05/2026



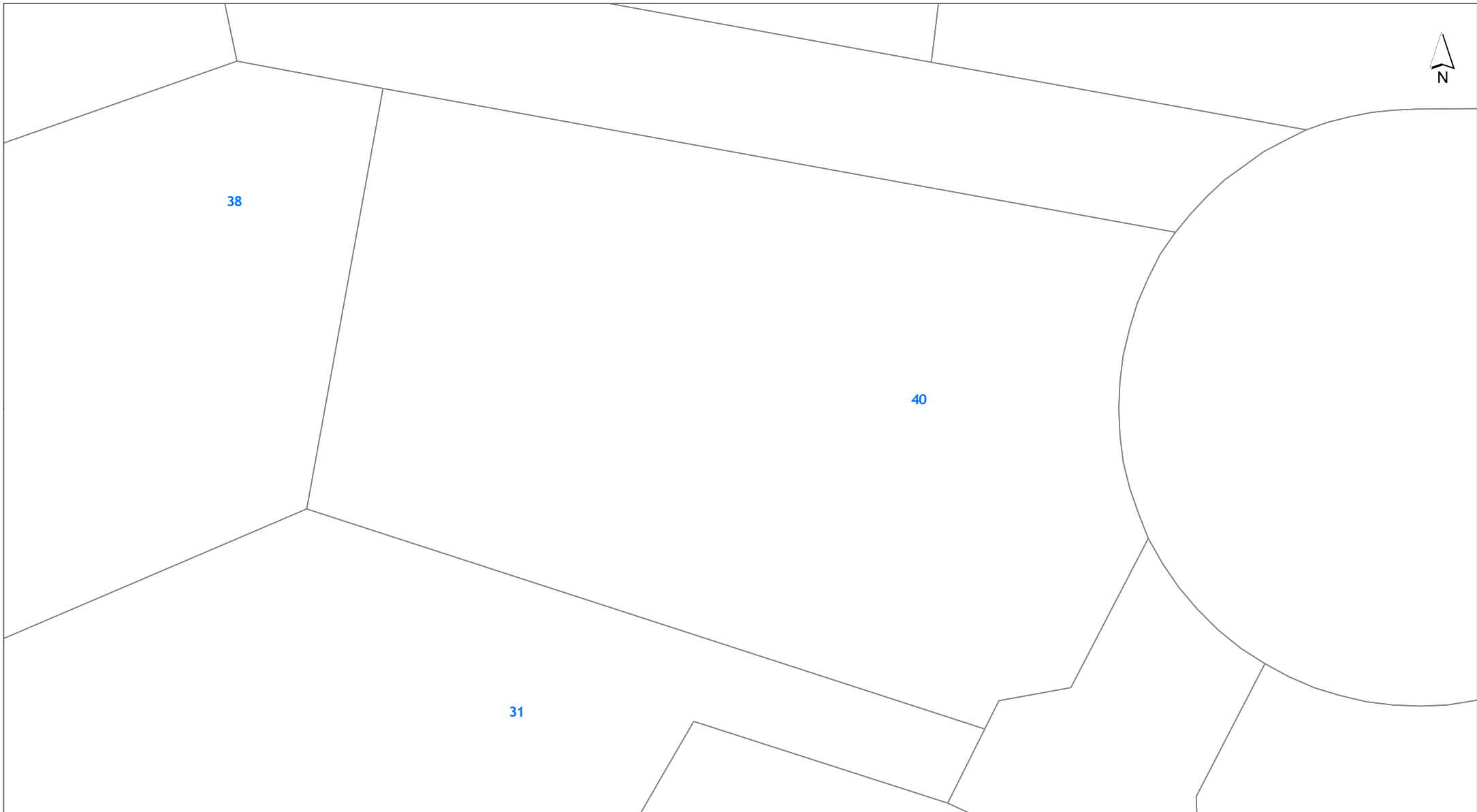

DISCLAIMER:  
This map/plan is illustrative only and all information should be independently verified on site before taking any action. Copyright Auckland Council. Land Parcel Boundary information from LINZ (Crown Copyright Reserved). Whilst due care has been taken, Auckland Council gives no warranty as to the accuracy and plan completeness of any information on this map/plan and accepts no liability for any error, omission or use of the information. Height datum: NZVD 2016.

### Infrastructure



Scale @ A4  
= 1:250

Date Printed:  
4/05/2026



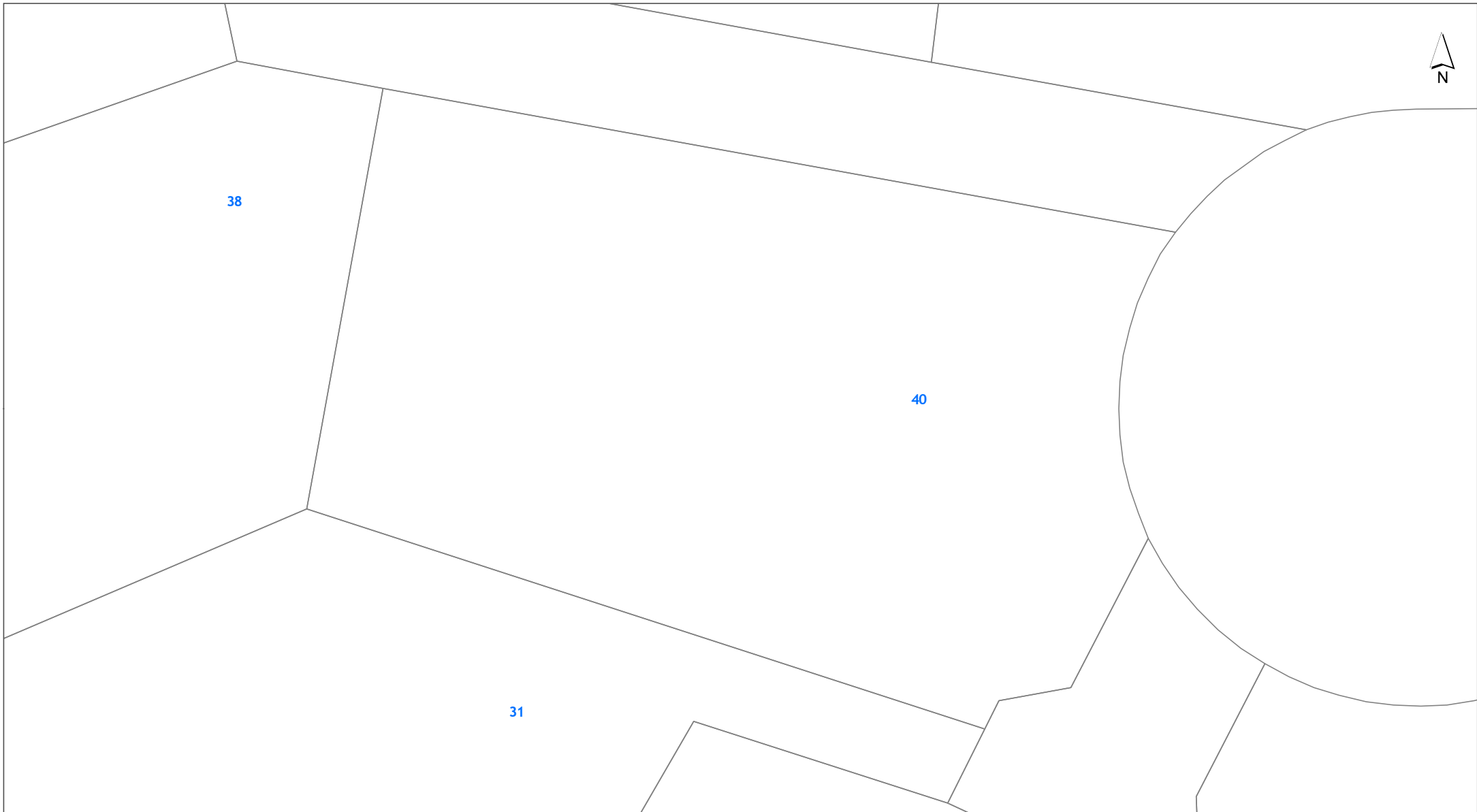

DISCLAIMER:  
This map/plan is illustrative only and all information should be independently verified on site before taking any action.  
Copyright Auckland Council. Land Parcel Boundary information from LINZ (Crown Copyright Reserved). Whilst due care has been taken, Auckland Council gives no warranty as to the accuracy and plan completeness of any information on this map/plan and accepts no liability for any error, omission or use of the information. Height datum: NZVD 2016.

### Mana Whenua



Scale @ A4  
= 1:250

Date Printed:  
4/05/2026



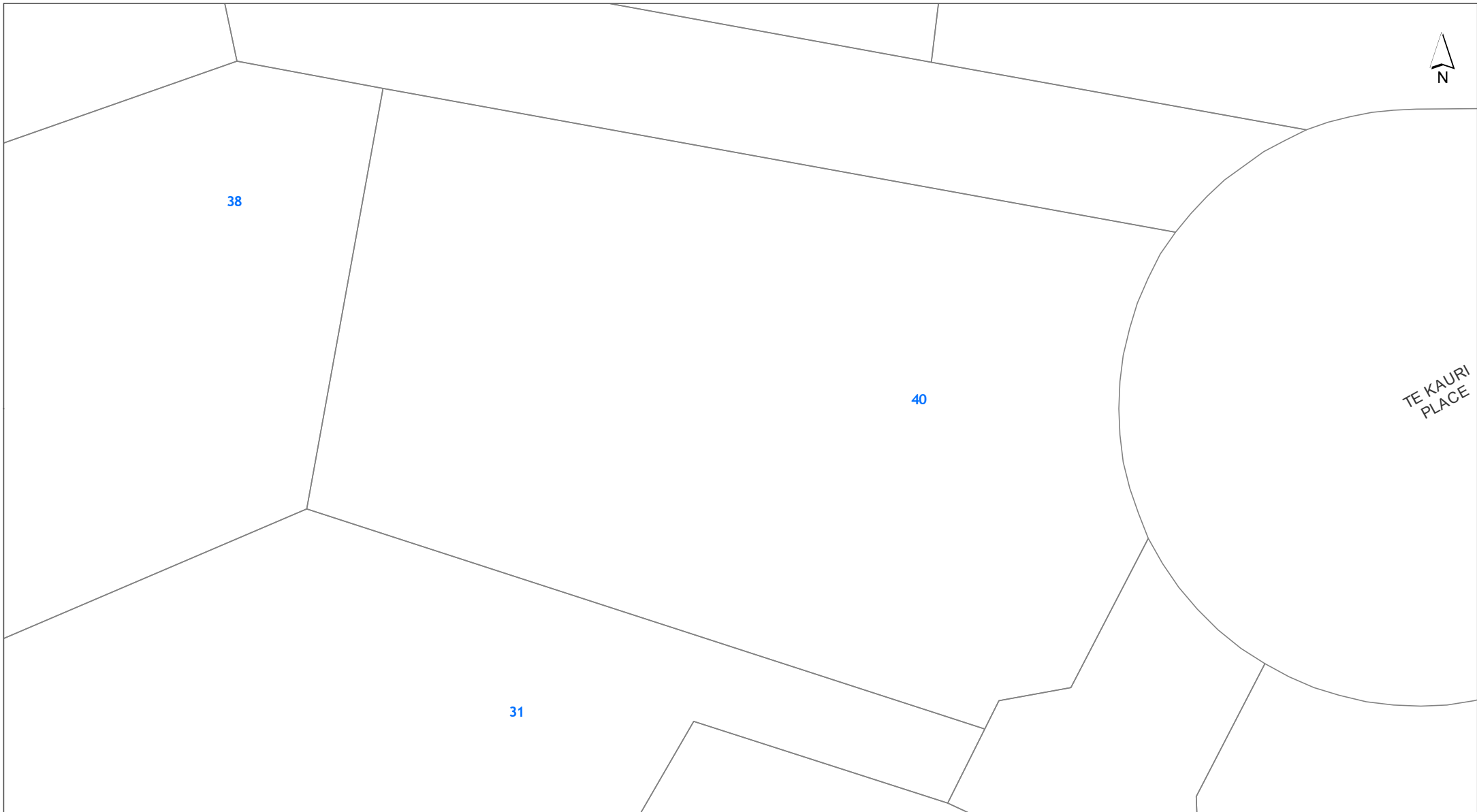

DISCLAIMER:  
This map/plan is illustrative only and all information should be independently verified on site before taking any action. Copyright Auckland Council. Land Parcel Boundary information from LINZ (Crown Copyright Reserved). Whilst due care has been taken, Auckland Council gives no warranty as to the accuracy and plan completeness of any information on this map/plan and accepts no liability for any error, omission or use of the information. Height datum: NZVD 2016.

### Natural Heritage



Scale @ A4  
= 1:250

Date Printed:  
4/05/2026



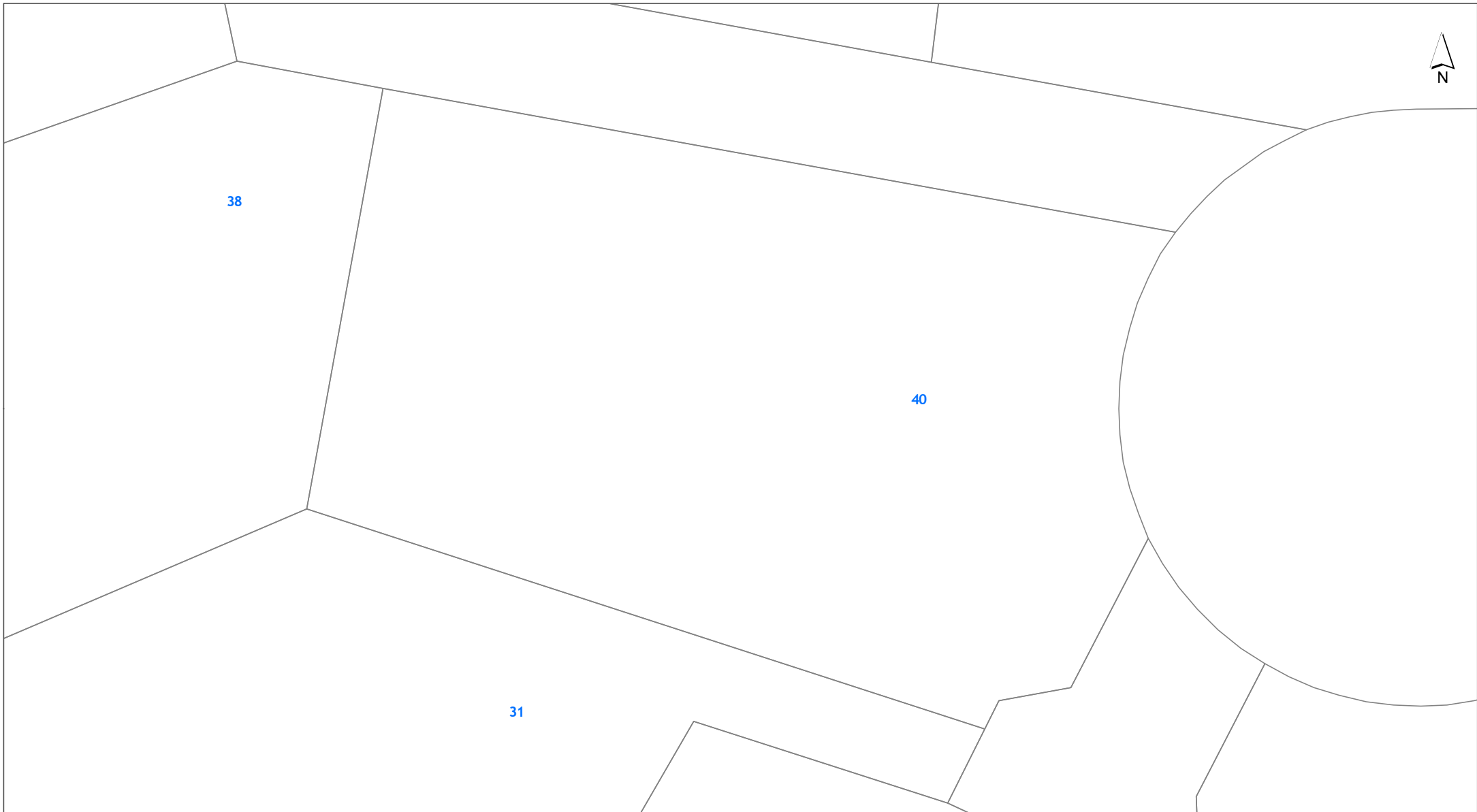

DISCLAIMER:  
This map/plan is illustrative only and all information should be independently verified on site before taking any action.  
Copyright Auckland Council. Land Parcel Boundary information from LINZ (Crown Copyright Reserved). Whilst due care has been taken, Auckland Council gives no warranty as to the accuracy and plan completeness of any information on this map/plan and accepts no liability for any error, omission or use of the information. Height datum: NZVD 2016.

### Natural Resources



Scale @ A4  
= 1:250

Date Printed:  
4/05/2026



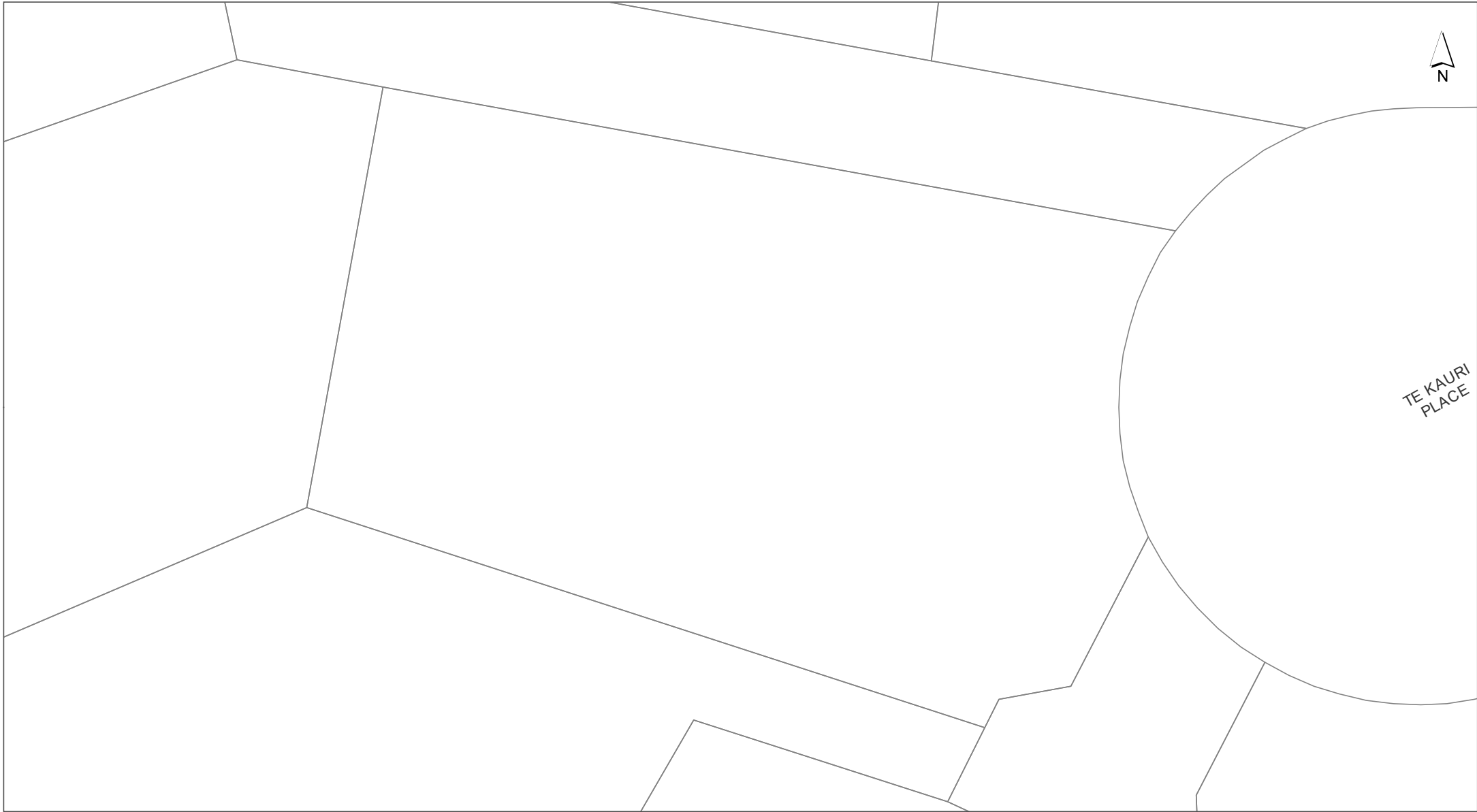

DISCLAIMER:  
This map/plan is illustrative only and all information should be independently verified on site before taking any action.  
Copyright Auckland Council. Land Parcel Boundary information from LINZ (Crown Copyright Reserved). Whilst due care has been taken, Auckland Council gives no warranty as to the accuracy and plan completeness of any information on this map/plan and accepts no liability for any error, omission or use of the information. Height datum: NZVD 2016.

### Precincts



Scale @ A4  
= 1:250

Date Printed:  
4/05/2026



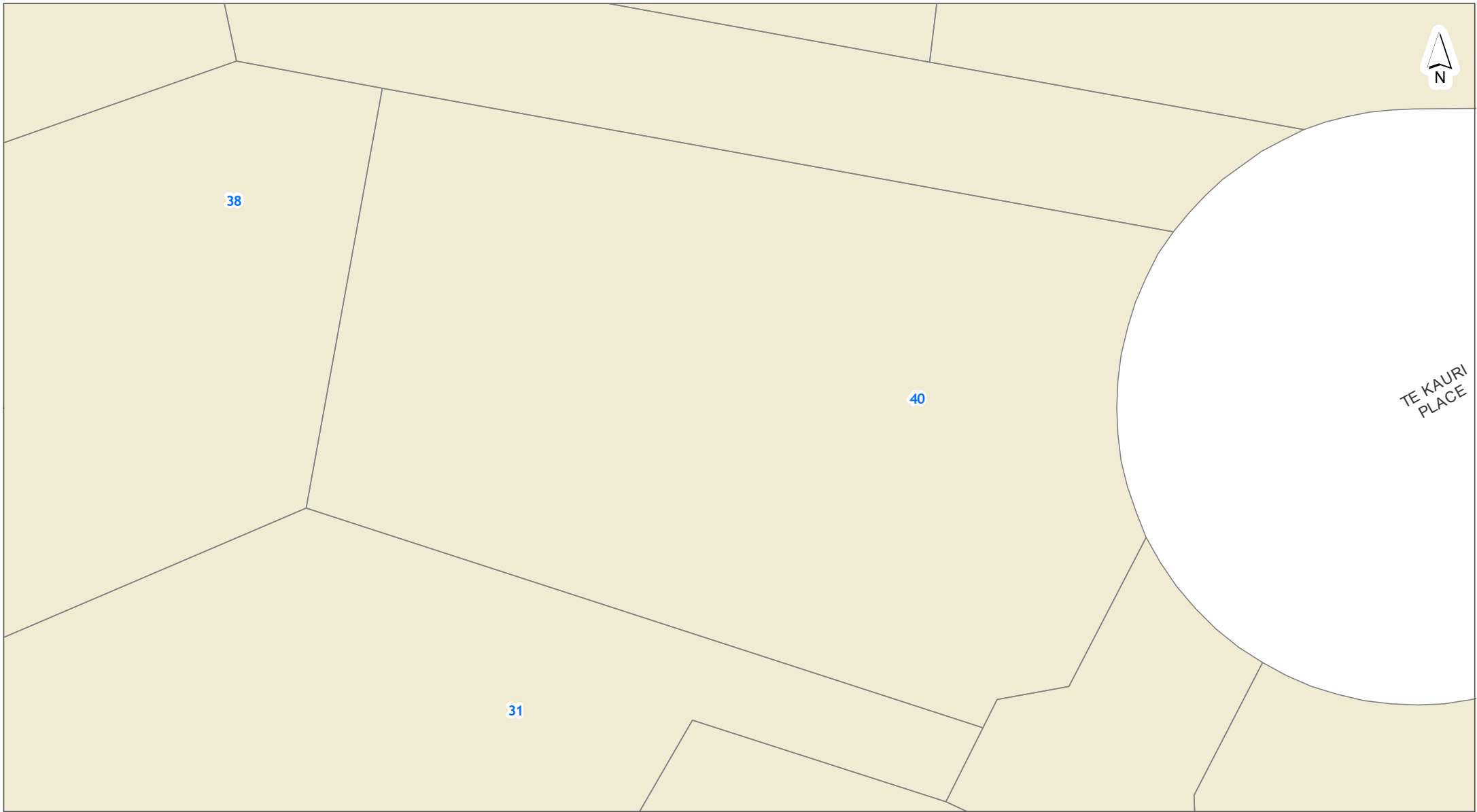

DISCLAIMER:  
This map/plan is illustrative only and all information should be independently verified on site before taking any action. Copyright Auckland Council. Land Parcel Boundary information from LINZ (Crown Copyright Reserved). Whilst due care has been taken, Auckland Council gives no warranty as to the accuracy and plan completeness of any information on this map/plan and accepts no liability for any error, omission or use of the information. Height datum: NZVD 2016.

### Zones and Rural Urban Boundary



Scale @ A4  
= 1:250

Date Printed:  
4/05/2026





## NOTATIONS

### Appeals to the Proposed Plan

 Appeals seeking changes to zones or management layers

### Proposed Modifications to Operative in part Plan

 Notice of Requirements

 Proposed Plan Changes

### Tagging of Provisions:

[ i ] = Information only

[ rp ] = Regional Plan





[ rcp ] = Regional Coastal Plan

[ rps ] = Regional Policy Statement

[ dp ] = District Plan (only noted when dual provisions apply)

## ZONING

### Residential

-  Residential - Large Lot Zone
-  Residential - Rural and Coastal Settlement Zone
-  Residential - Single House Zone
-  Residential - Mixed Housing Suburban Zone
-  Residential - Mixed Housing Urban Zone
-  Residential - Terrace Housing and Apartment Buildings Zone







### Business

-  Business - City Centre Zone
-  Business - Metropolitan Centre Zone
-  Business - Town Centre Zone
-  Business - Local Centre Zone
-  Business - Neighbourhood Centre Zone
-  Business - Mixed Use Zone
-  Business - General Business Zone
-  Business - Business Park Zone
-  Business - Heavy Industry Zone
-  Business - Light Industry Zone

### Open space

-  Open Space - Conservation Zone
-  Open Space - Informal Recreation Zone
-  Open Space - Sport and Active Recreation Zone
-  Open Space - Civic Spaces Zone
-  Open Space - Community Zone
-  Water [i]



### Rural

-  Rural - Rural Production Zone
-  Rural - Mixed Rural Zone
-  Rural - Rural Coastal Zone
-  Rural - Rural Conservation Zone
-  Rural - Countryside Living Zone
-  Rural - Waitakere Foothills Zone
-  Rural - Waitakere Ranges Zone

### Future Urban

-  Future Urban Zone
-  Green Infrastructure Corridor (Operative in some Special Housing Areas)

### Infrastructure

-  Special Purpose Zone - Airports & Airfields  
Cemetery  
Quarry  
Healthcare Facility & Hospital  
Tertiary Education  
Māori Purpose  
Major Recreation Facility  
School
-  Strategic Transport Corridor Zone

### Coastal

-  Coastal - General Coastal Marine Zone [rcp]
-  Coastal - Marina Zone [rcp/dp]
-  Coastal - Mooring Zone [rcp]
-  Coastal - Minor Port Zone [rcp/dp]
-  Coastal - Ferry Terminal Zone [rcp/dp]
-  Coastal - Defence Zone [rcp]
-  Coastal - Coastal Transition Zone



Precincts

--- Rural Urban Boundary

--- Indicative Coastline [i]

# Overlays

## Natural Resources

- Terrestrial [rp/dp]
  - Marine 1 [rcp]
  - Marine 2 [rcp]
  - Water Supply Management Areas Overlay [rp]
  - Natural Stream Management Areas Overlay [rp]
  - High-Use Stream Management Areas Overlay [rp]
  - Natural
  - Urban
  - High-Use Aquifer Management Areas Overlay [rp]
  - Quality-Sensitive Aquifer Management Areas Overlay [rp]
  - Wetland Management Areas Overlay [rp]
- } Significant Ecological Areas Overlay

## Natural Heritage

- Verified position of tree
  - Unverified position of tree
  - Group of Trees
  - Outstanding Natural Features Overlay [rcp/dp]
  - Outstanding Natural Landscapes Overlay [rcp/dp]
  - Outstanding Natural Character Overlay [rcp/dp]
  - High Natural Character Overlay [rcp/dp]
  - Viewshafts
  - Height Sensitive Areas
  - Regionally Significant Volcanic Viewshafts Overlay Contours [i]
  - Locally Significant Volcanic Viewshafts Overlay [rcp/dp]
  - Locally Significant Volcanic Viewshafts Overlay Contours [i]
  - Modified
  - Natural
  - Local Public Views Overlay [rcp/dp]
  - Extent of Overlay
  - Subdivision Schedule
- } Notable Trees Overlay
- } Regionally Significant Volcanic Viewshafts & Height Sensitive Areas Overlay [rcp/dp]
- } Waitakere Ranges Heritage Area Overlay

## Infrastructure

- Airport Approach Surface Overlay
  - Aircraft Noise Overlay
  - City Centre Port Noise Overlay [rcp / dp]
  - Quarry Buffer Area Overlay
  - National Grid Subdivision Corridor
  - National Grid Substation Corridor
  - National Grid Yard Compromised
  - National Grid Yard Uncompromised
- } National Grid Corridor Overlay

## Historic Heritage & Special Character

- Historic Heritage Overlay Place [rcp/dp]
- Historic Heritage Overlay Extent of Place [rcp/dp]
- Special Character Areas Overlay Residential and Business
- Auckland War Memorial Museum Viewshaft Overlay [rcp/dp]
- Auckland War Memorial Museum Viewshaft Overlay Contours [i]
- Stockade Hill Viewshaft Overlay – 8m height area
- Stockade Hill Viewshaft [i]

## Mana Whenua

- Sites & Places of Significance to Mana Whenua Overlay [rcp/dp]

## Built Environment

- Identified Growth Corridor Overlay

# Controls

- Key Retail Frontage
  - General Commercial Frontage
  - Adjacent to Level Crossings
  - General
  - Motorway Interchange Control
  - Centre Fringe Office Control
  - Height Variation Control
  - Parking Variation Control
  - Level Crossings With Sightlines Control
  - Arterial Roads
  - Business Park Zone Office Control
- } Building Frontage Control
- } Vehicle Access Restriction Control

- Hazardous Facilities
  - Infrastructure
  - Macroinvertebrate Community Index
  - Flow 1 [rp]
  - Flow 2 [rp]
  - Subdivision Variation Control
  - Indigenous Vegetation 749.7 ha
  - Freshwater Wetland 14.6 ha
  - Surf Breaks [rcp]
  - Cable Protection Areas Control [rcp]
  - Coastal Inundation 1 per cent AEP Plus 1m Control
- } Emergency Management Area Control
- } Stormwater Management Area Control
- } Kawau Island Rural Subdivision SEAs Control

# Designations

- Designations

- Airspace Restriction Designations

## Auckland Unitary Plan Operative in part (15th November 2016) Property Summary Report

### Address

40 Te Kauri Place Helensville 0800

### Legal Description

Lot 27 DP 336142

### Appeals

### Modifications

Plan Changes, PC 120 - Some parts have immediate legal effect, Multiple Layers, [View PDF](#), Proposed, 3/11/2025

### Zones

Residential - Single House Zone

### Precinct

### Controls

Controls: Macroinvertebrate Community Index - Urban

### Overlays

### Designations