



**RECORD OF TITLE  
UNDER LAND TRANSFER ACT 2017  
CROSS LEASE**

**Guaranteed Search Copy issued under Section 60 of the Land  
Transfer Act 2017**



  
R.W. Muir  
Registrar-General  
of Land

**Identifier**                    **CB16F/1168**  
**Land Registration District** **Canterbury**  
**Date Issued**                22 July 1976

**Prior References**  
CB192/205

---

**Estate**                        Fee Simple - 1/2 share  
**Area**                         518 square metres more or less  
**Legal Description**        Part Section 1225 Town of Ashburton

**Registered Owners**  
Dean Peter Vaughn Gilbert

---

<b>Estate</b>	Leasehold	<b>Instrument</b>	L 90292.2
		<b>Term</b>	999 years from 30.3.1976

**Legal Description**        Flat 2 Deposited Plan 37900

**Registered Owners**  
Dean Peter Vaughn Gilbert

---

**Interests**

90292.1 Lease of Flat 1 DP 37900 Term 999 years from 30.3.1976 Composite CT CB16F/1167 issued - 22.7.1976 (affects fee simple)

90292.2 Lease of Flat 2 DP 37900 Term 999 years from 30.3.1976 Composite CT CB16F/1168 issued - 22.7.1976 (affects fee simple)

Le De ye C. Le De fl 16

Boi Tr: Fil -

Mo Co at

HAVELOCK ST. 20.12

11.08

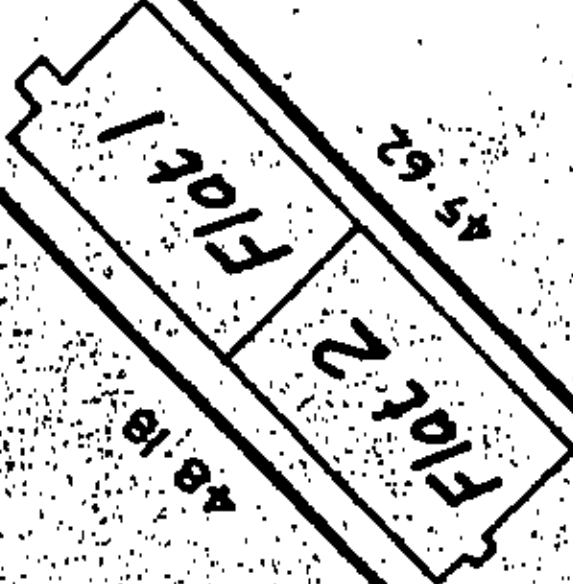

45.62

48.18

SEALY ST. 20.12

Fee simple affected by:



**RECORD OF TITLE  
UNDER LAND TRANSFER ACT 2017  
CROSS LEASE**

**Guaranteed Search Copy issued under Section 60 of the Land  
Transfer Act 2017**



  
R. W. Muir  
Registrar-General  
of Land

**Identifier** **CB16F/1167**  
**Land Registration District** **Canterbury**  
**Date Issued** 22 July 1976

**Prior References**  
CB192/205

---

**Estate** Fee Simple - 1/2 share  
**Area** 518 square metres more or less  
**Legal Description** Part Section 1225 Town of Ashburton

**Registered Owners**  
Gleida Das Gracas Amaral

---

<b>Estate</b>	Leasehold	<b>Instrument</b>	L 90292.1
		<b>Term</b>	999 years from 30.3.1976

**Legal Description** Flat 1 Deposited Plan 37900

**Registered Owners**  
Gleida Das Gracas Amaral

---

**Interests**

90292.1 Lease of Flat 1 DP 37900 Term 999 years from 30.3.1976 Composite CT CB16F/1167 issued - 22.7.1976 (affects fee simple)

90292.2 Lease of Flat 2 DP 37900 Term 999 years from 30.3.1976 Composite CT CB16F/1168 issued - 22.7.1976 (affects fee simple)

13309727.2 Mortgage to Kiwibank Limited - 30.5.2025 at 11:03 am

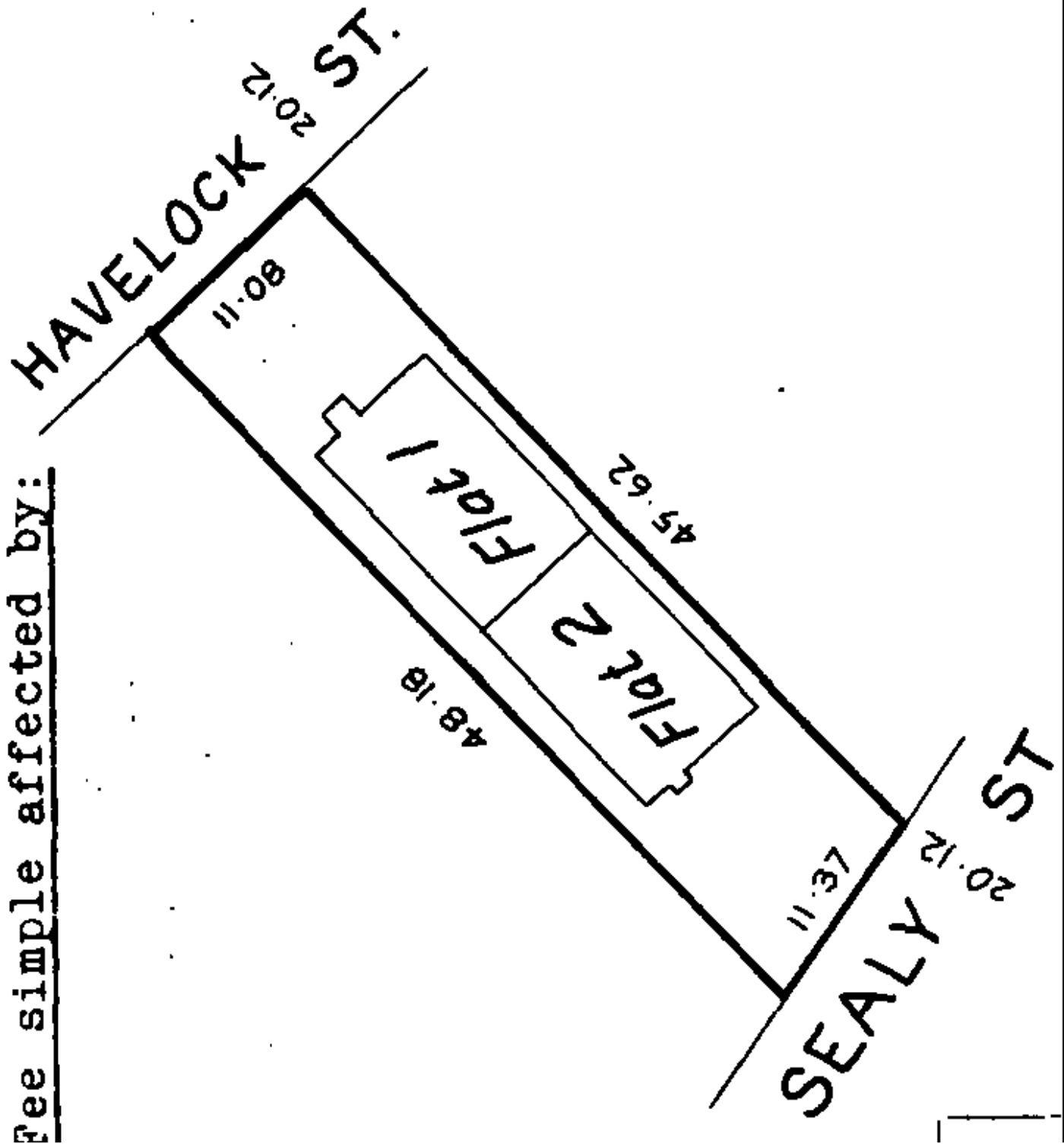

Fee simple affected by: