

APPLICATION FOR BUILDING PERMIT

No. 418

To be removed WANGANUI,

from Smithfield Rd. October 29th. 1943

TO THE CITY ENGINEER,

I hereby apply for permission to erect Car Shed
 at 17 Bell St.
 for Mrs. D. A. Cavell of 17 Bell St.
 according to locality plan and detailed plans, elevations, cross sections and specifications of building deposited herewith, in duplicate.

Particulars of Land: Lot No. on Town Section Pt. Sec. 99 D.P.

Length of boundaries Area

Particulars of building—Foundations

Walls Iron Roof Iron

Area of ground floor sq. ft. Area of outbuildings sq. ft.

Estimated cost—
 Building £ 20 - - -
 Plumbing and drainage £ - - -
 Total £ 20 - - -

Proposed purposes for which every part of building is to be used or occupied (describing separately each part intended for use or occupation for a separate purpose)

Garage

Nature of ground on which building is to be placed and of the subjacent strata

D. A. Cavell

Builder or owner

Address 17 Bell St. present address 57 A. Victoria St.

Phone 5396

PARTICULARS OF WORK:

Cost £ 20-0-0	Building Fee £ - : 10 : -
No. of Bricks	Water Fee £ : : .
Chimneys	Inspection Fee £ : : .
Cubic yds. of Concrete	Crossing Fee £ 2 : 10 : -
	Total £ 3 : - : -

R.7652

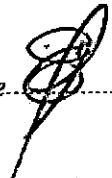
Received Fee  Receipt No. 5199

20 412

TO THE CITY ENGINEER
I hereby apply for

for ~~the~~ ~~building~~
according to location plan and
sections of building deposited
Part map of land: Lot No.
Location of foundation
Particulars of building - Foundations
Area of ground floor

from

8211/CSH/c

Mr. H. & Mrs. A Horrocks
Lot 10. sec. 9
Smithfield Road.

29.10.43

Lb

~~Living at present at~~
~~57A Bellfield St~~

Phone 5396

2/11/356

Moving To

Mrs. D. A. Savell
PX. sec 99
Bell St. & Park Pl.

29.10.43

Lb

Building and drainage
Estimated area for which work
is intended for
Nature of work on which building
is intended to be carried out
Area
Cost of work
No. of stories
Cubic yds. of concrete
Received For

MINISTRY OF SUPPLY.
OFFICE OF THE BUILDING CONTROLLER.

IN YOUR REPLY PLEASE
REFER TO

P.O. Box 320,
Palmerston North.
1st November, 1943.

The Chief Building Inspector,
City Council,
WANGANUI.

Letter stipulated "no new iron".

Dear Sir,

MRS. D.A. CAVELL.

This applicant may be permitted to have a garage removed from 15
Smithfield Road to her present address at 17 Bell Street.

GB.

29th Oct., 43.

The District Building Controller,
Box 320,
PALMERSTON NTH.

Dear Sir:

An application has been received from Mrs. D.A. Cavell of 17 Bell Street to remove a motor garage from 15 Smithfield Road, Wanganui, to her present address. This project entails no expenditure of further materials.

Yours faithfully,



CHIEF BUILDING INSPECTOR.

Please issue permit. W.S.S. 2/1/43.

57 A Wicksteed st

Oct 29th 1943

Dear Sir

I wish to make an application for a permit to shift a Garage from 15 Smithfield Rd to my property at 17 Bell st. Plan of Garage enclosed.

Yours faithfully

M^r: D. A. Cancell

Plan of Garage is as follows.

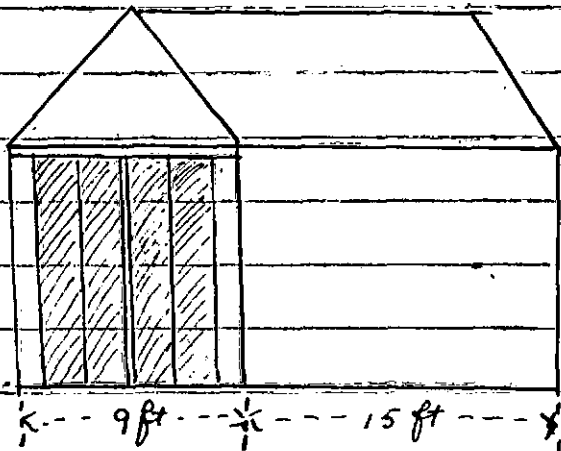

all corrugated iron with folding wood doors, also small wooden door at rear.

VALUATION ROLL No.

LEGAL DESCRIPTION

1328/457

LOT 2 D.P. 12724

14673
17 BELL STREET

DRAINAGE & PLUMBING PERMITS

BUILDING PERMITS

Existing Use

Dwelling

Permit No.

Date

Permit No.

Date

Nature of Work

Designation

3810/29.10.43 ER. GARAGE

B003165/30-8-65 ADD. DWG

Zoning

Residential B

Undersize Section

Building Line Restriction

Proposed Street

Proposed Service Lane

Proposed Access Way

Dangerous
Goods Licence

Fill Points

Housing File No.

Underground Tank

Type

Capacity
gals

Water Connection

Reg. No.

Amt. Paid.

Conditional Use

File:

Water Meter

Water Bore

Drainage Connection

Reg. No.

Amt. Pd.

Specified Departure

File:

Pool

Filtered

Unfiltered

Back Flow
PreventerStormwater
Connection

Reg. No.

Amt. Pd.

Dispensations

Reference

Date

Heating

Gas

Oil-fired

Coal-
Wood

Electric

Other

Kerb Crossing

Reg. No.

Amt. Pd.