

Enhancing the quality of the environment

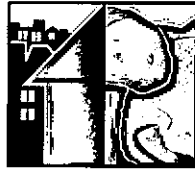

ENVIRONMENTAL SERVICES

WANGANUI DISTRICT COUNCIL

RECEIVED
WANGANUI DISTRICT COUNCIL

16 OCT 2002

APPLICATION for P.I.M/Building Consent

This application is for a: (tick the appropriate box)

- Project Information Memorandum - PIM (preliminary application for a Building Consent)
- Building Consent
- Alteration to Approved Plan

BC # 22399

(A) Owner 48440
Name: MRS BROADFOOT
Mailing Address: 38 DELHI AVE
Phone: Fax:

(B) Designer
Name:
Mailing Address:
Phone: Fax:

(C) Builder
Name:
Mailing Address:
Phone: Fax:

(D) Craftsman Plumber

(E) Registered Drainlayer GRAHAM BULL 98
3438705

027 4434065 111 Glasgow Street
CONTACT PERSON i.e. A B C D E (Circle one)

Project (A)
Description of PROJECT and USE: DISCONNECT

SEPTIC TANK AND CONNECT DRAIN TO SEWER

Project Location
Street Address/Rural No: DELHI AVE

Durable Life of Project (i.e. 5, 15, 50+ years)

Value of Project Work
(include all labour & materials)

\$ 1500.00 (Incl. GST)

Consent Fees to be paid by? GRAHAM BULL
89540

Code Compliance Certificate to be sent to?

FLOOR AREA OF PROJECT
New Residential Dwellings or
New Commercial Only m²

LEGAL DESCRIPTION
WDC Property No. 18062
Valuation Roll No. 1288037101
Lot(s) 1 DP 52142
Section Block
Survey District

Signed by (on behalf of) the applicant
Signature: [Signature]

Owner, builder, plumber, designer, agent
(circle one)

Date: 16/10/02

FEES APPLICABLE (office use only)	
Building Consent Application	\$ 100.00
Building Consent Issue	\$
P.I.M.	\$
Non-notified Appl. Fee	\$
Prepaid Crossing	\$
Prepaid Sewer Connection	\$
Prepaid Water Connection	\$
Stormwater Connection	\$
BIA Levy	\$
Additional Charges	\$
Total Fees (Incl. G.S.T)	\$

PTO

The information will be included in a Public Register of Consents issued which is available for public perusal under the Privacy Act 1993 section 54. This may result in receipt by the Owner of trade advertising.

101 Guyton Street P.O. Box 637 Wanganui New Zealand Phone 06 349 0001 Fax 06 349 0536

● PARKING ● ANIMAL CONTROL ● TOWN PLANNING ● LIQUOR LICENSING ● BUILDING CONTROL ● ENVIRONMENTAL HEALTH

Project Details

The project involves the following

(tick each applicable box, if any, and attach two(2) copies of any relevant information)

- (1) Location in relation to legal boundaries and external dimensions of new, relocated or altered buildings
- (2) New provisions to be made for vehicular access and on-site parking, ie. a new crossing
- (3) Provisions to be made in building over or adjacent to any road or public place, ie. hoardings, signs
- (4) New provisions to be made for disposing of stormwater and wastewater
- (5) Precautions to be taken where building work is to take place over existing drains or sewers or in close proximity to wells or watermains
- (6) New connections to public utilities, ie. new drainage or water connections
- (7) Provisions to be made for any demolition work ie. the protection of the public, suppression of dust, disposal of debris, disconnection from public utilities and suppression of noise
- (8) Any cultural heritage significance of the building or building site, including whether it is on a marae

Project Documents (provided with this application)

- Plans and specifications
- (22) Producer Statements (ie. truss design, design review) - specify:
- (23) Other Documents - specify:

Inspections

- (26) By Wanganui District Council
- (27) Other - specify (ie. Design Engineer):

For office use only							
Unit	Checks				Inspections No.	Approved	
	Initials	Date	Initials	Date		Initials	Date
Administration	LC	22-10					
Planning							
Fire Design							
Building	CF	24-10					
Drainage							
Water							
Structural							
Plumbing/Drainage							
Roading							
Health							
Dangerous Goods							

Approved for issue of PIM/Building Consent

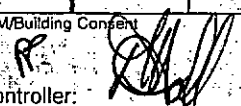
District Building Controller: 

Date: 25 OCT, 2002

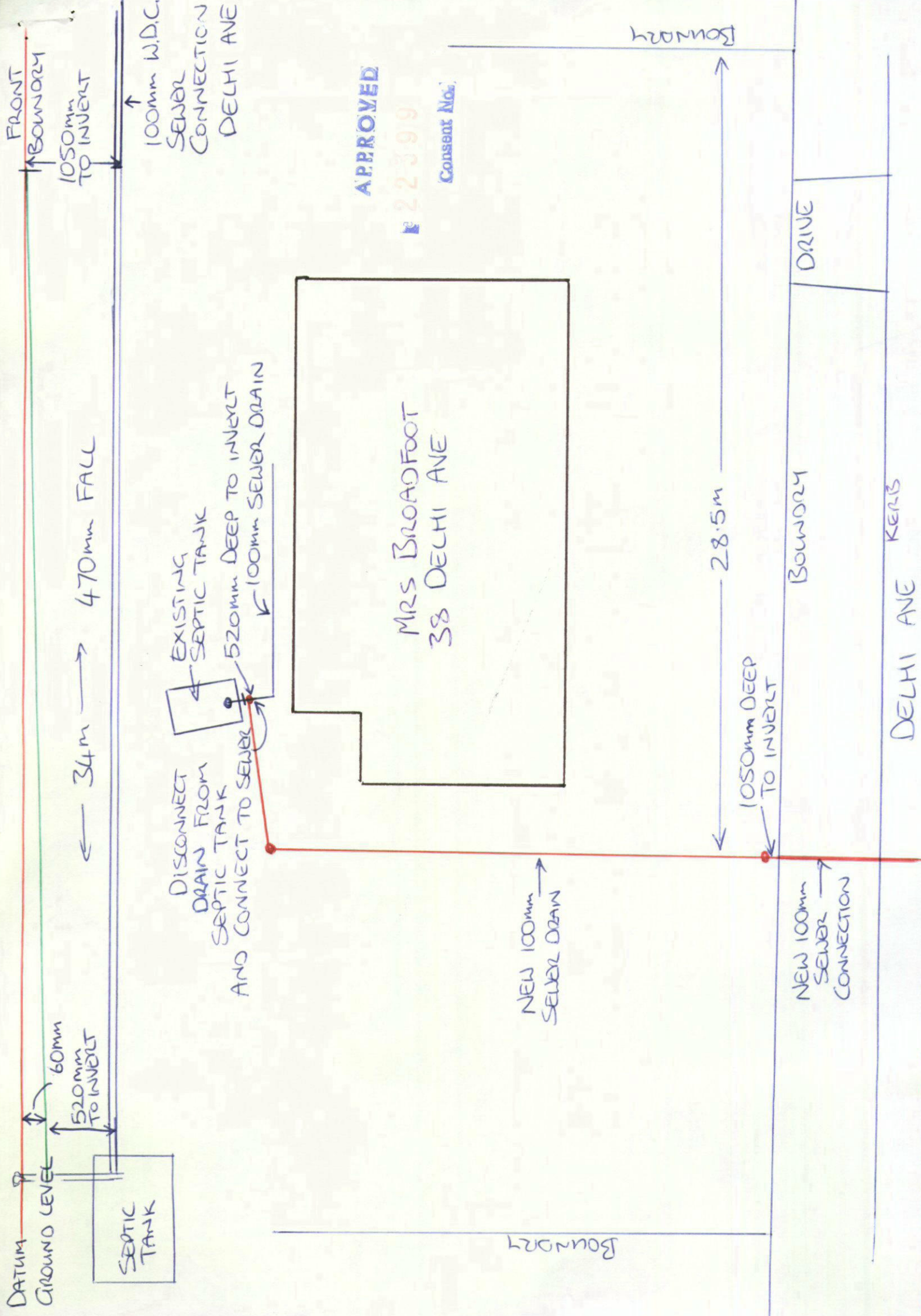

DATUM
GROUND LEVEL

60mm
520mm
TO INVERT

FRONT
BOUNDARY
1050mm
TO INVERT

100mm W.D.C.
SEWER
CONNECTION
DELHI AVE

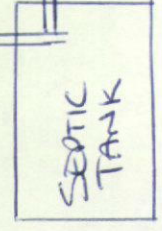

DISCONNECT
DRAIN FROM
SEPTIC TANK
AND CONNECT TO SEWER

EXISTING
SEPTIC TANK

520mm DEEP TO INVERT
100mm SEWER DRAIN

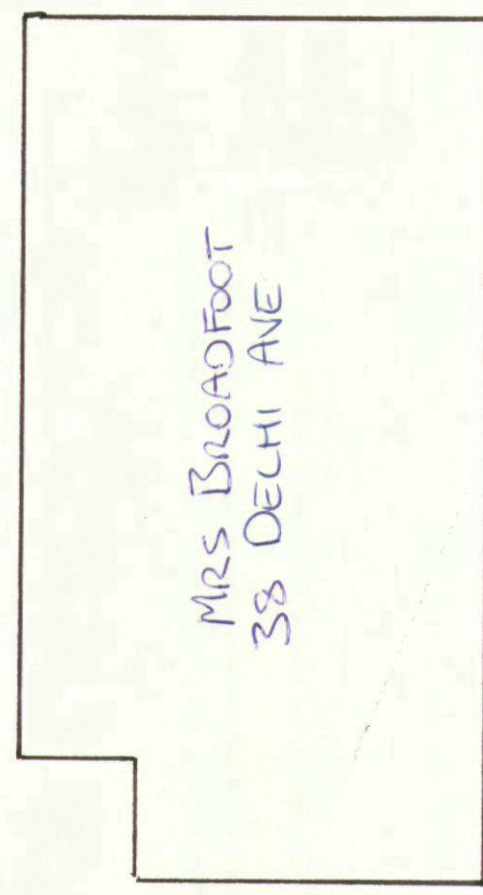

APPROVED
22399
Consent No.

BOUNDARY

NEW 100mm
SEWER DRAIN

28.5m

1050mm DEEP
TO INVERT

BOUNDARY
DRIVE

NEW 100mm
SEWER
CONNECTION

DELHI AVE
KERB

FENCE

4.6m

6.5m

6.4

26.2m

NEW 100 Ø PVC SEWER TO CONNECT
TO NEW S. SEWER MAIN IN STREET
LAID BY REX OSBORNE, INSPECTED BY
CHRIS GOULD 16.4.03

H2 DELHI AVE
BC# 2/22399

INTERF 1050mm

EXISTING PIPE FROM HOUSE TO
SEPTIC TANK 100 Ø PVC





CODE COMPLIANCE CERTIFICATE NUMBER BC02/22399

Section 43(3), Building Act 1991

Mrs ML Broadfoot
38 Delhi Ave
WANGANUI 5001

**Building Consent
No:** BC02/22399

Issue Date: 23/04/2003

Project Location	Assessment Number/Legal Description
42 Delhi Ave WANGANUI 5001	LOT 1 DP 52142 1.6591 Ha
Type of Work	Description of Work
SingDetRes	Disconnect septic tank and connect drain to sewer
Intended Life	Estimated Value
50 years	\$1500.00

This is a final Code Compliance Certificate issued in respect of all of the building work under the above Building Consent.

Signed for and on behalf of the Wanganui District Council:

A J Jamieson
**Team Leader Building Services
Environmental Services Business Unit**

Date: 23 April 2003