

TO THE WAITOTARA COUNTY COUNCIL

Date 26<sup>th</sup> Nov 1984

**APPLICATION FOR BUILDING PERMIT AND/OR PLUMBING & DRAINAGE PERMIT**

I hereby apply for permission to ERECT 'SKYLINE' GARAGE  
 the proposed use of same being FOR STORAGE PURPOSES.  
 at DELHI AVENUE PARMONO. according to the detailed plans and specifications showing elevations, cross sections, siting and drainage proposals of the same deposited herewith (2 copies of each to be attached hereto).

Owner W & L. JONES  
 Address 33A BIGNELL ST.  
 Phone No. 444 701  
 Area of site \_\_\_\_\_ m<sup>2</sup>/ha  
 Floor area of proposed work 35 m<sup>2</sup>  
 Builder OWNERS  
 Address \_\_\_\_\_  
 Phone No. \_\_\_\_\_

Val. Asst. No. 12880 / 377 / 1  
 Legal description P7 LOT 1  
DP. 52142  
 or Scheme Plan No. \_\_\_\_\_  
 Area shown on Val. Asst. 9548 m<sup>2</sup>/ha  
 Regd. Plumber or Drainlayer N/A  
 Address \_\_\_\_\_  
 Phone No. \_\_\_\_\_



**Estimated Value of Work When Completed -**

Building	\$ 1500.00
Plumbing & Drainage	\$
<b>Total Value</b>	<b>\$ 1500.00</b>

**CERTIFICATE:** I hereby certify that the above information is correct and do agree to abide by the Waitotara County Council Code of Ordinances, By-Laws and Plumbing & Drainage Regulations regarding the erection and maintenance of buildings situated thereon and to pay all fees. I understand no work is to be commenced before the requisite permit is issued.

[Signature]  
 Owner/Building/Plumber

**GENERAL INFORMATION:**

**PLANS, ETC. TO ACCOMPANY THIS APPLICATION:- (All in duplicate)**

Every application must be accompanied by a floor plan and elevations of the building to a scale of 1:100 or 1:50, and two copies of the locality plan to a scale of 1:100 showing the building in relation to adjacent buildings, if any, road and section boundaries, and the directional aspect in relation to North point. Plans must be "accurately clearly and indelibly executed to scale and shall be drawn in ink upon drawing paper or tracing cloth or printed upon cloth of approved paper" and should be not smaller than 300mm x 200mm (A4). Specifications should be sufficiently comprehensive to clearly indicate the methods and materials of construction and, together with the plans, should comprise working documents adequate for a builder to work to, and all must comply with the requirements of clause 2.5 of N.Z.S.S. 1900. Positively no permit will be issued unless all information required by this application is provided and the necessary plans and specifications supplied.

N.B. ALL FEES are payable when the application is lodged.

**FOR OFFICE USE ONLY**

Building Inspector: Approved [Signature]

Permit No. B107746 30/11/84

Health Inspector: Approved \_\_\_\_\_

Permit No. \_\_\_\_\_

Certificate of Occupancy issued \_\_\_\_\_ by \_\_\_\_\_

Town Planning Approval Rimal & Delhi Ave

Zoning \_\_\_\_\_

Siting \_\_\_\_\_

Parking \_\_\_\_\_

Other \_\_\_\_\_

Subject to: \_\_\_\_\_

Fees	Amount	Rec. No.
Building Inspection	20.00	
Plumbing & Drainage		
Research Levy		
Water Supply ref.		
Sewerage ref.		
Kerb/Crossing ref.		

[Signature]  
 County Clerk  
 County Engineer  
 26/11/84

Total \$ 20.00 1367F  
 Actioned by [Signature] 26/11/84

Wanganui City

SETON CONCRETE  
FOUNDATION 300x150.  
1/12 R.D.

Proposed Skyline

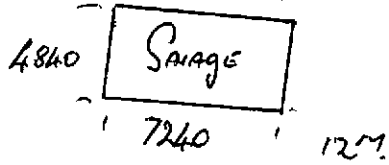

Proposed House

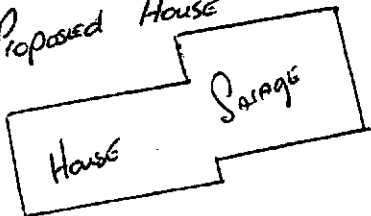

87.

38 DE/H. AVE

WAYNE @ Lynda JONES. PHONE 44701