

Land Information Memorandum



Property address:
10 Rowanwood Close

LIM number: H09471451

Page 1

Christchurch City Council
53 Hereford Street, PO Box 73015
Christchurch 8154, New Zealand
Tel 64 3 941 8999
Fax 64 3 941 8984

www.ccc.govt.nz

Application details

Date issued 29 January 2026
Date received 20 January 2026

Property details

Property address 10 Rowanwood Close, Westlake, Christchurch
Valuation roll number 23441 10000
Valuation information Capital Value: \$790,000
Land Value: \$470,000
Improvements Value: \$320,000
Please note: these values are intended for Rating purposes
Legal description Lot 223 DP 49563
Existing owner

Council references

Rate account ID 73063273
LIM number H09471451
Property ID 1025404

Document information

This Land Information Memorandum (LIM) has been prepared for the purpose of section 44A of the Local Government Official Information and Meetings Act 1987 (LGOIMA). It is a summary of the information that we hold on the property. Each heading or "clause" in this LIM corresponds to a part of section 44A.

Sections 1 to 10 contain all of the information known to the Christchurch City Council that must be included under section 44A(2) LGOIMA. Any other information concerning the land as the Council considers, at its discretion, to be relevant is included at section 11 of this LIM (section 44A(3) LGOIMA). If there are no comments or information provided in these sections this means that the Council does not hold information on the property that corresponds to that part of section 44A.

The information included in this LIM is based on a search of Council records only and there may be other information relating to the land which is unknown to the Council. Please note that other agencies may also hold information relevant to the property, or administer legislation relevant to the use of the land, for example, the Regional Council (Ecan), Heritage New Zealand Pouhere Taonga, and Land Information New Zealand.

Council records may not show illegal or unauthorised building or works on the property. The applicant is solely responsible for ensuring that the land is suitable for a particular purpose.

A LIM is only valid at the date of issue as information is based only upon information the Council held at the time of that LIM request being made. It is essential that the applicant undertakes their own due diligence to verify the suitability of the property for their intended use.

To enable the Council to measure the accuracy of this LIM document based on our current records, we would appreciate your response should you find any information contained therein which may be considered to be incorrect or omitted. Please telephone the Customer Call Centre on (03) 941 8999.

Property address:

10 Rowanwood Close

LIM number: H09471451

Page 3

Christchurch City Council

53 Hereford Street, PO Box 73015
Christchurch 8154, New Zealand
Tel 64 3 941 8999
Fax 64 3 941 8984

www.ccc.govt.nz

A search of records held by the Council has revealed the following information:

1. Special features and characteristics of the land

Section 44(A)(2)(aa) LGOIMA. This is information known to the Council but is not apparent from a district plan under the Resource Management Act 1991. It identifies each (if any) special feature or characteristic of the land concerned, including but not limited to the likely presence of hazardous contaminants.

☎ For enquiries, please phone (03) 941 8999 or visit www.ccc.govt.nz.

Natural Hazards

Section 44A(2)(a) LGOIMA. This is information known to the Council about natural hazards that is required by section 44B LGOIMA.

Council's information has primarily been obtained from external specialists with the technical expertise to carry out research, investigation or analysis. Under the Local Government (Natural Hazard Information in Land Information Memoranda) Regulations 2025, the Council isn't required to:

- prepare a risk assessment of the land concerned.
- undertake any further analysis relating to the land.
- conduct additional searches or inquiries about the existence of natural hazard information.

It is the LIM recipient's responsibility to seek qualified advice about any identified natural hazard and/or the suitability of the land for its intended purpose.

This section may also include natural hazard information provided by Environment Canterbury. Christchurch City Council is required to include such information in LIMs where Environment Canterbury considers it meets the criteria under section 44C of LGOIMA.

The following statement has been provided by Environment Canterbury:

This Land Information Memorandum includes natural hazard information deemed by Environment Canterbury to be the most up to date, useful, and relevant, and is provided in accordance with the Local Government (Natural Hazard Information in Land Information Memoranda) Regulations 2025. All due care has been taken to ensure current information required to be provided under the regulations is presented below.

Environment Canterbury may hold superseded or less reliable natural hazards information relating to the land that has not been included in this Land Information Memorandum. Please contact Environment Canterbury if you would like to enquire about this information.

(a) Coastal Hazards

As at the date of this LIM, Council research found no information under this heading.

(b) Earthquakes

• Liquefaction Assessment

Christchurch City Council holds indicative information on liquefaction hazard for Christchurch. Information on liquefaction, including an interactive web tool, can be found on the Council website at ccc.govt.nz/liquefaction. Depending on the liquefaction potential of the area that the property is in, the Council may require site-specific investigations before granting future subdivision or building consent for the property.

Property address:

10 Rowanwood Close

LIM number: H09471451

Page 4

Christchurch City Council

53 Hereford Street, PO Box 73015
Christchurch 8154, New Zealand
Tel 64 3 941 8999
Fax 64 3 941 8984

www.ccc.govt.nz

- Regional Liquefaction Information

Areas where there was evidence of liquefaction were mapped following the 2010/11 Canterbury earthquakes by Tonkin & Taylor for the Earthquake Commission (urban areas) and by a group of researchers for Environment Canterbury (rural, commercial and industrial areas). These are available in the Christchurch Liquefaction Viewer at <https://apps.canterburymaps.govt.nz/ChristchurchLiquefactionViewer/>.

Technical report information:

Title: Review of liquefaction hazard information in eastern Canterbury, including Christchurch City and parts of Selwyn, Waimakariri and Hurunui Districts.

Date: December 2012.

Author: H Brackley (compiler).

Commissioned by: Environment Canterbury.

Purpose of report: To collate liquefaction occurrence during the 2010/11 Canterbury earthquakes, and to determine liquefaction vulnerability. For use in land use planning, subdivision and building consenting.

Study area: Coastal Canterbury from the Waipara River mouth to the Rakaia River mouth, including Banks Peninsula, and inland to Rangiora, Aylesbury, Selwyn and Southbridge.

Accessible at: <https://www.ecan.govt.nz/document/download?uri=1702192>.

- Regional Hazard Information: Earthquake fault deformation

There are no known earthquake faults at the ground surface in Christchurch. However, it is possible there are some faults in Christchurch that are yet to be identified because they are not visible at the ground surface.

More information on fault deformation is available on Environment Canterbury's fault deformation map at <https://mapviewer.canterburymaps.govt.nz/?webmap=b5f859bd18ee4912828cb092bef6c449>.

(c) Flooding

- Regional Hazard Information: Flood Photographs

Photographs showing the property during or following past flood events may be available. Flood photographs are available on Environment Canterbury's flood imagery register at <https://apps.canterburymaps.govt.nz/FIR>.

- Regional Hazard Information: Flood Assessment Request

You can request a new site-specific flood hazard assessment for the property from Environment Canterbury at: <https://www.ecan.govt.nz/do-it-online/property-information/flood-hazard-assessments>.

(d) Landslides

As at the date of this LIM, Council research found no information under this heading.

(e) Subsidence

- Consultant Report Available

Land Information New Zealand (LINZ) engaged Tonkin and Taylor to provide a Geotechnical Report on Ground Movements that occurred as a result of the Canterbury Earthquake Sequence. The report indicates this property may have been effected by a degree of earthquake induced subsidence. The report obtained by LINZ can be accessed on their website at <https://www.linz.govt.nz> and search Information for Canterbury Surveyors.

(f) Tsunamis

As at the date of this LIM, Council research found no information under this heading.

(g) Volcanic and Geothermal Hazards

As at the date of this LIM, Council research found no information under this heading.

(h) Wind

As at the date of this LIM, Council research found no information under this heading.

(i) Any Other Natural Hazards

As at the date of this LIM, Council research found no information under this heading.

(j) District Plan Natural Hazard Information

Please refer to *Section 8. Land use and conditions* of this report for District Plan related natural hazard information.

Property address:

10 Rowanwood Close

LIM number: H09471451

Page 5

Christchurch City Council

53 Hereford Street, PO Box 73015
Christchurch 8154, New Zealand
Tel 64 3 941 8999
Fax 64 3 941 8984

www.ccc.govt.nz

(k) Building Notices

Please refer to *Section 5. Consents, certificates, notices, orders, or requisitions affecting the land and buildings* of this report for Building Act notice information.

Other Special Features or Characteristics of the Land

As at the date of this LIM, Council research found no information under this heading.

Property address:

10 Rowanwood Close

LIM number: H09471451

Page 6

Christchurch City Council

53 Hereford Street, PO Box 73015
Christchurch 8154, New Zealand
Tel 64 3 941 8999
Fax 64 3 941 8984

www.ccc.govt.nz

2. Private and public stormwater and sewerage drains

Section 44A(2)(b) LGOIMA. This is information about private and public stormwater and sewerage drains as shown in the Council's records.

 For stormwater and sewerage enquiries, please phone (03) 941 8999 or visit www.ccc.govt.nz.

Related Information

- Attached are all drainage plans that Council hold for details of private and public drainage. Not all plans provided are verified by Council, and therefore Council cannot be liable for inaccuracies. Site investigation will be required by owners to determine exact layouts.
- This property is shown to be served by Christchurch City Council Sewer and Stormwater.

Property address:

10 Rowanwood Close

LIM number: H09471451

Page 7

Christchurch City Council

53 Hereford Street, PO Box 73015
Christchurch 8154, New Zealand
Tel 64 3 941 8999
Fax 64 3 941 8984

www.ccc.govt.nz

3. Drinking Water Supply

Section 44A(2)(ba) and (bb) LGOIMA. This is information notified to the Council about whether the land is supplied with drinking water, whether the supplier is the owner of the land or a networked supplier, any conditions that are applicable, and any information the Council has about the supply.

Please note the council does not guarantee a particular water quality to its customers. If you require information on current water quality at this property please contact the Three Waters & Waste Unit.

☎ For water supply queries, please phone (03) 941 8999 or visit www.ccc.govt.nz.

Water supply

Christchurch City Council is the networked supplier of water to this property. This property is connected to the Christchurch City Council Water Supply. The conditions of supply are set out in the Christchurch City Council Water Supply and Wastewater Bylaw (2022), refer to www.ccc.govt.nz.

Property address:

10 Rowanwood Close

LIM number: H09471451

Page 8

Christchurch City Council

53 Hereford Street, PO Box 73015
Christchurch 8154, New Zealand
Tel 64 3 941 8999
Fax 64 3 941 8984

www.ccc.govt.nz

4. Rates

Section 44A(2)(c) LGOIMA. This is information on any rates owing in relation to the land.

☎ For rates enquiries, please phone (03) 941 8999 or visit www.ccc.govt.nz.

(a) Annual rates

Annual rates to 30/06/2026: \$4,750.45

	Instalment Amount	Date Due
Instalment 1	\$1,187.55	31/08/2025
Instalment 2	\$1,187.55	30/11/2025
Instalment 3	\$1,187.55	28/02/2026
Instalment 4	\$1,187.80	31/05/2026

Rates owing as at 29/01/2026: \$667.15

(b) Excess Water Rates

For excess water charge enquiries, please phone (03) 941 8999 or visit www.ccc.govt.nz/contact-us.

(c) Final water meter reading required at settlement?

Property settlements must ensure all water usage and outstanding debts are accurately accounted for.

To advise of a property settlement, please complete the request for settlement information form at www.ccc.govt.nz/services/rates-and-valuations/solicitors-request.

A settlement statement of accounts will be provided on the expected settlement date advised.

Property address:

10 Rowanwood Close

LIM number: H09471451

Page 9

Christchurch City Council

53 Hereford Street, PO Box 73015
Christchurch 8154, New Zealand
Tel 64 3 941 8999
Fax 64 3 941 8984

www.ccc.govt.nz

5. Consents, certificates, notices, orders, or requisitions affecting the land and buildings

Section 44A(2)(d) LGOIMA. This is information concerning any consent, certificate, notice, order, or requisition, affecting the land or any building on the land, previously issued by the Council. The information in this section may also cover building consent and/or code compliance information issued by building certifiers under the Building Act 1991 and building consent authorities that are not the Council under the Building Act 2004.

You can check the property file to identify whether any consent or certificate was issued by a building certifier under the Building Act 1991.

Section 44A(2)(da) LGOIMA. The information required to be provided to a territorial authority under section 362T(2) of the Building Act 2004. There is currently no information required to be provided by a building contractor to a territorial authority under section 362T(2) of the Building Act 2004. The Building (Residential Consumer Rights and Remedies) Regulations 2014 only prescribed the information that must be given to the clients of a building contractor.

Sections 71 to 74 of the Building Act 2004 require the Building Consent Authority to consider natural hazards when it receives a building consent application for the construction or major alteration of a building on land that is subject to, or likely to be subject to, a natural hazard. A building consent for this property may have been issued subject to a section 72 or 73 notice. This means at the time of building consent the Building Consent Authority was not satisfied that adequate provision would be made to protect the building and land from the natural hazard and was subsequently required to notify the Registrar-General of Land to record the natural hazard on the Record of Title. The Building Act 2004 defines natural hazards as erosion (including coastal erosion, bank erosion, and sheet erosion), falling debris (including soil, rock, snow, and ice), subsidence, inundation (including flooding, overland flow, storm surge, tidal effects, and ponding), and slippage.

If your property contains a notice under s73 of the Building Act 2004, this will be identified on the building consent decision below (decision under s72 of the Building Act 2004) and on the properties' Record of Title. The Record of Title may also record this as a s36 notice under the Building Act 1991, or a s641A notice under the Local Government Act 1974.

 For building enquiries, please phone (03) 941 8999, email EPADutyBCO@ccc.govt.nz or visit www.ccc.govt.nz.

(a) Consents

- BCN/1986/1521 Applied: 25/03/1986 Status: Completed
10 Rowanwood Close Westlake
Permit granted 11/04/1986
Permit issued 11/04/1986
DWELLING- Historical Reference PER86032331
- BCN/1987/2410 Applied: 24/04/1987 Status: Completed
10 Rowanwood Close Westlake
Permit granted 01/05/1987
Permit issued 01/05/1987
GARAGE- Historical Reference PER87033677

(b) Certificates

Note: Code Compliance Certificates were only issued by the Christchurch City Council since January 1993.

(c) Notices

(d) Orders

(e) Requisitions

Property address:

10 Rowanwood Close

LIM number: H09471451

Page 10

Christchurch City Council

53 Hereford Street, PO Box 73015
Christchurch 8154, New Zealand
Tel 64 3 941 8999
Fax 64 3 941 8984

www.ccc.govt.nz

Property address:

10 Rowanwood Close

LIM number: H09471451

Page 11

Christchurch City Council

53 Hereford Street, PO Box 73015
Christchurch 8154, New Zealand
Tel 64 3 941 8999
Fax 64 3 941 8984

www.ccc.govt.nz

6. Certificates issued by a building certifier

Section 44A(2)(e) LGOIMA. This is information notified to the Council concerning any certificate issued by a building certifier pursuant to the Building Act 1991 or the Building Act 2004.

 For building enquiries, please phone (03) 941 8999, email EPADutyBCO@ccc.govt.nz or visit www.ccc.govt.nz.

Property address:

10 Rowanwood Close

LIM number: H09471451

Page 12

Christchurch City Council

53 Hereford Street, PO Box 73015
Christchurch 8154, New Zealand
Tel 64 3 941 8999
Fax 64 3 941 8984

www.ccc.govt.nz

7. Weathertightness

Section 44A(2)(ea) LGOIMA. This is information notified to the Council under section 124 of the Weathertight Homes Resolution Services Act 2006.

 For weathertight homes enquiries, please phone (03) 941 8999 or visit www.ccc.govt.nz.

If there is no information below this means Council is unaware of any formal Weathertight Homes Resolution Services claim lodged against this property.

Property address:

10 Rowanwood Close

LIM number: H09471451

Page 13

Christchurch City Council

53 Hereford Street, PO Box 73015
Christchurch 8154, New Zealand
Tel 64 3 941 8999
Fax 64 3 941 8984

www.ccc.govt.nz

8. Land use and conditions

Section 44A(2)(f) LGOIMA. This is information relating to the use to which the land may be put and conditions attached to that use. The planning information provided below is not exhaustive and reference to the Christchurch District Plan and any notified proposed changes to that plan is recommended: <https://ccc.govt.nz/the-council/plans-strategies-policies-and-bylaws/plans/christchurch-district-plan/>.

There may be some provisions of the Christchurch City Plan or Banks Peninsula District Plan that affect this property that are still operative.

☎ For planning queries, please phone (03) 941 8999, email DutyPlanner@ccc.govt.nz or visit www.ccc.govt.nz.

- **Regional plan or bylaw**

There may be objectives, policies or rules in a regional plan or a regional bylaw that regulate land use and activities on this site. Please direct enquiries to Canterbury Regional Council (Environment Canterbury).

(a)(i) Christchurch City Plan & Banks Peninsula District Plan

(ii) Christchurch District Plan

- **Liquefaction Management Area (LMA)**

Property or part of property within the Liquefaction Management Area (LMA) Overlay, which is operative.

- **District Plan Zone**

Property or part of property within the Residential Suburban Zone, which is operative.

(b) Resource consents

If there are any land use resource consents issued for this property the Council recommends that you check those resource consents on the property file. There may be conditions attached to those resource consents for the property that are still required to be complied with.

Property address:

10 Rowanwood Close

LIM number: H09471451

Page 14

Christchurch City Council

53 Hereford Street, PO Box 73015
Christchurch 8154, New Zealand
Tel 64 3 941 8999
Fax 64 3 941 8984

www.ccc.govt.nz

9. Other land and building classifications

Section 44A(2)(g) LGOIMA. This is information notified to the Council by any statutory organisation having the power to classify land or buildings for any purpose.

 For land and building enquiries, please phone (03) 941 8999 or visit www.ccc.govt.nz.

Please refer to Section 1 for details

Property address:

10 Rowanwood Close

LIM number: H09471451

Page 15

Christchurch City Council

53 Hereford Street, PO Box 73015
Christchurch 8154, New Zealand
Tel 64 3 941 8999
Fax 64 3 941 8984

www.ccc.govt.nz

10. Network utility information

Section 44A(2)(h) LGOIMA. This is information notified to the Council by any network utility operator pursuant to the Building Act 1991 or the Building Act 2004.

 For network enquiries, please phone (03) 941 8999 or visit www.ccc.govt.nz.

- **None recorded for this property**

Property address:

10 Rowanwood Close

LIM number: H09471451

Page 16

Christchurch City Council

53 Hereford Street, PO Box 73015
Christchurch 8154, New Zealand
Tel 64 3 941 8999
Fax 64 3 941 8984

www.ccc.govt.nz

11. Other information

Section 44A(3) LGOIMA. This is information concerning the land that the Council has the discretion to include if it considers it to be relevant.

☎ For any enquiries, please phone (03) 941 8999 or visit www.ccc.govt.nz.

(a) Kerbside waste collection

- Your organics are collected Weekly on Thursday. Please leave your organics at the Kerbside by 6:00 a.m.
- Your recycling is collected Fortnightly on the Week 1 collection cycle on a Thursday. Please leave your recycling at the Kerbside by 6:00 a.m. Your nearest recycling depot is the Parkhouse Road EcoDrop.
- Your refuse is collected Fortnightly on the Week 1 collection cycle on a Thursday. Please leave your rubbish at the Kerbside by 6:00 a.m. Your nearest rubbish depot is the Parkhouse Road EcoDrop.

(b) Other

• Floor Levels Information

Council holds a variety of information on requirements for building or property development. This includes:

- required minimum finished floor levels, which need to be set to meet the surface water requirements in clause E1.3.2 of the Building Code (where this applies); and
- the requirements of the Christchurch District Plan (where a property is in the Flood Management Area).

Where this information has been processed for your property, you can view it online at <https://ccc.govt.nz/flooding-and-floor-levels>.

Otherwise, if you are building or developing on this land, you can request a calculation on required finished floor levels for your proposed building by emailing us at floorlevels@ccc.govt.nz.

• Guest Accommodation

Guest accommodation (including whole unit listings on Airbnb; BookaBach; etc.) generally requires a resource consent in this zone when the owner is not residing on the site. For more information, please refer to: <https://ccc.govt.nz/providing-guest-accommodation/>.

• Community Board

Property located in Halswell-Hornby-Riccarton Community Board.

• Tsunami Evacuation Zone

This property is not in a tsunami evacuation zone. It is not necessary to evacuate in a long or strong earthquake or during an official Civil Defence tsunami warning. Residents may wish to offer to open their home to family or friends who need to evacuate from a tsunami zone, and should plan with potential guests to do so in advance. More information can be found at <https://ccc.govt.nz/services/civil-defence/hazards/tsunami-evacuation-zones-and-routes/>

• Electoral Ward

Property located in Halswell Electoral Ward

• Listed Land Use Register

Hazardous activities and industries involve the use, storage or disposal of hazardous substances. These substances can sometimes contaminate the soil. Environment Canterbury identifies land that is used or has been used for hazardous activities and industries. This information is held on a publically available database called the Listed Land Use Register (LLUR). The Christchurch City Council may not hold information that is held on the LLUR. Therefore, it is recommended that you check Environment Canterbury's online database at www.llur.ecan.govt.nz

Property address:

10 Rowanwood Close

LIM number: H09471451

Page 17

Christchurch City Council

53 Hereford Street, PO Box 73015
Christchurch 8154, New Zealand
Tel 64 3 941 8999
Fax 64 3 941 8984

www.ccc.govt.nz

- **Spatial Query Report**

A copy of the spatial query report is attached at the end of this LIM. The spatial query report lists land use resource consents that have been granted within 100 metres of this property.

Property address:

10 Rowanwood Close

LIM number: H09471451

Page 18

Christchurch City Council

53 Hereford Street, PO Box 73015
Christchurch 8154, New Zealand
Tel 64 3 941 8999
Fax 64 3 941 8984

www.ccc.govt.nz

DO NOT SCALE

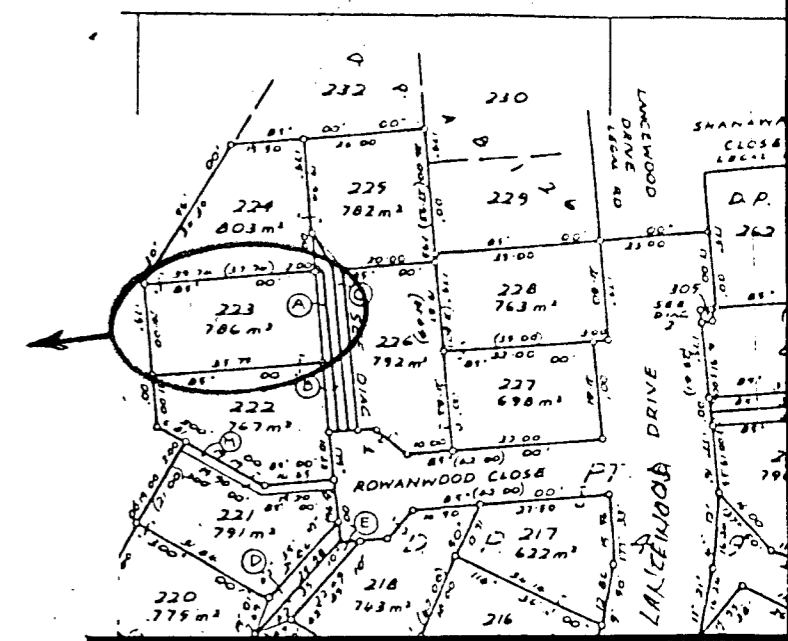
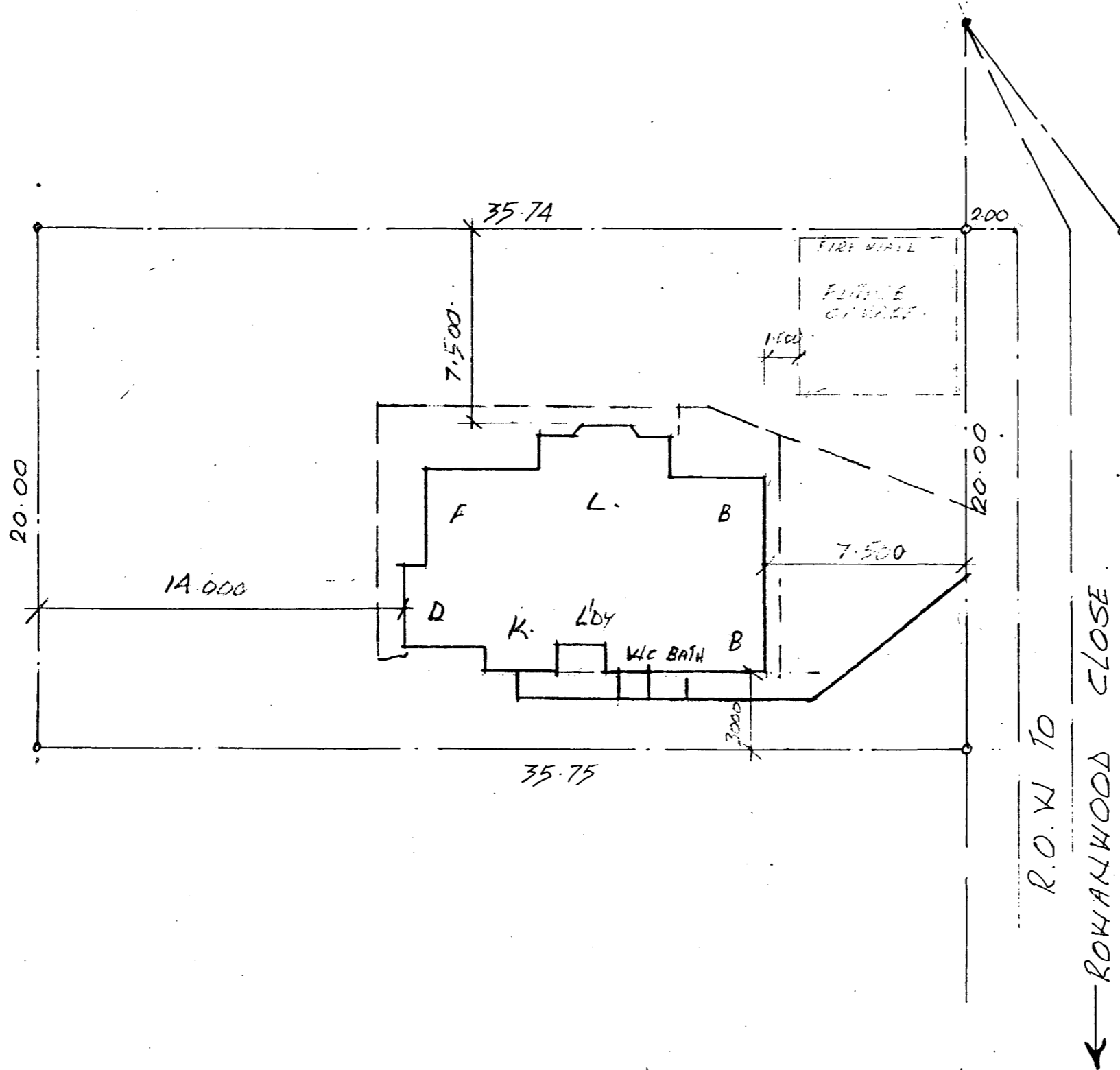
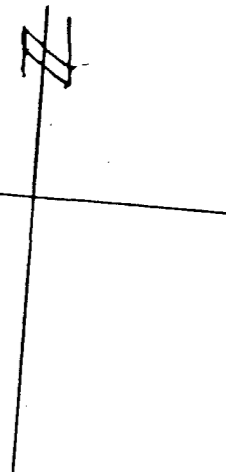

NOTE TO PURCHASER:
 AS MERRITT HOMES WAS NOT THE VENDOR OF THIS SECTION ANY EXTRA FOUNDATIONS OR REPEGGING COSTS ARE THE RESPONSIBILITY OF THE PURCHASER.

..... 198
 Client's Signature Date

DRAINAGE IS ONLY A PROVISIONAL SUM
 ESTIMATED MEASUREMENTS. STORMWATER AND SEWER
 DETAILS ARE APPROXIMATE ONLY.
 THE LAND MAY HAVE TO BE DE-WATERED.
 SEWER CONNECTION MAY BE VERY DEEP OR SHALLOW
 THE DRAINLAYER SHALL DETERMINE THE FINAL POSITION OF
 DRAINAGE PIPES

----- m SEWER 31 m.
 ----- m STORMWATER 60 m.
 - - - - - HIGH PRESSURE WATER
 ■ POWER SUPPLY

..... 198
 Client's Signature Date

FINAL SITE PLAN AS OF 12-3-86.

merritt homes ltd
 134 Victoria Street Christchurch 1

DESIGN: <i>NEW BRIDGE</i>	PROPOSED RESIDENCE FOR: MR. & MRS. W. HARDIE	SCALE: 1:200	CHECKED:
AGENT: <i>ALLEN MILLER</i>	SITE: LOT 223. ROWANWOOD CLOSE. WESTLAKE.		
DRAWN BY: <i>I. D' COSTA</i>			

AMENDMENTS: DATE: **2834**
 DATE: **31ST JAN. 86.**

10 Rowanwood Close Land Use Consents

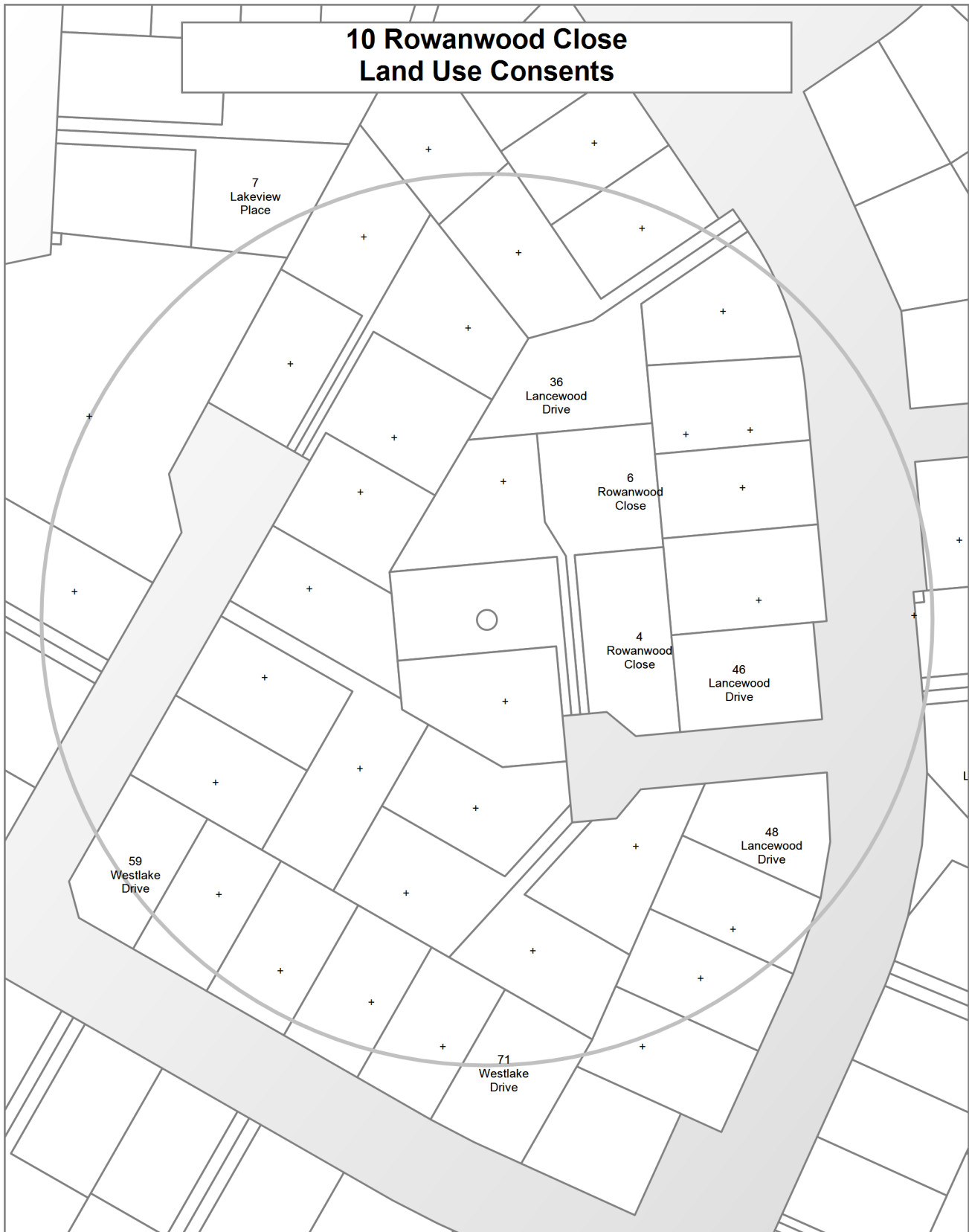

**10 Rowanwood Close
Subdivision Consents**



Land Use Resource Consents within 100 metres of 10 Rowanwood Close

Note: This list does not include subdivision Consents and Certificates of Compliance issued under the Resource Management Act.

36 Lancewood Drive

RMA/2008/1390

Retrospective consent for an existing sleepout - Historical Reference RMA92012245

Processing complete

Applied 30/06/2008

Decision issued 16/07/2008

Granted 14/07/2008

4 Rowanwood Close

RMA/2006/1990

Application for alterations to the kitchen of the existing dwelling - Historical Reference RMA92006066

Processing complete

Applied 23/08/2006

Decision issued 13/09/2006

Granted 12/09/2006

46 Lancewood Drive

RMA/2006/1972

Application to erect an addition to the existing garage which will intrude into the street scene setback - Historical Reference RMA92006048

Processing complete

Applied 22/08/2006

Decision issued 09/11/2006

Granted 09/11/2006

48 Lancewood Drive

RMA/2001/1458

Application for a dwelling extension the 4.5m setback from the road boundary and length of building exceeds 20m - Historical Reference RMA20005341

Processing complete

Applied 18/06/2001

Decision issued 29/06/2001

Granted 29/06/2001

53 Lancewood Drive

RMA/1987/409

Exceed recession plane on dwelling - Historical Reference RES9208812

Processing complete

Applied 16/10/1987

Decision issued 28/10/1987

Granted 28/10/1987

59 Lancewood Drive

RMA/1986/466

Reduce rear yard requirement to 3m between lots 265 and 266 - Historical Reference RES9208814

Processing complete

Applied 15/07/1986

Decision issued 17/07/1986

Granted 17/07/1986

RMA/1998/2189

Application for a dwelling extension which intrudes into the front 4.5m setback from the road boundary. - Historical Reference RES982504

Processing complete

Applied 14/09/1998

Decision issued 16/09/1998

Granted 16/09/1998

59 Westlake Drive

RMA/1993/531

Consent to erect a garage forward of the dwelling in excess of 40m², being 49m² and exceed the maximum site coverage of 35%, being 38.6% - Historical Reference RES9218739

Processing complete

Applied 27/09/1993

Decision issued 06/10/1993

Granted 06/10/1993

6 Rowanwood Close

RMA/1986/1020

Consent to site proposed garage 2m from the right of way - Historical Reference RES9221353

Processing complete

Applied 19/09/1986

Decision issued 21/10/1986

Granted 21/10/1986

7 Lakeview Place

RMA/1989/379

Intrusion of the north east corner of the proposed home into the 6m side yard - Historical Reference RES9208795

Processing complete

Applied 14/09/1989

Decision issued 19/09/1989

Granted 19/09/1989

71 Westlake Drive

RMA/1986/874

Consent to a reduction of the rear yard boundary from 6 metres to 5 metres. decision recommended only - Historical Reference RES9216595

Processing complete

Applied 21/05/1986

Decision issued 01/01/1999

Granted 01/01/1999

Data Quality Statement

Land Use Consents

All resource consents are shown for sites that have been labelled with an address. For sites that have been labelled with a cross (+) no resource consents have been found. Sites that have no label have not been checked for resource consents. This will be particularly noticeable on the margins of the search radius. If there are such sites and you would like them included in the check, please ask for the LIM spatial query to be rerun accordingly. This will be done free of charge although there may be a short delay. Resource consents which are on land occupied by roads, railways or rivers are not, and currently cannot be displayed, either on the map or in the list. Resource consents that relate to land that has since been subdivided, will be shown in the list, but not on the map. They will be under the address of the land as it was at the time the resource consent was applied for. Resource consents that are listed as Non-notified and are current, may in fact be notified resource consents that have not yet been through the notification process. If in doubt. Please phone (03)941 8999.

The term "resource consents" in this context means land use consents. Subdivision consents and certificates of compliance are excluded.

Subdivision Consents

All subdivision consents are shown for the sites that have been labelled with consent details. For Sites that have been labelled with a cross (+) no records have been found. Sites that have no label have not been checked for subdivision consents. This will be particularly noticeable on the margins of the search radius. If there are such sites and you would like them included in the check, please ask for the LIM spatial query to be rerun accordingly. This will be done free of charge although there may be a short delay.

The term "subdivision consents" in this context means a resource consent application to subdivide land. Non subdivision land use resource consents and certificates of compliance are excluded.

This report will only record those subdivision applications which have not been completed i.e once a subdivision has been given effect to and the new lots/properties have been established the application which created those lots will not be shown

All subdivision consent information is contained on the map and no separate list is supplied