

22 SHAKESPEARE RD

RD

Wanganui District Council

22 JUL 2009

ACCEPTED

Wanganui District Council
BCA QM System

Building Consent File – Front Cover

BCA T-33C page 1 of 1
v6 12/11/08

Building Consent File Content/Checklist

DBH Building Category

1

Consent number: B Com 09/0640

(Type 1, 2 or 3)

| | Description | Added to file | Comment & Reference |
|-----|---|------------------------|---------------------|
| 1. | Consent Application | 22-7-09 | |
| 2. | Pre-Vet Checksheet | 22-7-09 | |
| 3. | Plans & Specifications | 22-7-09 | |
| 4. | Bracing Calculations | | |
| 5. | PIM : C/T : Consent Notes | | |
| 6. | Regional Authority Consent (Dams) | | |
| 7. | Fire Design | | |
| 8. | DRU – NZFS | | |
| 9. | Consultant Reports | | |
| 10. | Producer Statements PS1, PS2, PS4 | | |
| 11. | Engineering Calculations | | |
| 12. | Peer Review | 2/7 23/7/09 | Approved |
| 13. | Relocate: Condition Reports | | |
| 14. | Truss Layouts | | |
| 15. | FIR | | |
| 16. | Correspondence | | |
| 17. | Copy of Invoice(s) | 22-7-09. | |
| 18. | Compliance Assessment Checksheets | | |
| 19. | Photos | | |
| 20. | Notice to Fix / Enforcement Action | | |
| 21. | DBH Notification (Warnings etc) | | |
| 22. | Amendments/Alterations to Existing | | |
| 23. | Historic Places Trust Approval letter | | |
| 24. | Request for Further Information letter(s) | | |
| 25. | | | |
| 26. | | | |
| 27. | Building Consent (signed copy) Including Conditions | | |
| 28. | | | |
| 29. | | | |
| 30. | Inspection Checksheets | 30.7.09 | D. HALL |
| 31. | Supporting As-Built documentation | 4.4.11 | |
| 32. | Energy Work Certificates - Electrical | | |
| 33. | Energy Work Certificates - Gas | | |
| 34. | Vehicle Crossing Producer Statement | | |
| 35. | | | |
| 36. | | | |
| 37. | | | |
| 38. | Application for C.C.C. | 4.4.11 | |
| 39. | C.C.C. Assessment Checklist | 15.6.11 | |
| 40. | Code Compliance Certificate | 15.6.2011 | |

**JOB COMPLETED
CCC ISSUED**

LARGE PLANS HELD IN: (PLAN TUBE or FILE BOX?)

LARGE PLANS LOCATED IN: G18 FILE ROOM or BASEMENT

SEWER CONNECTION.

Building Consent Application
Section 32 or 45, Building Act 2004

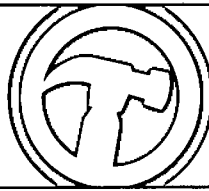

Wanganui District Council
21 JUL 2009

Wanganui District Council
RECEIVED

1. Application type

- Project Information Memorandum and/or
 Building Consent or
 Alteration to Existing Building Consent
(Please tick appropriate box)

Building Consent/PIM No.

BCan09/0640

Note: Shaded areas for office use only

Refer HDC CONTRACT 1361

2. The building

2a. Site Address

22 Shakespeare Road

2b. Current lawfully established use

House

2c. Legal Description

Lot

11

DP 1304

2d. Council Property No.

13558

2e. Number of levels

2f. Level/Unit number

2g. Floor area

Existing

m²

New

m²

Total

m²

2h. Year building first constructed

(If applicable/or approx. year)

3. The owner

3a. Name

Philip - Heather Kubiak

Postal Address

22 Shakespeare Rd, Bastia Hill
Wanganui

Contact Numbers

Phone

Mobile

Fax

Email

4. Evidence of ownership

4a. Evidence of ownership attached

Certificate of Title (copy)

Sale and purchase agreement

Lease agreement

Other document showing full name of legal owner(s), such as a rate instalment notice

5. Applicant's details (if not the owner)

5a. Name of Agent

Postal Address

Contact Numbers

Phone

Mobile

Fax

Email

Relationship to owner

Details of authority

Evidence attached

Other - please specify

Verbal

6. Applicant's declaration

N. Palmer 16/7/09
 Signature of Owner/Agent Date

Neville Palmer
 Name (print clearly)

- Consent fees to be paid by (Please tick appropriate box)
- Owner Builder Plumber
 Designer Agent

The information provided will be included in a Public Register of Consents which is available for public perusal under the Privacy Act 1993 section 54. This may result in receipt by the 'Owner' of trade advertising

7. The project

7a. Description of the building work

Connect house sewer drain to new council street connection
Disconnect septic Tank

7b. Will the building work result in a change of use of the building. Yes No

7c. If yes, please provide details of the new use

7d. Intended life of the building

Indefinite but not less than 50 years
 Less than 50 years - please specify _____ years

7e. Have any PIM and/or Building Consents been issued previously for this project?

Yes Provide details below
 No

| Date of consent | Consent number |
|-----------------|----------------|
| | |
| | |

7f. Estimated value of the building work \$ 2000.00 including gst

8. Project Information Memorandum

The following matters are involved in the project (please tick the appropriate project)

- Subdivision
- Alterations to land contours
- New or altered connections to public utilities
- New or altered locations and/or external dimensions of buildings
- New or altered access for vehicles
- Building work over, or adjacent to, any road or public place
- Disposal of stormwater and wastewater
- Building work over existing drains or sewers, or in close proximity to wells or water mains
- Other matters known to the applicant that may require authorisations from the council - please specify

9. Supporting documentation

The following plans and specifications are attached to this application:

- Two sets of plans drawn to a recognised metric scale; include two sets of specifications and other documentation
- Project Information Memorandum
- Producer Statements
- Truss Layout Plan
- Certificate attached to Project Information Memorandum
- Details/Calculations
- Fire Design Analysis
- Development Contribution Notice

Please turn over

9. Supporting documentation - continued

Copies of other Authorisations - please specify

Other - please specify

10. Building practitioners involved in this project (continue on another sheet of paper if needed)

Designer

Name / Registration no.

Contact details Address

Phone / Email

Builder

Name / Registration no.

Contact details Address

Phone / Email

Craftsman Plumber

Name / Registration no.

Contact details Address

Phone / Email

Registered Drainlayer

Name / Registration no. *Neville Palmer 12563*

Contact details Address

Phone / Email

Electrician

Name / Registration no.

Contact details Address

Phone / Email

Engineer

Name / Registration no.

Contact details Address

Phone / Email

Specialist Services (fire alarm, HVAC, lift etc)

Name / Registration no.

Contact details Address

Phone / Email

Other

Name / Registration no.

Contact details Address

Phone / Email

11. Waiver or modification required

Waiver or modification
(Please circle and detail below)

| | | | | | | | |
|-----|-----|----|----|-----|-----|-----|-----|
| B1 | B2 | C1 | C2 | C3 | C4 | D1 | D2 |
| E1 | E2 | E3 | F1 | F2 | F3 | F4 | F5 |
| F6 | F7 | F8 | G1 | G2 | G3 | G4 | G5 |
| G6 | G7 | G8 | G9 | G10 | G11 | G12 | G13 |
| G14 | G15 | H1 | | | | | |

Alternative Solution
(Please circle and detail below)

| | | | | | | | |
|-----|-----|----|----|-----|-----|-----|-----|
| B1 | B2 | C1 | C2 | C3 | C4 | D1 | D2 |
| E1 | E2 | E3 | F1 | F2 | F3 | F4 | F5 |
| F6 | F7 | F8 | G1 | G2 | G3 | G4 | G5 |
| G6 | G7 | G8 | G9 | G10 | G11 | G12 | G13 |
| G14 | G15 | H1 | | | | | |

Additional information

12. Compliance with New Zealand Building Code

NZBC Clause

Tick relevant building code clauses

- B1** Structure
- B2** Durability
- C1-C2-C3-C4** Fire
- D1** Access routes
- D2** Mechanical installations for access
- E1** Surface water
- E2** External moisture
- E3** Internal moisture
- F1** Hazardous agents on site
- F2** Hazardous building materials
- F3** Hazardous substances & processes
- F4** Safety from falling
- F5** Construction & demolition hazards
- F6** Lighting for emergency
- F7** Warning systems
- F8** Signs
- G1** Personal hygiene
- G2** Laundering
- G3** Food preparation & prevention of contamination
- G4** Ventilation
- G5** Interior environment
- G6** Airborne & impact sound
- G7** Natural light
- G8** Artificial light
- G9** Electricity
- G10** Pipes services
- G11** Gas as an energy source
- G12** Water supplies
- G13** Foul water
- G14** Industrial liquid waste
- G15** Solid waste
- H1** Energy efficiency

Means of compliance

Please circle or add means of compliance

Proposed inspections

Please circle as appropriate - see key below

| | | | | | | |
|----------------|-------------|-------------------------------|---------------|---|---|---|
| B1/AS2 | NZS 4229 | NZS 3604 | NZS 4204 | 1 | 2 | 3 |
| B2/AS1 | NZS 3604 | NZS 3101 | NZS 3602 | 1 | 2 | 3 |
| C1/AS1 | C4/AS1 | C2/AS1 | C3/AS1 | 1 | 2 | 3 |
| D1/AS1 | | NZS 4121 | | 1 | 2 | 3 |
| D2/AS1 | | NZS 4322 | EM/81 | 1 | 2 | 3 |
| E1/AS1 | | AS/NZS 3500 | | 1 | 2 | 3 |
| E2/AS1 | | Specific Design | | 1 | 2 | 3 |
| E3/AS1 | | | | 1 | 2 | 3 |
| F1/AS1 | | | | 1 | 2 | 3 |
| F2/AS1 | | NZS 4233 | | 1 | 2 | 3 |
| F3/AS1 | | | | 1 | 2 | 3 |
| F4/AS1 | | Fencing of Swimming Pools Act | | 1 | 2 | 3 |
| F5/AS1 | | | | 1 | 2 | 3 |
| F6/AS1 | AS/NZS 1668 | NZS 4512 | NZS 4515 | 1 | 2 | 3 |
| F7/AS1 | AS/NZS 1668 | NZS 4512 | NZS 4515 | 1 | 2 | 3 |
| F8/AS1 | | | | 1 | 2 | 3 |
| G1/AS1 | | | | 1 | 2 | 3 |
| G2/AS1 | | | | 1 | 2 | 3 |
| G3/AS1 | | | | 1 | 2 | 3 |
| G4/AS1 | | | | 1 | 2 | 3 |
| G5/AS1 | | | | 1 | 2 | 3 |
| G6/AS1 | | | | 1 | 2 | 3 |
| G7/AS1 | | | | 1 | 2 | 3 |
| G8/AS1 | | NZS 6703 | | 1 | 2 | 3 |
| G9/AS1 | | | | 1 | 2 | 3 |
| G10/AS1 | | NZS 5261 | | 1 | 2 | 3 |
| G11/AS1 | | | | 1 | 2 | 3 |
| G12/AS1 | C4/AS1 | AS/NZS 3500.2 | AS/NZS 3500.5 | 1 | 2 | 3 |
| G13/AS1 | | AS/NZS 3500.2 | BS 5572 | 1 | 2 | 3 |
| G14/AS1 | | | | 1 | 2 | 3 |
| G15/AS1 | | | | 1 | 2 | 3 |
| H1/AS1 | NZS 4212 | NZS 4218 | NZS 4243 | 1 | 2 | 3 |
| | | ALF design manual | | | | |

Key to proposed inspections:

1. Council Building Control Officer
2. Approved Consultant e.g. Engineer
3. Other - Please specify below

| |
|--|
| |
| |
| |
| |

Important

The Building Act requires the applicant to state, for each relevant building code clause, what the means of compliance is. Alternative solutions may also be proposed, and must be accompanied with documentation demonstrating compliance. Please refer to Alternative Solution box previous page and provide additional information. Refer to guidance notes on separate sheet for typical scenarios.

Please turn over

12. Compliance schedule

Do not proceed further if

- this is an application for a PIM only (Project Information Memorandum)
- this application is for Residential work only (except for a cable car after 31 March 2008)

The following specified systems are new, existing, being altered, added to, or removed in the course of building work

There are no specified systems in the building

| | New | Existing | Altered | Added | Removed |
|---|-----------------------|-----------------------|-----------------------|-----------------------|-----------------------|
| Cable Car (including to individual dwelling) (to be implemented 31 March 2008) | <input type="radio"/> | <input type="radio"/> | <input type="radio"/> | <input type="radio"/> | <input type="radio"/> |

Building Act 2004 (implemented 31 March 2005) (listed below are the systems and features from the 'new' Act)

| | | | | | |
|--|-----------------------|-----------------------|-----------------------|-----------------------|-----------------------|
| 1. Automatic systems for fire suppression (for example, sprinkler systems) | <input type="radio"/> | <input type="radio"/> | <input type="radio"/> | <input type="radio"/> | <input type="radio"/> |
| 2. Automatic or manual emergency warning systems for fire or other dangers | <input type="radio"/> | <input type="radio"/> | <input type="radio"/> | <input type="radio"/> | <input type="radio"/> |
| 3. Electromagnetic or automatic doors or windows (for example, ones that close on fire alarm activation) | <input type="radio"/> | <input type="radio"/> | <input type="radio"/> | <input type="radio"/> | <input type="radio"/> |
| 4. Emergency lighting systems | <input type="radio"/> | <input type="radio"/> | <input type="radio"/> | <input type="radio"/> | <input type="radio"/> |
| 5. Escape route pressurisation systems | <input type="radio"/> | <input type="radio"/> | <input type="radio"/> | <input type="radio"/> | <input type="radio"/> |
| 6. Riser mains for Fire Service's use | <input type="radio"/> | <input type="radio"/> | <input type="radio"/> | <input type="radio"/> | <input type="radio"/> |
| 7. Any automatic back-flow preventers connected to a potable water supply | <input type="radio"/> | <input type="radio"/> | <input type="radio"/> | <input type="radio"/> | <input type="radio"/> |
| 8. Lifts, escalators, travelators, or other systems for moving people or goods within buildings | <input type="radio"/> | <input type="radio"/> | <input type="radio"/> | <input type="radio"/> | <input type="radio"/> |
| 9. Mechanical ventilation or air conditioning systems | <input type="radio"/> | <input type="radio"/> | <input type="radio"/> | <input type="radio"/> | <input type="radio"/> |
| 10. Building maintenance units providing access to exterior and interior walls of buildings | <input type="radio"/> | <input type="radio"/> | <input type="radio"/> | <input type="radio"/> | <input type="radio"/> |
| 11. Laboratory fume cupboards | <input type="radio"/> | <input type="radio"/> | <input type="radio"/> | <input type="radio"/> | <input type="radio"/> |
| 12. Audio loops or other assistive listening systems | <input type="radio"/> | <input type="radio"/> | <input type="radio"/> | <input type="radio"/> | <input type="radio"/> |
| 13. Smoke control systems | <input type="radio"/> | <input type="radio"/> | <input type="radio"/> | <input type="radio"/> | <input type="radio"/> |
| 14. Emergency power systems for, or signs relating to, a system or feature specified in any of the above | <input type="radio"/> | <input type="radio"/> | <input type="radio"/> | <input type="radio"/> | <input type="radio"/> |
| 15. Means of escape with systems and features (1 to 6, 9 and 13) | <input type="radio"/> | <input type="radio"/> | <input type="radio"/> | <input type="radio"/> | <input type="radio"/> |

Please continue for Building Act 1991 (implemented 1 January 1993)

12. Compliance Schedule - continued

The following specified systems are existing, being altered, added to, or removed in the course of building work

Existing Altered Added Removed

Building Act 1991 (implemented 1 January 1993)
 (listed below are the systems and features from the 'old' Act)

| | | | | |
|---|-----------------------|-----------------------|-----------------------|-----------------------|
| 1. Automatic systems for fire suppression (for example, sprinkler systems) | <input type="radio"/> | <input type="radio"/> | <input type="radio"/> | <input type="radio"/> |
| 2. Automatic or manual emergency warning systems for fire or other dangers | <input type="radio"/> | <input type="radio"/> | <input type="radio"/> | <input type="radio"/> |
| 3. Emergency warning systems for fire or other dangers (eg. manual or automatic fire alarm) | <input type="radio"/> | <input type="radio"/> | <input type="radio"/> | <input type="radio"/> |
| 4. Emergency lighting | <input type="radio"/> | <input type="radio"/> | <input type="radio"/> | <input type="radio"/> |
| 5. Escape route pressurisation | <input type="radio"/> | <input type="radio"/> | <input type="radio"/> | <input type="radio"/> |
| 6. Riser mains | <input type="radio"/> | <input type="radio"/> | <input type="radio"/> | <input type="radio"/> |
| 7. Back-flow preventers | <input type="radio"/> | <input type="radio"/> | <input type="radio"/> | <input type="radio"/> |
| 8. Lifts (including escalators, passengers, service, goods) | <input type="radio"/> | <input type="radio"/> | <input type="radio"/> | <input type="radio"/> |
| 9. Mechanical ventilation and air conditioning | <input type="radio"/> | <input type="radio"/> | <input type="radio"/> | <input type="radio"/> |
| 10. Other mechanical, electrical, hydraulic or electronic systems | <input type="radio"/> | <input type="radio"/> | <input type="radio"/> | <input type="radio"/> |
| 11. Building maintenance units | <input type="radio"/> | <input type="radio"/> | <input type="radio"/> | <input type="radio"/> |
| 12. Signs (for items 1 to 11 above) | <input type="radio"/> | <input type="radio"/> | <input type="radio"/> | <input type="radio"/> |
| 13. Means of escape | <input type="radio"/> | <input type="radio"/> | <input type="radio"/> | <input type="radio"/> |
| 14. Safety barriers | <input type="radio"/> | <input type="radio"/> | <input type="radio"/> | <input type="radio"/> |
| 15. Access and facilities for people with disabilities | <input type="radio"/> | <input type="radio"/> | <input type="radio"/> | <input type="radio"/> |
| 16. Hosereels and/or fire extinguishers | <input type="radio"/> | <input type="radio"/> | <input type="radio"/> | <input type="radio"/> |
| 17. Signs (for items 13 to 16 above) | <input type="radio"/> | <input type="radio"/> | <input type="radio"/> | <input type="radio"/> |

Address where compliance schedule will be held:

The maximum number of occupants that the building is designed for:

Amendments to a compliance schedule also requires Form 005 - Application for Amendment for Compliance Schedule

Please turn over

OFFICE USE ONLY

BCA

Date application received 21-7-09
 Receiving Officer CSH
 Application Fee Receipt No. \$230.00 31311
 Date of application Fee Rec. 21-7-09

Fees (incl. GST)

| | |
|--|-----------|
| Building Consent Application (Prepaid) <i>IA</i> | \$ 230.00 |
| Building Consent Issue | \$ |
| PIM | \$ |
| Building Levy (DBH) | \$ |
| BRANZ Levy | \$ |
| Stormwater Connection | \$ |
| Vehicle Crossing | \$ |
| Sewer Connection | \$ |
| Water Connection | \$ |
| Fordell Connection (Application charge) | \$ |
| Development Contribution Levy | \$ |
| NZFS Alternative Solution | \$ |
| Resource Consent | \$ |
| Relocation Bond | \$ |
| Certificate of Title | \$ |
| Rural Rapid Number | \$ |
| Other | \$ |
| Total | \$ |

Comments:

| |
|--|
| |
| |
| |
| |
| |
| |
| |
| |
| |
| |

Processing

| Unit | Checks | | | | Inspections No. | Approved | |
|--|----------|---------|----------|------|--------------------|----------|---------|
| | Initials | Date | Initials | Date | | Initials | Date |
| Administration | CSH | 22-7-09 | | | | | |
| Planning | | | | | | | |
| Fire Design (Referred to NZFS) | | | | | | | |
| Building | | | | | | | |
| Drainage (Infrastructure) | | | | | | | |
| Water (Infrastructure) | | | | | | | |
| Fordell Water Scheme (Infrastructure) | | | | | | | |
| Structural | | | | | | | |
| Plumbing/Drainage | | | | | | CG | 23/7/09 |
| Roading | | | | | | | |
| Health | | | | | | | |
| Dangerous Goods | | | | | | | |

Approved for issue of PIM/Building Consent

Approving Officer

[Signature]

Date

23 JUL 2009

Notes

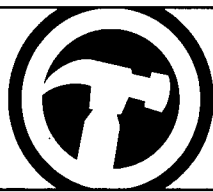

I. Check sheet - Housing/housing alterations

Street address

22 Shakespeare Rd

(Additional information will need to be supplied if a resource consent is required)

This is a preliminary vetting sheet only to establish if there is sufficient information of an acceptable quality before it is received for lodgement and processing. This is not a comprehensive list of requirements. This prelodgement form is designed to reduce processing time and save you on processing costs.

Plans are required to a suitable drafting standard.

Note: If you do not have the appropriate skills to prepare drawings, please engage a professional 2 copies of all documentation is required (3 if resource consent required).

Tick where applicable under Yes, No or Not applicable

| Requirements | Owner supplied Date / / | | | Council check Date 21 / 7 / 09 | | | Council recheck Date / / | | |
|--|-------------------------------------|--------------------------|-------------------------------------|-------------------------------------|--------------------------|-------------------------------------|-----------------------------|--------------------------|--------------------------|
| | Y | N | N/A | Y | N | N/A | Y | N | N/A |
| 1. Building Consent Application form (1 copy) - fully filled in and signed | <input checked="" type="checkbox"/> | <input type="checkbox"/> | <input type="checkbox"/> | <input checked="" type="checkbox"/> | <input type="checkbox"/> | <input type="checkbox"/> | <input type="checkbox"/> | <input type="checkbox"/> | <input type="checkbox"/> |
| 2. Application fee | <input checked="" type="checkbox"/> | <input type="checkbox"/> | <input type="checkbox"/> | <input checked="" type="checkbox"/> | <input type="checkbox"/> | <input type="checkbox"/> | <input type="checkbox"/> | <input type="checkbox"/> | <input type="checkbox"/> |
| 3. Copy of Certificate of Title (1 copy) | <input type="checkbox"/> | <input type="checkbox"/> | <input checked="" type="checkbox"/> | <input type="checkbox"/> | <input type="checkbox"/> | <input checked="" type="checkbox"/> | <input type="checkbox"/> | <input type="checkbox"/> | <input type="checkbox"/> |
| 4. Site plan - to scale, fully dimensioned showing drainage, north point, street vehicle crossing, site coverage, distance to boundaries, levels | <input checked="" type="checkbox"/> | <input type="checkbox"/> | <input type="checkbox"/> | <input checked="" type="checkbox"/> | <input type="checkbox"/> | <input type="checkbox"/> | <input type="checkbox"/> | <input type="checkbox"/> | <input type="checkbox"/> |
| 5. Floor plan - to scale, fully dimensioned, rooms named, windows/doors, bracing, fixtures, smoke detector positions | <input type="checkbox"/> | <input type="checkbox"/> | <input checked="" type="checkbox"/> | <input type="checkbox"/> | <input type="checkbox"/> | <input checked="" type="checkbox"/> | <input type="checkbox"/> | <input type="checkbox"/> | <input type="checkbox"/> |
| 6. Elevations - to scale. All sides to be shown, windows/door, heights, materials, daylight plane, ground contours (before and after) | <input type="checkbox"/> | <input type="checkbox"/> | <input checked="" type="checkbox"/> | <input type="checkbox"/> | <input type="checkbox"/> | <input checked="" type="checkbox"/> | <input type="checkbox"/> | <input type="checkbox"/> | <input type="checkbox"/> |
| 7. Cross sections - through key building points, heights, materials, timber treatment/grades | <input type="checkbox"/> | <input type="checkbox"/> | <input checked="" type="checkbox"/> | <input type="checkbox"/> | <input type="checkbox"/> | <input checked="" type="checkbox"/> | <input type="checkbox"/> | <input type="checkbox"/> | <input type="checkbox"/> |
| 8. Drainage long sections - crown of road, stormwater (septic tank design), depths, cover | <input type="checkbox"/> | <input type="checkbox"/> | <input checked="" type="checkbox"/> | <input type="checkbox"/> | <input type="checkbox"/> | <input checked="" type="checkbox"/> | <input type="checkbox"/> | <input type="checkbox"/> | <input type="checkbox"/> |
| 9. Specific details - weathering, window/door details, flashings, parapet, deck, junctions, cavity, foundations etc | <input type="checkbox"/> | <input type="checkbox"/> | <input checked="" type="checkbox"/> | <input type="checkbox"/> | <input type="checkbox"/> | <input checked="" type="checkbox"/> | <input type="checkbox"/> | <input type="checkbox"/> | <input type="checkbox"/> |
| 10. Bracing schedule - walls and roof (subfloor when required) | <input type="checkbox"/> | <input type="checkbox"/> | <input checked="" type="checkbox"/> | <input type="checkbox"/> | <input type="checkbox"/> | <input checked="" type="checkbox"/> | <input type="checkbox"/> | <input type="checkbox"/> | <input type="checkbox"/> |
| 11. Roof truss layout/design certificate - fixings | <input type="checkbox"/> | <input type="checkbox"/> | <input checked="" type="checkbox"/> | <input type="checkbox"/> | <input type="checkbox"/> | <input checked="" type="checkbox"/> | <input type="checkbox"/> | <input type="checkbox"/> | <input type="checkbox"/> |
| 12. Risk matrix calculation sheet - weathertightness | <input type="checkbox"/> | <input type="checkbox"/> | <input checked="" type="checkbox"/> | <input type="checkbox"/> | <input type="checkbox"/> | <input checked="" type="checkbox"/> | <input type="checkbox"/> | <input type="checkbox"/> | <input type="checkbox"/> |
| 13. Specific engineering design - Engineer's calculations (+ PSI) - Level of construction monitoring to be carried out by engineer | <input type="checkbox"/> | <input type="checkbox"/> | <input checked="" type="checkbox"/> | <input type="checkbox"/> | <input type="checkbox"/> | <input checked="" type="checkbox"/> | <input type="checkbox"/> | <input type="checkbox"/> | <input type="checkbox"/> |
| 14. Specification - comprehensive, references to Codes, Standards (specific to project) | <input type="checkbox"/> | <input type="checkbox"/> | <input checked="" type="checkbox"/> | <input type="checkbox"/> | <input type="checkbox"/> | <input checked="" type="checkbox"/> | <input type="checkbox"/> | <input type="checkbox"/> | <input type="checkbox"/> |
| 15. Manufacturer's specification for woodburners, sewage pumps, specialised processes etc. | <input type="checkbox"/> | <input type="checkbox"/> | <input checked="" type="checkbox"/> | <input type="checkbox"/> | <input type="checkbox"/> | <input checked="" type="checkbox"/> | <input type="checkbox"/> | <input type="checkbox"/> | <input type="checkbox"/> |

Notes:

Plans OK to accept for processing

Officer: GBH

Date: 21.7.09

2. Check sheet - Commercial/Industrial (in addition to the previous page)

Commercial and industrial buildings are often extremely complex projects. This is a preliminary vetting sheet only to establish if there is sufficient information of an acceptable quality before it is received for lodgment and processing. This is not a comprehensive list of requirements. This prelodgement form is designed to reduce processing time and save you on processing costs.

Note: If you do not have the appropriate skills to prepare drawings, please engage a professional 2 copies of all documentation is required.



Tick where applicable under Yes, No or Not applicable

| Requirements | Owner supplied Date / / | Council check Date / / | Council recheck Date / / |
|---|-------------------------------|------------------------------|--------------------------------|
| | Y N N/A | Y N N/A | Y N N/A |
| 1. Fire design analysis - (3 copies required for NZFS, DRU if alternative solution) | ○ ○ ○ | ○ ○ ○ | ○ ○ ○ |
| 2. Toilet calculation (G.I.) Separate facilities, unisex, accessibility | ○ ○ ○ | ○ ○ ○ | ○ ○ ○ |
| 3. Access and facilities for people with disabilities Toilets, ramps, counters | ○ ○ ○ | ○ ○ ○ | ○ ○ ○ |
| 4. If change of use refer to additional requirements (see section 114, 115) | ○ ○ ○ | ○ ○ ○ | ○ ○ ○ |
| 5. Specialist services details f/ alarm, auto doors, lift, e/lighting, lighting, H.I. energy efficiency, HVAC, signs, (health, dangerous goods) | ○ ○ ○ | ○ ○ ○ | ○ ○ ○ |
| 6. Compliance Schedule details - fill in application form also | ○ ○ ○ | ○ ○ ○ | ○ ○ ○ |
| 7. Specialist engineering (PS1, PS2) Portal frames, precast concrete, blockwork, specific details | ○ ○ ○ | ○ ○ ○ | ○ ○ ○ |
| 8. Carparking calculations for numbers, commercial vehicle crossing, accessible carpark, drainage, loading bay | ○ ○ ○ | ○ ○ ○ | ○ ○ ○ |
| 9. Requirement for Certificate for Public Use (see 363) - staging, use of building before CCC | ○ ○ ○ | ○ ○ ○ | ○ ○ ○ |
| 10. Stormwater design, EI calculations, for yards and buildings etc. | ○ ○ ○ | ○ ○ ○ | ○ ○ ○ |
| | ○ ○ ○ | ○ ○ ○ | ○ ○ ○ |
| | ○ ○ ○ | ○ ○ ○ | ○ ○ ○ |
| | ○ ○ ○ | ○ ○ ○ | ○ ○ ○ |
| | ○ ○ ○ | ○ ○ ○ | ○ ○ ○ |
| | ○ ○ ○ | ○ ○ ○ | ○ ○ ○ |
| | ○ ○ ○ | ○ ○ ○ | ○ ○ ○ |
| Plans OK to accept for processing <input type="radio"/> | Notes: | | |
| Officer: <input type="text"/> | | | |
| Date: <input type="text"/> | | | |

OFFICE USE ONLY

Date received Application # Document # Project #

Property ID Legal ID Receipt # Amount Paid \$

| | | | |
|-------------------------------------|--|---|---|
| Address | 22 Shakespeare Rd WANGANUI | |  |
| Property No | 13558 | Status | Current |
| Owners As At | 27/08/2004 |  |  |
| Owners | Mr Philip J Kubiak & Mrs Heather M Kubiak | | |
| Default Postal Address | 22 Shakespeare Rd Wanganui | | |
| Property Override Legal Description | LOT 11 DP 1304 Part 0.1545 Ha | | |
| Property Type | <input type="text"/> | | |
| Additional Description | <input type="text"/> | | |

Wanganui District Council

PO Box 637, Wanganui

Phone (06) 349 0001

Visit our Web Site www.wanganui.govt.nz

OFFICIAL RECEIPT

GST Reg No 51-668-324

21/07/2009

Receipt No: 313111

To: Palmers Plumbing

| <u>Type</u> | <u>Reference</u> | <u>Amount</u> |
|------------------------------------|------------------|---------------|
| GL Receipt | NOGPRECONSENT | \$230.00 |
| Sewer connection 22 Shakespeare Rd | | |
| Total: | | \$230.00 |

Amounts Tendered

| | |
|----------|----------|
| Cheque | \$230.00 |
| Total | \$230.00 |
| Rounding | \$0.00 |
| Change | \$0.00 |

Printed 21/07/2009 11:47:27 a.m.

101 Guyton Street
P O Box 637, Wanganui 4500
Phone: (06) 349 0001
Fax: (06) 349 0000
Email: wdc@wanganui.govt.nz
Web: www.wanganui.govt.nz



PREPAID - TAX INVOICE

GST Number 51-668-324

Payers Name:

PALMER'S PLUMBING
27 HEADS
WANG

For Building Consent:

Reference No:

Date: 21. 7. 09

YOUR APPLICATION WILL NOT BE PROCESSED UNLESS THE FEE IS PAID

Location of project

Description of project

22 SHAKESPEARE

WDC SEWER CONNECTION.

Reference Details

Amount (Incl GST)

- | | |
|--|-----------|
| 1. Building Consent Project Type – application fee (refer to 'Fees 1A and Charges' Form) | \$ 230.00 |
| 2. Resource Consent - deposit | |
| • Land use - Non-Notified | \$ |
| • Subdivision - Notified | \$ |
| 3. Other - Aerial photographs | \$ |
| - Plan pack Searches | \$ |
| - Rural Rapid Numbers (New) | \$ |
| - Large Plan photocopying A2 | \$ |
| A0 – A1 | \$ |
| 4. Certificate of Title | \$ |

Total Payable \$ 230.00

WHEN PAID THIS FORM WILL BE PART OF YOUR CONSENT APPLICATION AND MUST BE ATTACHED TO THE CONSENT APPLICATION BEFORE IT WILL BE PROCESSED.

PLEASE RETURN TO CUSTOMER SERVICES

Chris Gould

From: Robert Van Bentum
Sent: Wednesday, 24 June 2009 14:30
To: Chris Gould; Jeff Jamieson
Cc: Chris Carter
Subject: FW: 22 Shakespeare Road - sewerage services connectio

Jeff, Chris

Can you please note the following and ensure that no connection fee is levied in respect of the sewer connection for 22 Shakepeare Road.

Thanks Robert

From: Rick Grobecker
Sent: Wednesday, 24 June 2009 2:19 p.m.
To: 'David Boothway'
Cc: Robert Van Bentum
Subject: RE: 22 Shakespeare Road - sewerage services connectio

Hi David
given that they have started I would have no objection to a 1 mth extension.

regards!
Rick

From: David Boothway [mailto:David.P.Boothway@nz.mwhglobal.com]
Sent: Wednesday, 24 June 2009 1:11 p.m.
To: Timothy Broadhead; Rick Grobecker
Subject: RE: 22 Shakespeare Road - sewerage services connectio

Hi Ric

The owners and 22 Shakespeare would like to confirm that they would still qualify for the "zero connection fee" as they have started the process, even though the physical works would take place after 30June.

I deem this a reasonable request.

Please confirm you support this and forward the email onto the relevant person in council.

Many thanks



David Boothway
Office Manager

MWH New Zealand Ltd DDI: 06-349 1151
8 Bates Street Facsimile: 06-349 1179
PO Box 168 Mobile: 027 496 0643
WANGANUI <http://www.mwhglobal.com/nz>

BUILDING A BETTER WORLD

Consider the environment. Please don't print this e-mail unless you really need to.

From: Timothy Broadhead
Sent: Wednesday, 24 June 2009 1:03 p.m.
To: David Boothway

Subject: FW: 22 Shakespeare Road - sewerage services connectio

David, as discussed



Timothy Broadhead
Engineering Technician

MWH New Zealand Ltd Telephone: 06-349 1130
8 Bates Street Facsimile: 06-349 1179
PO Box 168 Mobile: 0212 969 271
WANGANUI <http://www.mwhglobal.com/nz>

BUILDING A BETTER WORLD

Consider the environment. Please don't print this e-mail unless you really need to.

From: Philip Kubiak [mailto:philip@propertybrokers.co.nz]
Sent: Wednesday, 24 June 2009 12:59 p.m.
To: Timothy Broadhead
Subject: 22 Shakespeare Road - sewerage services connectio

Hi Timothy

Further to our conversation earlier this is to confirm that I own 22 Shakespeare Road, Bastia Hill, along with my wife Heather Kubiak.

Palmers Plumbing (Neville Palmer) is unable to get to our property until next week - we have a confirmed booking with him for next Tuesday 30th June at 4.00pm. From that point Neville will lodge the consent to have the sewer connection to the town supply done and we will have the work scheduled to be done within the next month.

The stormwater is already connected to the kerb.

Thank you and could you please confirm as soon as possible that this is okay.

Kind regards.....Philip
Philip Kubiak
Branch Manager

Property Brokers Ltd MREINZ
200 Victoria Avenue
WANGANUI
Office: 06 345 7714
Mob: ~~06 345 7714~~
A/H: ~~06 345 7714~~
E: Philip@propertybrokers.co.nz
W: www.propertybrokers.co.nz

This email contains confidential information. If you have received this email in error, please delete it immediately, and inform us of the mistake by return email. Any form of reproduction, or further dissemination of this email is strictly prohibited. Also, note that the opinions expressed in this email as those of the author and not necessarily those of the Property Brokers Group Limited.
<http://www.propertybrokers.co.nz>

24/06/2009

Chris Gould

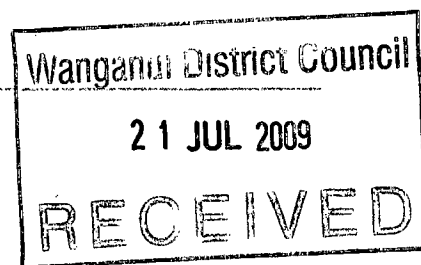

From: Robert Van Bentum
Sent: Wednesday, 24 June 2009 14:30
To: Chris Gould; Jeff Jamieson
Cc: Chris Carter
Subject: FW: 22 Shakespeare Road - sewerage services connectio

Jeff, Chris

Can you please note the following and ensure that no connection fee is levied in respect of the sewer connection for 22 Shakepeare Road.

Thanks Robert

From: Rick Grobecker
Sent: Wednesday, 24 June 2009 2:19 p.m.
To: 'David Boothway'
Cc: Robert Van Bentum
Subject: RE: 22 Shakespeare Road - sewerage services connectio

Hi David
given that they have started I would have no objection to a 1 mth extension.

regards
Rick

From: David Boothway [mailto:David.P.Boothway@nz.mwhglobal.com]
Sent: Wednesday, 24 June 2009 1:11 p.m.
To: Timothy Broadhead; Rick Grobecker
Subject: RE: 22 Shakespeare Road - sewerage services connectio

APPROVED
09 / 06 4 0

Hi Ric

Consent No.

The owners and 22 Shakespeare would like to confirm that they would still qualify for the "zero connection fee" as they have started the process, even though the physical works would take place after 30June.

I deem this a reasonable request.

Please confirm you support this and forward the email onto the relevant person in council.

Many thanks



David Boothway
Office Manager
MWH New Zealand Ltd DDI: 06-349 1151
8 Bates Street Facsimile: 06-349 1179
PO Box 168 Mobile: 027 496 0643
WANGANUI <http://www.mwhglobal.com/nz>

BUILDING A BETTER WORLD
Consider the environment. Please don't print this e-mail unless you really need to.

From: Timothy Broadhead
Sent: Wednesday, 24 June 2009 1:03 p.m.
To: David Boothway

Subject: FW: 22 Shakespeare Road - sewerage services connectio

David, as discussed



Timothy Broadhead
Engineering Technician

MWH New Zealand Ltd Telephone: 06-349 1130
8 Bates Street Facsimile: 06-349 1179
PO Box 168 Mobile: 0212 969 271
WANGANUI <http://www.mwhglobal.com/nz>

BUILDING A BETTER WORLD

Consider the environment. Please don't print this e-mail unless you really need to.

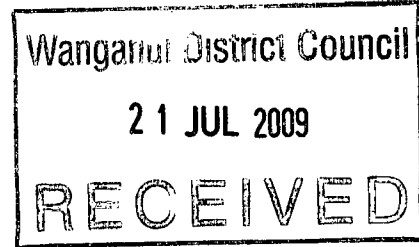

From: Philip Kubiak [mailto:philip@propertybrokers.co.nz]
Sent: Wednesday, 24 June 2009 12:59 p.m.
To: Timothy Broadhead
Subject: 22 Shakespeare Road - sewerage services connectio

Hi Timothy

Further to our conversation earlier this is to confirm that I own 22 Shakespeare Road, Bastia Hill, along with my wife Heather Kubiak.

Palmers Plumbing (Neville Palmer) is unable to get to our property until next week - we have a confirmed booking with him for next Tuesday 30th June at 4.00pm. From that point Neville will lodge the consent to have the sewer connection to the town supply done and we will have the work scheduled to be done within the next month.

The stormwater is already connected to the kerb.

Thank you and could you please confirm as soon as possible that this is okay.

Kind regards.....Philip
Philip Kubiak
Branch Manager

Property Brokers Ltd MREINZ
200 Victoria Avenue
WANGANUI
Office: 06 345 7714
Mob: ~~021 296 9271~~
A/H: ~~06 345 7714~~
E: Philip@propertybrokers.co.nz
W: www.propertybrokers.co.nz

APPROVED
09 / 06 40
Consent No.

This email contains confidential information. If you have received this email in error, please delete it immediately, and inform us of the mistake by return email. Any form of reproduction, or further dissemination of this email is strictly prohibited. Also, note that the opinions expressed in this email as those of the author and not necessarily those of the Property Brokers Group Limited.
<http://www.propertybrokers.co.nz>

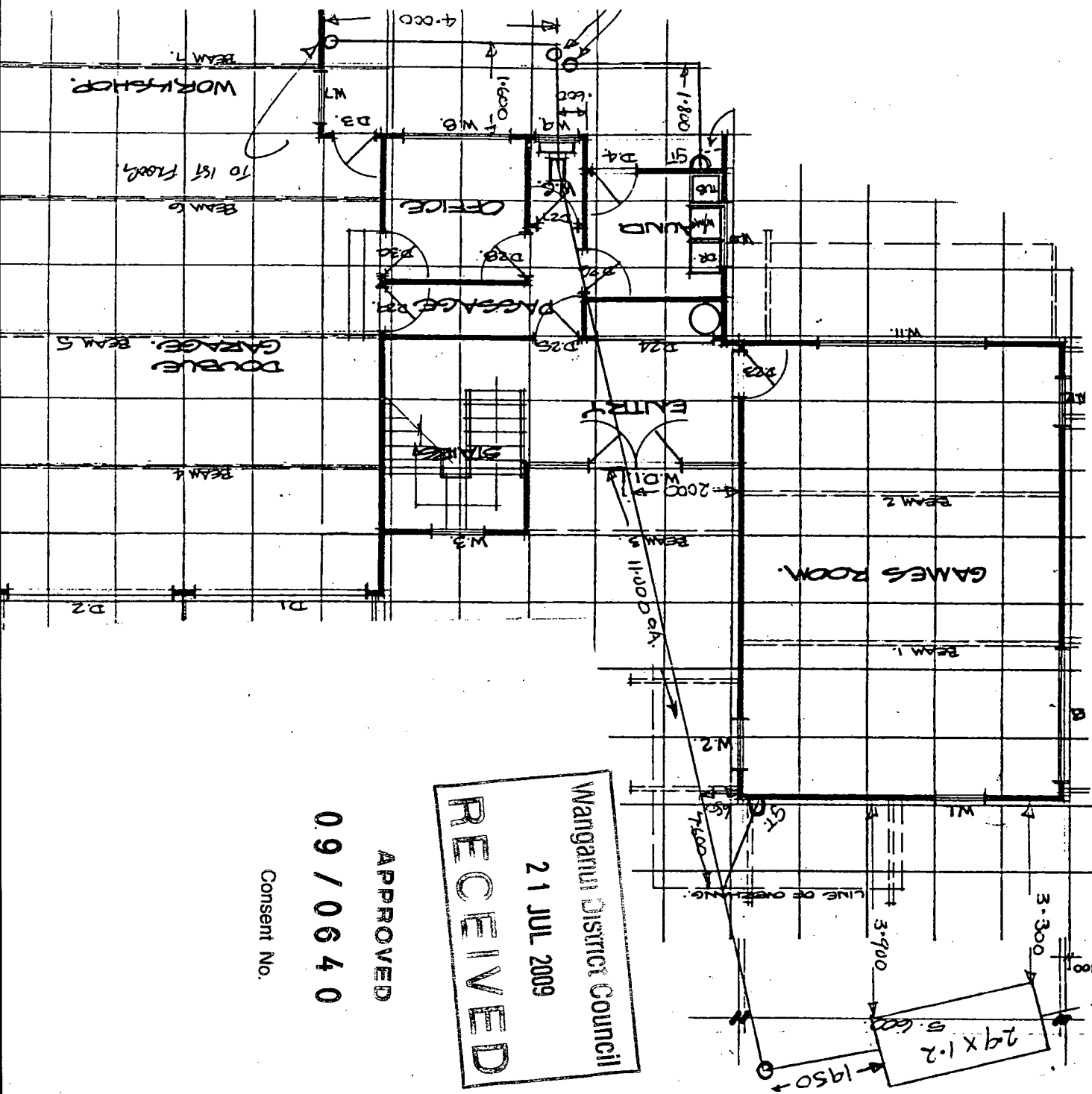

Mr P Kubiak
 22 Shakespeare Rd
 Wanganui

21-7-09

11

Existing Sewer Drainage

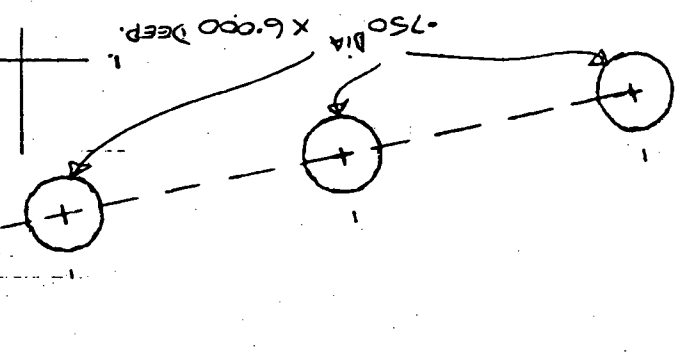

RECEIVED
 21 JUL 2009
 Wanganui District Council

APPROVED
 09 / 06 4 0

Consent No.

Mr P Kubiak
22 Shakespeare Rd
Wangarui
21-7-09
~ ~ ~

Garage

Entry

Games Room

GTap

Existing 100mm
Sewer Drain

Install New 100mm
PVC Sewer Drain

Delete Septic Tank
& Soak holes

New Council Connection

Existing Driveway

RECEIVED
21 JUL 2009
Mangarui District Council

APPROVED
09 / 06 40
Consent No

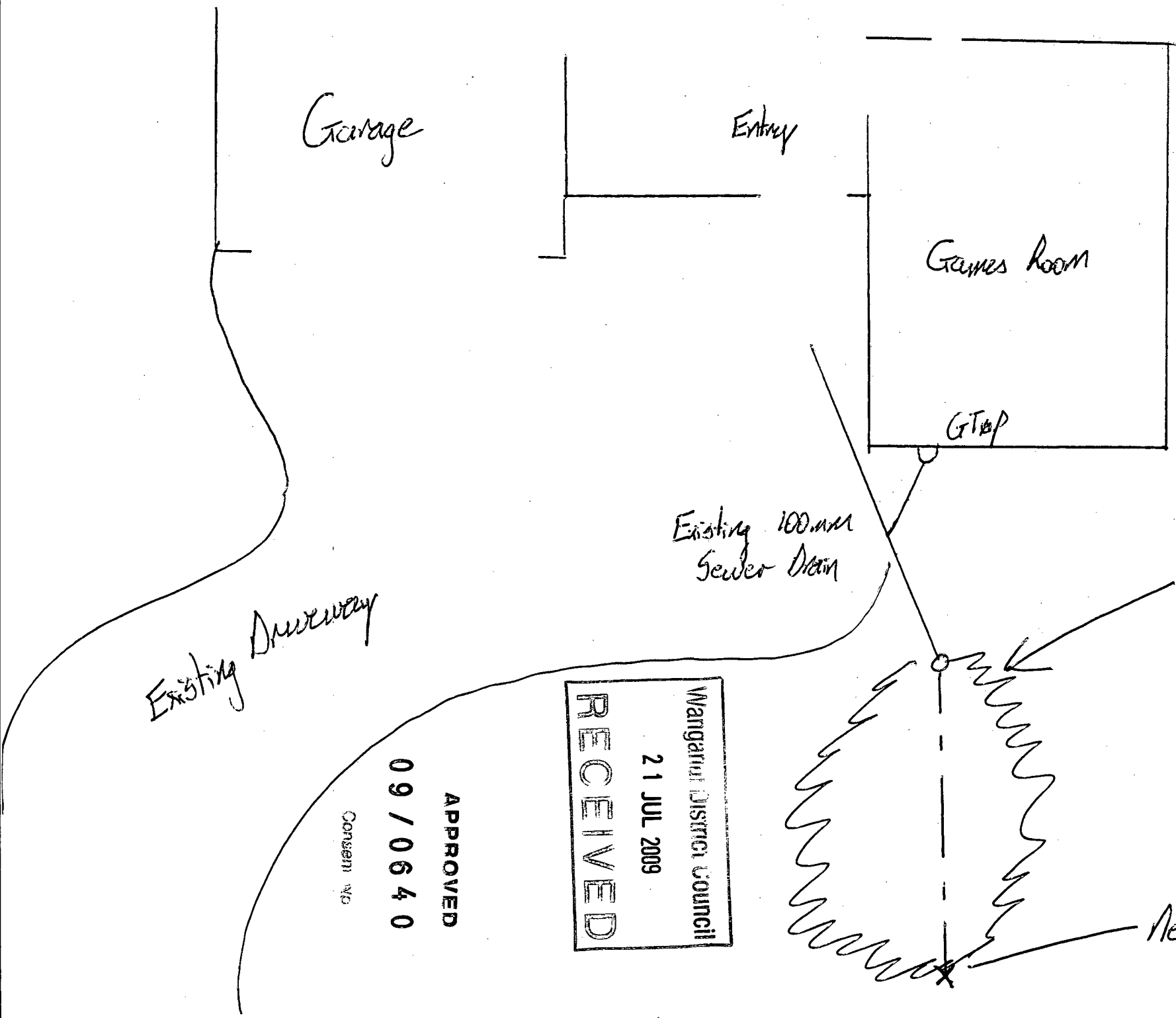



28 March 2011

**Mr Philip J Kubiak &
Mrs Heather M Kubiak
22 Shakespeare Road
Bastia Hill
Wanganui 4500**

COPY

Dear Sir or Madam:

Application Number: BCon 09/0640
Location: 22 Shakespeare Rd WANGANUI
Description: Connect Sanitary Sewer to Existing WDC connection

Council is writing to you to confirm a requirement of the Building Act 2004. All building consents issued after 1 April 2005 are required to be completed **within two years**. Our records show that your building project has exceeded its 20 month duration since the granting of your building consent. Therefore there are important decisions that you and Council will soon have to make.

At the expiry of two years since the granting of your building consent (24/7/2009), Council is required to decide on whether to issue a Code Compliance Certificate for your project as per Section 93(2)(b)(i) of the Building Act 2004.

There are a number of options for you to consider;

1. If your project has been totally completed, (or will be before the 2 year expiry date), then please submit your completed CCC application with all relevant accompanying documentation and/or arrange for your final inspection. If your project has met all the requirements of your approved building consent documents a Code Compliance Certificate will be issued within twenty working days,
2. If you anticipate that you will need more time to complete your project and you will exceed the 2 year timeframe then please notify us at the earliest opportunity. At this stage you will be given the option of applying for an extension of time of between 1 and 3 months. This application has a standard fee of \$40.00 plus the cost of a standard inspection (approximately \$133.00 within the city boundaries). An inspector will then visit your project to ascertain the level of compliance thus far. Please note that your "final" prepaid inspection of your original consent application will still be available for us to complete later. If you complete your project within the extended timeframe please refer to section 1 above,

3. If, for any reason, you anticipate that your project will not be completed within the 2 year & 3 month timeframe, then you will need to contact Council in writing with the reasons, a detailed timetable and another extension application. This application will also attract the \$40.00 fee plus an inspection cost as stated above.

Should the work not be completed Council may refuse to issue a Code Compliance Certificate and your building consent will be suspended. You may then apply to the Department of Building and Housing for a determination. The current trend is that building work under a building consent, for which a Code Compliance Certificate has not been issued, may impact on insurance cover for your property and may complicate any future sale of the property.

As always, Council is here to assist you to achieve a successful outcome for your building project and should you have any concerns or wish to discuss your project further then please do not hesitate to contact us.

Yours Faithfully

COPY

Greg Hoobin
Building Control Officer



INSPECTION TIME REPORT

Building Consent Number BCon09/0640

| | |
|--|----|
| Total Estimated Inspection Time | 50 |
| Total Actual Inspection Time | 0 |
| Inspection Time Difference | 50 |
| At BC Issue Time to be charged. | |
| At Completion Positive amount = time to be credited Negative amount = time to be charged | |

Signed for and on behalf of the Wanganui District Council

65



INSPECTION RECORD

This record, together with the Building Consent and approved plans, is to remain on the construction site at all times.

| | | | |
|--|--|---|--------------------|
| Project Location | TO BOOK AN INSPECTION PLEASE PHONE WDC BUILDING CONTROL | | BCon09/0640 |
| 22 Shakespeare Rd WANGANUI | ON 349 0001 AND QUOTE THE FOLLOWING APPLICATION NUMBER: | | |
| Applicant | Description of Work | | |
| Palmer's Plumbing & Heating 27 Heads Road Wanganui 4500 | Connect Sanitary Sewer to Existing WDC connection (cat:1) | | |
| Builder | Plumber | Drainlayer | |
| No associations of type Builder are linked to this application | No associations of type Plumber are linked to this application | Palmer's Plumbing & Heating 27 Heads Road Wanganui 4500 | |

SUMMARY OF CONDITIONS

Building Consent Number BCon09/0640

PIM Conditions

| Code | Condition |
|------|--|
| | All work on the project must comply with the requirements of the NZ Building Code. |
| | A PIM only document is not an approval to build. A Building Consent is required before building work commences. |
| | W.D.C will follow up on building work not completed within two years of building consent issue. |
| | A Building Consent lapses and is of no effect if the building work has not been started within 12 months of the date of issue. |
| | If the building is public premises it may not be occupied until either a code compliance certificate or certificate for public use has been issued. |
| | Please note [Electrical, and Gasfitting subtrades do not form part of the building consent inspection process. However, Council is required to receive 'Energy Certificates' from both of these trades before issue of a Code Compliance Certificate]. |

Building Consent Conditions

| Code | Condition |
|------|-----------|
| | |

Your project's inspections are listed on the next page...

101 Guyton Street
 P O Box 637, Wanganui
 Phone: (06) 349 0001
 Fax: (06) 349 0000
 Email: wdc@wanganui.govt.nz
 Web: www.wanganui.govt.nz



Please Note: A minimum of 24 hours notice is required for the booking of an inspection. The inspection record sheet and accompanying building consent documentation must be on site for use by the inspector at the time of the inspection.

| Inspections Record For Building Consent Number BCon09/0640 | | | | | | |
|---|---------------------------|-------------|------------------|---------------------------|------------------|--------------|
| <i>Inspection</i> | <i>When to Request</i> | <i>Date</i> | <i>Inspector</i> | <i>Complies with Code</i> | <i>Reinspect</i> | <i>Notes</i> |
| SANITARY DRAINS INSPECTION | Before backfilling drains | | | | | |



BUILDING CONSENT NUMBER BCon09/0640

Section 51, Building Act 2004

Palmers Plumbing & Heating
27 Heads Road
Wanganui 4500

Project Information **BCon09/0640**
Memorandum No:
Issue Date: **23/07/2009**

| Project Location | Assessment Number/Legal Description |
|---------------------------------------|---|
| 22 Shakespeare Rd WANGANUI | LOT 11 DP 1304 Part 0.1545 Ha |
| Type of Work | Description of Work |
| Ancillary Building Work (req. 1 insp) | Connect Sanitary Sewer to Existing WDC connection (cat:1) |
| Intended Life | Estimated Value (\$) |
| 50 Years | 2000.00 |

This building consent is a consent under the Building Act 2004 to undertake building work in accordance with the attached plans and specifications so as to comply with the provisions of the building code. It does not affect any duty or responsibility under any other Act nor permit any breach of any other Act.

This Building Consent is issued subject to the attached pages headed 'Conditions of Building Consent Number BCon09/0640'

Signed for and on behalf of the Wanganui District Council

D M Hall
Senior Building Control Officer

Date: 24 July, 2009



CONDITIONS OF BUILDING CONSENT NUMBER BCon09/0640

Section 51, Building Act 2004

This Building Consent is issued Subject to the following conditions:

- **[Informative note: The Building Consent, conditions, inspection sheet, and approved plans must be kept on site at all times until completion of the project.]**
- **[Informative note: Failure to request inspections will risk the non-issuing of a code compliance certificate and the structure may be deemed non-complying.]**
- **[Informative note: Any inspection time required over and above that allowed may incur a further charge.]**
- **[Informative note: Under Section 52, a building consent lapses and is of no effect if the building work to which it relates is not commenced within 12 months after the date of issue.]**
- **[Informative note: Under Section 93, if the owner has not made application within 24 months, the BCA (Building Control Authority), must decide whether or not to issue a CCC (Code Compliance Certificate).]**

With Compliments

Palmers **Plumbing & Heating Ltd.**



Hi Phillip & Heather

The installed drains are as per
original plan.

As built as per original

Agds Reville



Garage

Entry

Games Room

GTap

Existing 100mm
Sewer Drain

Mr P Kubia
22 Shakespeare
Wanganui

21-7-09

11

Existing Driveway

Install New 100mm
PVC Sewer Drain

Delete Septic Tank
& Soak holes

RECEIVED
21 JUL 2009
Wanganui District Council

Consent No

0910640

APPROVED

New Council Connection
As built per original AD Plans



PROJECT INFORMATION MEMORANDUM NUMBER BCon09/0640

Section 34, Building Act 2004

Palmers Plumbing & Heating
27 Heads Road
Wanganui 4500

Issue Date: 23/07/2009

| | |
|---------------------------------------|---|
| Project Location | Assessment Number/Legal Description |
| 22 Shakespeare Rd WANGANUI | LOT 11 DP 1304 Part 0.1545 Ha |
| Category | Description of Work |
| Ancillary Building Work (req. 1 insp) | Connect Sanitary Sewer to Existing WDC connection (cat:1) |
| Intended Life | Estimated Value (\$) |
| 50 Years | 2000.00 |

This Project Information Memorandum is confirmation that the proposed work may be undertaken, subject to the provisions of the Building Act 2004 and any requirements of the Building Consent (number BCon09/0640), which has been granted.

This Project Information Memorandum is subject to the following conditions:

- **All work on the project must comply with the requirements of the NZ Building Code.**

Signed for and on behalf of the Wanganui District Council

A handwritten signature in black ink, appearing to read "D M Hall".

D M Hall
Senior Building Control Officer

Date: 24 July, 2009



INSPECTION RECORD

This record, together with the Building Consent and approved plans, is to remain on the construction site at all times.

| | | | |
|--|--|---|--------------------|
| Project Location | TO BOOK AN INSPECTION PLEASE PHONE WDC BUILDING CONTROL ON 349 0001 AND QUOTE THE FOLLOWING APPLICATION NUMBER: | | BCon09/0640 |
| 22 Shakespeare Rd WANGANUI | | | |
| Applicant | Description of Work | | |
| Palmer's Plumbing & Heating 27 Heads Road Wanganui 4500 | Connect Sanitary Sewer to Existing WDC connection (cat:1) | | |
| Builder | Plumber | Drainlayer | |
| No associations of type Builder are linked to this application | No associations of type Plumber are linked to this application | Palmer's Plumbing & Heating 27 Heads Road Wanganui 4500 | |

SUMMARY OF CONDITIONS

Building Consent Number BCon09/0640

PIM Conditions

| Code | Condition |
|------|--|
| | All work on the project must comply with the requirements of the NZ Building Code. |
| | A PIM only document is not an approval to build. A Building Consent is required before building work commences. |
| | W.D.C will follow up on building work not completed within two years of building consent issue. |
| | A Building Consent lapses and is of no effect if the building work has not been started within 12 months of the date of issue. |
| | If the building is public premises it may not be occupied until either a code compliance certificate or certificate for public use has been issued. |
| | Please note [Electrical, and Gasfitting subtrades do not form part of the building consent inspection process. However, Council is required to receive 'Energy Certificates' from both of these trades before issue of a Code Compliance Certificate]. |

Building Consent Conditions

| Code | Condition |
|------|-----------|
| | |

Your project's inspections are listed on the next page...



Please Note: A minimum of 24 hours notice is required for the booking of an inspection. The inspection record sheet and accompanying building consent documentation must be on site for use by the inspector at the time of the inspection.

All inspections are to be carried out by BCA Building Inspectors unless prior arrangements have been made by the BCA to have an approved qualified person inspect specific items (eg. Engineer). Inspections shall be carried out in accordance with the attached schedule of inspection types. It is the owner's responsibility to ensure all necessary inspections are carried out as required. Please contact WDC if you are unsure what requires inspection – do not cover or enclose any building work without inspection.

Note: Further inspections may incur additional cost at time of Code Compliance Certificate issue.

| Inspections Record For Building Consent Number BCon09/0640 | | | | | | |
|---|---------------------------|-------------|------------------|---------------------------|------------------|--|
| <i>Inspection</i> | <i>When to Request</i> | <i>Date</i> | <i>Inspector</i> | <i>Complies with Code</i> | <i>Reinspect</i> | <i>Notes</i> |
| SANITARY DRAINS INSPECTION | Before backfilling drains | 30/07/2009 | Dave Hall | YES | NO | DRA 00210. No test as gradient too steep. All looked good- Palmers Plumbing on site. Neville advise septic tank and offal holes have been filled in. As- built to be supplied. (Neville advised drain had been laid as per the original plan). |



INSPECTION TIME REPORT

Building Consent Number BCon09/0640

| | |
|--|----|
| <i>Total Estimated Inspection Time</i> | 50 |
| <i>Total Actual Inspection Time</i> | 45 |
| <i>Inspection Time Difference</i> | 5 |
| At BC Issue Time to be charged. | |
| At Completion Positive amount = time to be credited Negative amount = time to be charged | |

Signed for and on behalf of the Wanganui District Council

Wanganui District Council



Drainage Inspection

N° DRA 00210

| Address | | | | |
|------------------------------|--|--|----------------------------------|---|
| 22 Shakespeare Rd. | | | | |
| Consent No | Date | Inspector | Re Inspect | Compliance |
| 9/0640. | 30/7/09 | D. Hall | No. | Yes. |
| Foul Water Drainage | Comment | | Septic Tank | Comment |
| System Used | <input type="checkbox"/> ANZS 3500 | <input checked="" type="checkbox"/> NZBC G13 | Tank Size | <input type="checkbox"/> OK <input checked="" type="checkbox"/> N/A |
| Drainage Material/Size | <input checked="" type="checkbox"/> OK | <input type="checkbox"/> N/A | Tank Location | <input checked="" type="checkbox"/> OK <input type="checkbox"/> N/A |
| Gradient | <input checked="" type="checkbox"/> OK | <input type="checkbox"/> N/A | Tank Venting/Filter | <input checked="" type="checkbox"/> OK <input type="checkbox"/> N/A |
| Bedding Material | <input checked="" type="checkbox"/> OK | <input type="checkbox"/> N/A | Effluent Disposal Field Location | <input checked="" type="checkbox"/> OK <input type="checkbox"/> N/A |
| Drainage Depth/Cover | <input checked="" type="checkbox"/> OK | <input type="checkbox"/> N/A | Type of Effluent Field | <input checked="" type="checkbox"/> OK <input type="checkbox"/> N/A |
| Inspection Fittings | <input checked="" type="checkbox"/> OK | <input type="checkbox"/> N/A | Length of Disposal Field | <input checked="" type="checkbox"/> OK <input type="checkbox"/> N/A |
| Gulley Traps Seal/Height | <input type="checkbox"/> OK | <input checked="" type="checkbox"/> N/A | Material in Disposal Field | <input checked="" type="checkbox"/> OK <input type="checkbox"/> N/A |
| Vents | <input type="checkbox"/> OK | <input checked="" type="checkbox"/> N/A | Geo Tech Cloth | <input checked="" type="checkbox"/> OK <input type="checkbox"/> N/A |
| Manholes Haunched | <input type="checkbox"/> OK | <input checked="" type="checkbox"/> N/A | Stormwater | |
| Pump Stations Alarmed/Vented | <input type="checkbox"/> OK | <input checked="" type="checkbox"/> N/A | Drainage Material Size | <input type="checkbox"/> OK <input checked="" type="checkbox"/> N/A |
| Retention Tanks | <input type="checkbox"/> OK | <input checked="" type="checkbox"/> N/A | Connected to Downpipes | <input type="checkbox"/> OK <input checked="" type="checkbox"/> N/A |
| Sumps | <input type="checkbox"/> OK | <input checked="" type="checkbox"/> N/A | Sumps/Manholes | <input type="checkbox"/> OK <input checked="" type="checkbox"/> N/A |
| Roof & Wall Penetrations | <input type="checkbox"/> OK | <input checked="" type="checkbox"/> N/A | Discharging to Approved System | <input type="checkbox"/> OK <input checked="" type="checkbox"/> N/A |
| Pressure Test | <input type="checkbox"/> OK | <input checked="" type="checkbox"/> N/A | | <input type="checkbox"/> OK <input checked="" type="checkbox"/> N/A |
| | <input checked="" type="checkbox"/> OK | <input type="checkbox"/> N/A | No test. | |
| Comments | | | | |
| | | | | |

Code Compliance Assessment Checklist
Building Consent No # BC ...910640

| | ITEM | YES | NO | N/A | COMMENTS |
|----|--|-----|----|-----|----------|
| 1 | Work complies with approved BC documentation - Sec 94 (1) | ✓ | | | |
| 2 | All the required inspections have been completed | ✓ | | | |
| 3 | BC conditions have been fulfilled | ✓ | | | |
| 4 | PIM requirements have been complied with | ✓ | | | |
| 5 | Damage deposit is released | | | ✓ | |
| 6 | Development contributions have been paid (Sec 94 (4)) | | | ✓ | |
| 7 | All documents have BC number on them | ✓ | | | |
| 8 | Sec 75-77 registered if applicable | | | ✓ | |
| 9 | Sec 72-74 registered on title if applicable | | | ✓ | |
| 10 | Energy work certificates have been provided (if required) sec 94 (3) | | | ✓ | |
| 11 | All inspection fees have been paid? | ✓ | | | |
| 12 | Specified systems are capable of performing in accordance with performance standards (sec 94 (1B)) | | | ✓ | |
| 13 | Is a compliance schedule required or requires amending (sec 100(2)) | | ✓ | | |
| 14 | Has there been a change of ownership (sec 364) | | ✓ | | |
| 15 | Any warnings or bans applied (sec 94 (2)) | | ✓ | | |
| 16 | Has the TA received any certificates issued by licensed building practitioners that relate to restricted work (sec 88 (10 and (2) nb: The restricted building work and LBP provisions do not come into effect until 30/11/2009 | | ✓ | | |
| 17 | Check the TA has been advised by a LBP that building work carried out under a building consent does not comply with that consent | | ✓ | | |
| 18 | Any amendments have been issued and whether documentation associated with these have been properly completed | | ✓ | | |
| 19 | Any outstanding documentation still to be collected such as | | ✓ | | |
| 20 | Photographs of elevations | | ✓ | | |
| 21 | Fire doors | | ✓ | | |
| 22 | Backflow | | ✓ | | |
| 23 | Lifts (electrical and installation) | | ✓ | | |
| 24 | Mechanical ventilation | | ✓ | | |
| 25 | List of consultants | | ✓ | | |
| 26 | Was Building Consent Lapsed? (Ref.T-25.5) | | ✓ | | |

Producer Statements:

A Producer Statement requires the following as a minimum requirement to be accepted by the Wanganui District Council:

- A written statement
- Header with 'Producer Statement'
- Who is issuing the Producer statement (suitably qualified and author of Producer statements)
- The Producer Statement must be addressed for the attention of the Wanganui District Council
- The applicable Building Consent number must be recorded
- Who has completed or designed the work identified (qualifications to undertake the work)
- The product name and specifications for application of product used
- What parts/clauses of the Building Code the work relates to
- Full legal description of the site where the work will be undertaken
- Clearly identifying what part of the Building Consent is covered by the Producer Statement
- Provide the sum of provisional indemnity insurance held

The author's name and signature:

- Qualifications
- Address
- Registration number
- Membership of professional organization
- Date the producer statement was produced

All information and documentation is present and correct, a Code Compliance Certificate can be issued.

Name: Chris Boyd

Signature: [Handwritten Signature]

Date: 15/6/11

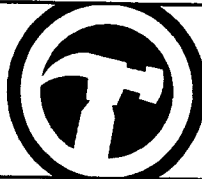

RECEIVED
5 APR 2011

1. The building consent

Building consent no.
Description of work
Address

2. Property owner details

Owner details Have not changed since the building consent was lodged Have changed since the building consent was lodged
Proceed to 3 "Applicant details" below

Name
Contact person (If owner is a corporation, partnership or trust)
Postal address
Contact numbers
Phone Mobile Fax
Email

Evidence of ownership attached (Only required if ownership has changed)
 Certificate of Title (copy) Sale and purchase agreement
 Lease agreement Other document showing full name of legal owner(s), such as a rate instalment notice

3. Applicant details

I am the Property owner Lessee Provide details below Agent
Authorised by owner / lessee Provide details below

Name
Postal address

Contact numbers
Phone Ph: (06) 345 5891 Fax: (06) 345 3941 Fax
Email

4. Attachments

The following documents are attached to this application:

Certificates from the personnel who carried out the work
 Certificates that relate to the energy work (e.g. gas or electrical certificates)
 Evidence that specified systems are capable of performing to the performance standards set out in the building consent

5. Key building practitioners

| | | | |
|-------------|-------------------------|----------------------|--|
| Designer | Name / Registration no. | | |
| | Contact details Address | | |
| | Phone / Email | | |
| Builder | Name / Registration no. | | |
| | Contact details Address | | |
| | Phone / Email | | |
| Drainlayer | Name / Registration no. | Neville Palmer 12563 | |
| | Contact details Address | | |
| | Phone / Email | | |
| Plumber | Name / Registration no. | | |
| | Contact details Address | | |
| | Phone / Email | | |
| Gasfitter | Name / Registration no. | | |
| | Contact details Address | | |
| | Phone / Email | | |
| Electrician | Name / Registration no. | | |
| | Contact details Address | | |
| | Phone / Email | | |
| Other | Name / Registration no. | | |
| | Contact details Address | | |
| | Phone / Email | | |

6. Application

Date building work completed

I request that you issue a code compliance certificate for the work under section 95 of the Building Act 2004. I understand that the code compliance certificate will be sent to the property owner.

Signature 4/14/11 Date

Name (print clearly)

OFFICE USE ONLY

| | | | | | | | |
|---------------|----------------------|---------------|----------------------|------------|----------------------|-------------|-------------------------|
| Date received | <input type="text"/> | Application # | <input type="text"/> | Document # | <input type="text"/> | Project # | <input type="text"/> |
| Property ID | <input type="text"/> | Legal ID | <input type="text"/> | Receipt # | <input type="text"/> | Amount Paid | \$ <input type="text"/> |



CODE COMPLIANCE CERTIFICATE NUMBER BCon09/0640

Section 95(3), Building Act 2004

Mr PJ Kubiak, Mrs HM Kubiak
22 Shakespeare Road
Bastia Hill
Wanganui 4500

**Building Consent
No:** BCon09/0640

Issue Date: 15/06/2011

The building:

| | |
|------------------------------------|---|
| Street address of building: | Legal description of land where building is located: |
| 22 Shakespeare Rd WANGANUI | LOT 11 DP 1304 Part 0.1545 Ha |
| Building name: | Location of building within site/block number: |
| | |
| Level/unit number: | Current, lawfully established, use: [include number of occupants per level and per use if more than 1] |
| 0.000000 | Plumbing and Drainage work only |
| Year first constructed: | |
| | |

The owner:

| | |
|---|---|
| Name of Owner: | |
| Mr PJ Kubiak, Mrs HM Kubiak | |
| Mailing address: | Street Address/registered Office: |
| 22 Shakespeare Road Bastia Hill Wanganui 4500 | 22 Shakespeare Road Bastia Hill Wanganui 4500 |

Phone numbers:

| | | | |
|--------------------------|---------|---------------------|--|
| Landline: | 3439344 | Mobile: | |
| Daytime: | | After hours: | |
| Facsimile number: | | | |
| Email address: | | Website: | |

First point of contact for communications with the building consent authority:

| | |
|------------------------------|--|
| Contact Person: | |
| Palmer's Plumbing & Heating | |
| Mailing address: | Street Address/registered Office: |
| 27 Heads Road, Wanganui 4500 | 27 Heads Road, Wanganui 4500 |

Phone number:

| | | | |
|--------------------------|-------------------|---------------------|--|
| Landline: | <ApplicantHomePh> | Mobile: | |
| Daytime: | 3455891 | After hours: | |
| Facsimile number: | 3453941 | | |
| Email address: | | Website: | |

Building Work

| | |
|---|---------------------------|
| Building consent number: | Issued by: |
| BCon09/0640 | Wanganui District Council |
| Type of Work | |
| Plumbing and Drainage work only | |
| Description of Work | |
| Connect Sanitary Sewer to Existing WDC connection (cat:1) | |
| Intended Life | Estimated Value |
| 50 years | \$2000.00 |

Code compliance:

The building consent authority named below is satisfied, on reasonable grounds, that the building work complies with the building consent.

This is a final Code Compliance Certificate issued in respect of all of the building work under the above Building Consent.

Signed for and on behalf of the Wanganui District Council:

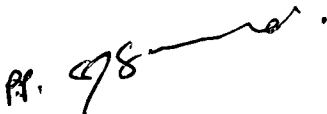

A J Jamieson
Team Leader Building Services

Date: 15 June, 2011



END OF BUILDING CONSENT FILE

BC No. 9/0640