



**RECORD OF TITLE
UNDER LAND TRANSFER ACT 2017
UNIT TITLE**

**Guaranteed Search Copy issued under Section 60 of the Land
Transfer Act 2017**



R. W. Muir
Registrar-General
of Land

Identifier **35795**
Land Registration District **Wellington**
Date Issued 21 May 2002

Prior References
25942

Supplementary Record Sheet
WN58B/154

Estate Stratum in Freehold
Legal Description Unit 9F Deposited Plan 90482
Registered Owners
Hastings Limited

The above estates are subject to the reservations, restrictions, encumbrances, liens and interests noted below and on the relevant unit plan and supplementary record sheet

Approx SHEET 1 OF 3 SHEETS

Pa. K. Lane, Proprietor W.A.

Myra D. Decker

Registered Proprietors

I hereby certify that this plan was approved by the Wellington City Council pursuant to section 224(4) of the Unit Titles Act, 1972, on the 23rd day of November, 2000 for the purpose of section 224(4) of that Act and that the consent has been complied with to the satisfaction of the said Council.

Authorised Officer

Pursuant to section 224(4) of the Unit Titles Act 1972, I, Wynne Paterson, Principal Surveyor, Wellington City Council, hereby certify that this plan has been erected and all other development work has been carried out to the extent necessary to comply with the provisions of the Unit Titles Act 1972. Dated this 23rd day of November, 2000.

Principal Surveyor

Administrative Officer

Pursuant to section 224(4) of the Resource Management Act 1991, I hereby certify that this plan has been erected and all other development work has been carried out to the extent necessary to comply with the provisions of the Resource Management Act 1991. Dated this 23rd day of November, 2000.

Authorised Officer

Authorised Officer

Authorised Officer

Authorised Officer

Authorised Officer

Authorised Officer

Authorised Officer

Authorised Officer

Authorised Officer

Authorised Officer

Authorised Officer

Authorised Officer

Authorised Officer

Authorised Officer

Authorised Officer

Authorised Officer

Authorised Officer

Authorised Officer

Authorised Officer

Authorised Officer

Authorised Officer

Authorised Officer

Authorised Officer

Authorised Officer

Authorised Officer

Authorised Officer

Authorised Officer

Authorised Officer

Authorised Officer

Authorised Officer

Authorised Officer

Authorised Officer

Authorised Officer

CT. ALLOCATED	APPELLATION	APPROX AREA (m ²)	UNIT ENTITLEMENT	HEIGHT (m)	LIMITS
588/153	UNIT 1A	26	100	12.57	10.05
588/153	UNIT 1B	26	100	12.57	10.05
588/153	UNIT 1C	26	100	12.57	10.05
588/153	UNIT 1D	26	100	12.57	10.05
588/153	UNIT 1E	26	100	12.57	10.05
588/153	UNIT 1F	26	100	12.57	10.05
588/153	UNIT 1G	26	100	12.57	10.05
588/153	UNIT 1H	26	100	12.57	10.05
588/153	UNIT 1I	26	100	12.57	10.05
588/153	UNIT 1J	26	100	12.57	10.05
588/153	UNIT 1K	26	100	12.57	10.05
588/153	UNIT 1L	26	100	12.57	10.05
588/153	UNIT 1M	26	100	12.57	10.05
588/153	UNIT 1N	26	100	12.57	10.05
588/153	UNIT 1O	26	100	12.57	10.05
588/153	UNIT 1P	26	100	12.57	10.05
588/153	UNIT 1Q	26	100	12.57	10.05
588/153	UNIT 1R	26	100	12.57	10.05
588/153	UNIT 1S	26	100	12.57	10.05
588/153	UNIT 1T	26	100	12.57	10.05
588/153	UNIT 1U	26	100	12.57	10.05
588/153	UNIT 1V	26	100	12.57	10.05
588/153	UNIT 1W	26	100	12.57	10.05
588/153	UNIT 1X	26	100	12.57	10.05
588/153	UNIT 1Y	26	100	12.57	10.05
588/153	UNIT 1Z	26	100	12.57	10.05

CT. ALLOCATED	APPELLATION	APPROX AREA (m ²)	UNIT ENTITLEMENT	HEIGHT (m)	LIMITS
588/153	UNIT 2A	26	100	12.57	10.05
588/153	UNIT 2B	26	100	12.57	10.05
588/153	UNIT 2C	26	100	12.57	10.05
588/153	UNIT 2D	26	100	12.57	10.05
588/153	UNIT 2E	26	100	12.57	10.05
588/153	UNIT 2F	26	100	12.57	10.05
588/153	UNIT 2G	26	100	12.57	10.05
588/153	UNIT 2H	26	100	12.57	10.05
588/153	UNIT 2I	26	100	12.57	10.05
588/153	UNIT 2J	26	100	12.57	10.05
588/153	UNIT 2K	26	100	12.57	10.05
588/153	UNIT 2L	26	100	12.57	10.05
588/153	UNIT 2M	26	100	12.57	10.05
588/153	UNIT 2N	26	100	12.57	10.05
588/153	UNIT 2O	26	100	12.57	10.05
588/153	UNIT 2P	26	100	12.57	10.05
588/153	UNIT 2Q	26	100	12.57	10.05
588/153	UNIT 2R	26	100	12.57	10.05
588/153	UNIT 2S	26	100	12.57	10.05
588/153	UNIT 2T	26	100	12.57	10.05
588/153	UNIT 2U	26	100	12.57	10.05
588/153	UNIT 2V	26	100	12.57	10.05
588/153	UNIT 2W	26	100	12.57	10.05
588/153	UNIT 2X	26	100	12.57	10.05
588/153	UNIT 2Y	26	100	12.57	10.05
588/153	UNIT 2Z	26	100	12.57	10.05

CT. ALLOCATED	APPELLATION	APPROX AREA (m ²)	UNIT ENTITLEMENT	HEIGHT (m)	LIMITS
588/153	UNIT 3A	26	100	12.57	10.05
588/153	UNIT 3B	26	100	12.57	10.05
588/153	UNIT 3C	26	100	12.57	10.05
588/153	UNIT 3D	26	100	12.57	10.05
588/153	UNIT 3E	26	100	12.57	10.05
588/153	UNIT 3F	26	100	12.57	10.05
588/153	UNIT 3G	26	100	12.57	10.05
588/153	UNIT 3H	26	100	12.57	10.05
588/153	UNIT 3I	26	100	12.57	10.05
588/153	UNIT 3J	26	100	12.57	10.05
588/153	UNIT 3K	26	100	12.57	10.05
588/153	UNIT 3L	26	100	12.57	10.05
588/153	UNIT 3M	26	100	12.57	10.05
588/153	UNIT 3N	26	100	12.57	10.05
588/153	UNIT 3O	26	100	12.57	10.05
588/153	UNIT 3P	26	100	12.57	10.05
588/153	UNIT 3Q	26	100	12.57	10.05
588/153	UNIT 3R	26	100	12.57	10.05
588/153	UNIT 3S	26	100	12.57	10.05
588/153	UNIT 3T	26	100	12.57	10.05
588/153	UNIT 3U	26	100	12.57	10.05
588/153	UNIT 3V	26	100	12.57	10.05
588/153	UNIT 3W	26	100	12.57	10.05
588/153	UNIT 3X	26	100	12.57	10.05
588/153	UNIT 3Y	26	100	12.57	10.05
588/153	UNIT 3Z	26	100	12.57	10.05

CT. ALLOCATED	APPELLATION	APPROX AREA (m ²)	UNIT ENTITLEMENT	HEIGHT (m)	LIMITS
588/153	UNIT 4A	26	100	12.57	10.05
588/153	UNIT 4B	26	100	12.57	10.05
588/153	UNIT 4C	26	100	12.57	10.05
588/153	UNIT 4D	26	100	12.57	10.05
588/153	UNIT 4E	26	100	12.57	10.05
588/153	UNIT 4F	26	100	12.57	10.05
588/153	UNIT 4G	26	100	12.57	10.05
588/153	UNIT 4H	26	100	12.57	10.05
588/153	UNIT 4I	26	100	12.57	10.05
588/153	UNIT 4J	26	100	12.57	10.05
588/153	UNIT 4K	26	100	12.57	10.05
588/153	UNIT 4L	26	100	12.57	10.05
588/153	UNIT 4M	26	100	12.57	10.05
588/153	UNIT 4N	26	100	12.57	10.05
588/153	UNIT 4O	26	100	12.57	10.05
588/153	UNIT 4P	26	100	12.57	10.05
588/153	UNIT 4Q	26	100	12.57	10.05
588/153	UNIT 4R	26	100	12.57	10.05
588/153	UNIT 4S	26	100	12.57	10.05
588/153	UNIT 4T	26	100	12.57	10.05
588/153	UNIT 4U	26	100	12.57	10.05
588/153	UNIT 4V	26	100	12.57	10.05
588/153	UNIT 4W	26	100	12.57	10.05
588/153	UNIT 4X	26	100	12.57	10.05
588/153	UNIT 4Y	26	100	12.57	10.05
588/153	UNIT 4Z	26	100	12.57	10.05

CT. ALLOCATED	APPELLATION	APPROX AREA (m ²)	UNIT ENTITLEMENT	HEIGHT (m)	LIMITS
588/153	UNIT 5A	26	100	12.57	10.05
588/153	UNIT 5B	26	100	12.57	10.05
588/153	UNIT 5C	26	100	12.57	10.05
588/153	UNIT 5D	26	100	12.57	10.05
588/153	UNIT 5E	26	100	12.57	10.05
588/153	UNIT 5F	26	100	12.57	10.05
588/153	UNIT 5G	26	100	12.57	10.05
588/153	UNIT 5H	26	100	12.57	10.05
588/153	UNIT 5I	26	100	12.57	10.05
588/153	UNIT 5J	26	100	12.57	10.05
588/153	UNIT 5K	26	100	12.57	10.05
588/153	UNIT 5L	26	100	12.57	10.05
588/153	UNIT 5M	26	100	12.57	10.05
588/153	UNIT 5N	26	100	12.57	10.05
588/153	UNIT 5O	26	100	12.57	10.05
588/153	UNIT 5P	26	100	12.57	10.05
588/153	UNIT 5Q	26	100	12.57	10.05
588/153	UNIT 5R	26	100	12.57	10.05
588/153	UNIT 5S	26	100	12.57	10.05
588/153	UNIT 5T	26	100	12.57	10.05
588/153	UNIT 5U	26	100	12.57	10.05
588/153	UNIT 5V	26	100	12.57	10.05
588/153	UNIT 5W	26	100	12.57	10.05
588/153	UNIT 5X	26	100	12.57	10.05
588/153	UNIT 5Y	26	100	12.57	10.05
588/153	UNIT 5Z	26	100	12.57	10.05

CT. ALLOCATED	APPELLATION	APPROX AREA (m ²)	UNIT ENTITLEMENT	HEIGHT (m)	LIMITS
588/153	UNIT 6A	26	100	12.57	10.05
588/153	UNIT 6B	26	100	12.57	10.05
588/153	UNIT 6C	26	100	12.57	10.05
588/153	UNIT 6D	26	100	12.57	10.05
588/153	UNIT 6E	26	100	12.57	10.05
588/153	UNIT 6F	26	100	12.57	10.05
588/153	UNIT 6G	26	100	12.57	10.05
588/153	UNIT 6H	26	100	12.57	10.05
588/153	UNIT 6I	26	100	12.57	10.05
588/153	UNIT 6J	26	100	12.57	10.05
588/153	UNIT 6K	26	100	12.57	10.05
588/153	UNIT 6L	26	100	12.57	10.05
588/153	UNIT 6M	26	100	12.57	10.05
588/153	UNIT 6N	26	100	12.57	10.05
588/153	UNIT 6O	26	100	12.57	10.05
588/153	UNIT 6P	26	100	12.57	10.05
588/153	UNIT 6Q	26	100	12.57	10.05
588/153	UNIT 6R	26	100	12.57	10.05
588/153	UNIT 6S	26	100	12.57	10.05
588/153	UNIT 6T	26	100	12.57	10.05
588/153	UNIT 6U	26	100	12.57	10.05
588/153	UNIT 6V	26	100	12.57	10.05
588/153	UNIT 6W	26	100	12.57	10.05
588/153	UNIT 6X	26	100	12.57	10.05
588/153	UNIT 6Y	26	100	12.57	10.05
588/153	UNIT 6Z	26	100	12.57	10.05

Address of Body Corporate -
39 Johnston Street,
Wellington.

Origin of Levels is O.M. 25.50 32468
in terms of the terms of
Mean sea Level, New City Datum.
(Source - WCC Bench Mark Records.)
Bench Mark is Iron spike flush behind 19th
Reduced Level = 1.80 metres in terms of
Mean sea Level, New City Datum.

I

Approved SHEET 2 OF 3 SHEETS

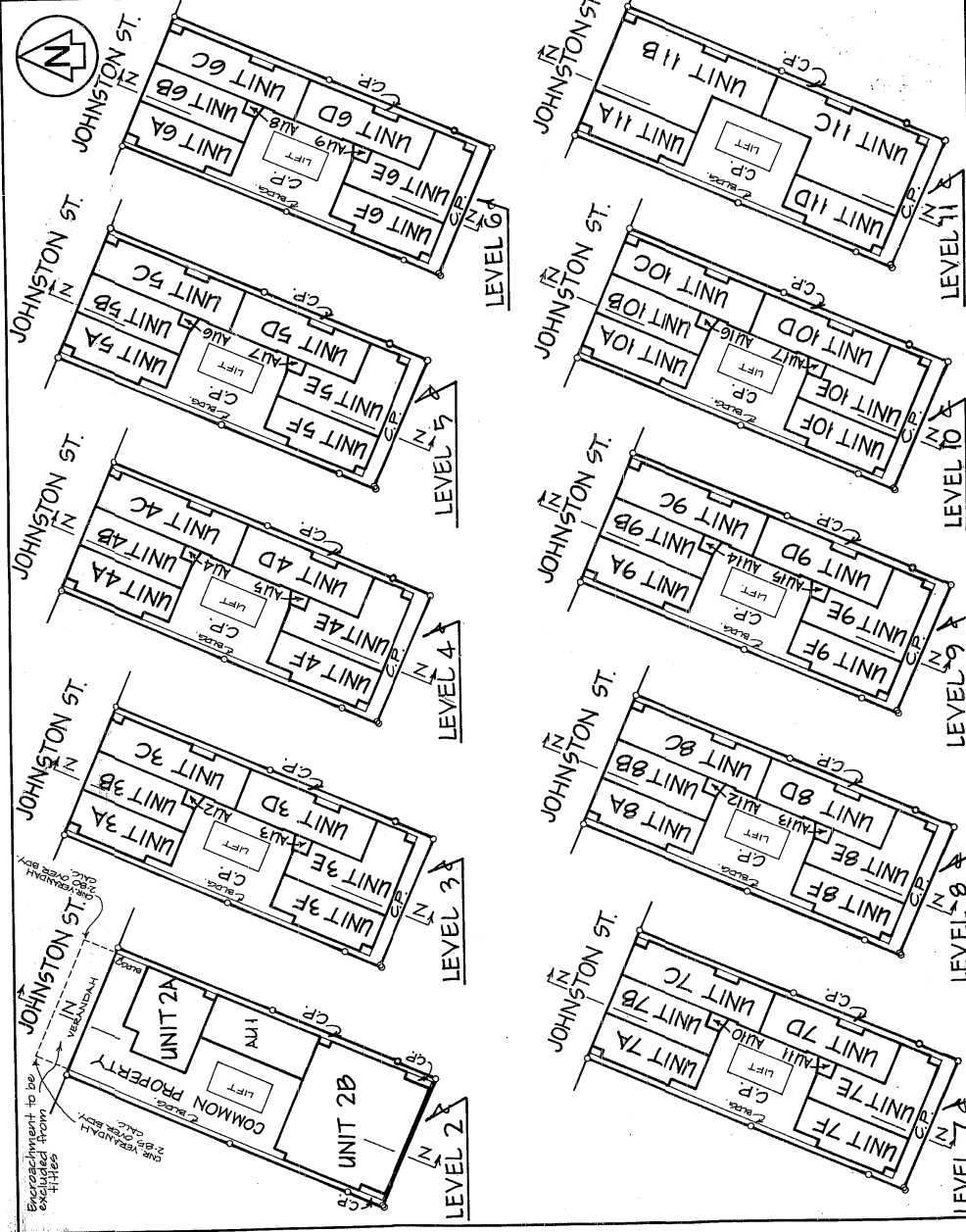

LAND DISTRICT WELLINGTON
 Survey Blk. & Bldg. Y11 PORT NICHOLSON
 NZMS 261 Sheet Record Map No.

UNITS ON LOT 4 D.P. 10804

TERRITORIAL AUTHORITY WELLINGTON CITY
 Surveyed by WYNNIE PATERSON M.L.E.O.D.
 Scale 1:200 Date MARCH 2000

Total Area _____
 Comprised in C.T. D2 / 929 (A1)

I, Russell Ian Paterson
 being a person entitled to practice as a registered surveyor (with) the
 Survey Regulations 1988, do hereby certify that the above plan and
 map are a true and correct copy of the original plan and map as
 made and made in accordance with the Survey Act 1988 and the
 Survey Regulations 1988.
 (b) This document is accurate and has been created in accordance with the Act and
 these Regulations.

Signed *RIP* Date 23.10.00

Field Book _____
 Reference Plan _____ SHEET 1

Examined _____
 Approved as to Survey Regulations 1988
 23/11/00
 Deposited this _____
 Registrar General of Land

File 99-857
 Referred 14/11/00
 Reference _____

90482

SHT. 2 OF 3 SHTS. M.C. 66 882

Approved SHEET 3 OF 3 SHEETS

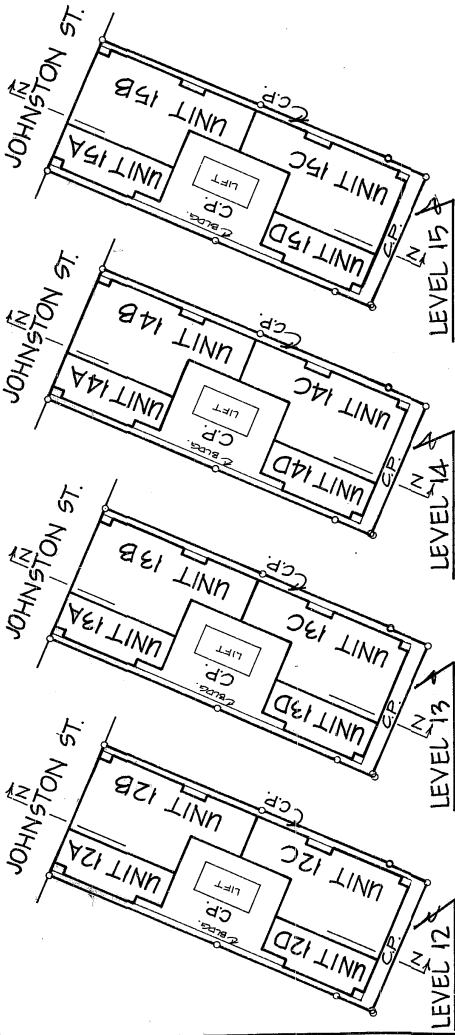

COMMON PROPERTY	FRONT 17D	FRONT 17C	FRONT 17B	FRONT 17A
LEVEL 18				
LEVEL 17				
LEVEL 16				
LEVEL 15				
LEVEL 14				
LEVEL 13				
LEVEL 12				
LEVEL 11				
LEVEL 10				
LEVEL 9				
LEVEL 8				
LEVEL 7				
LEVEL 6				
LEVEL 5				
LEVEL 4				
LEVEL 3				
LEVEL 2				
LEVEL 1				

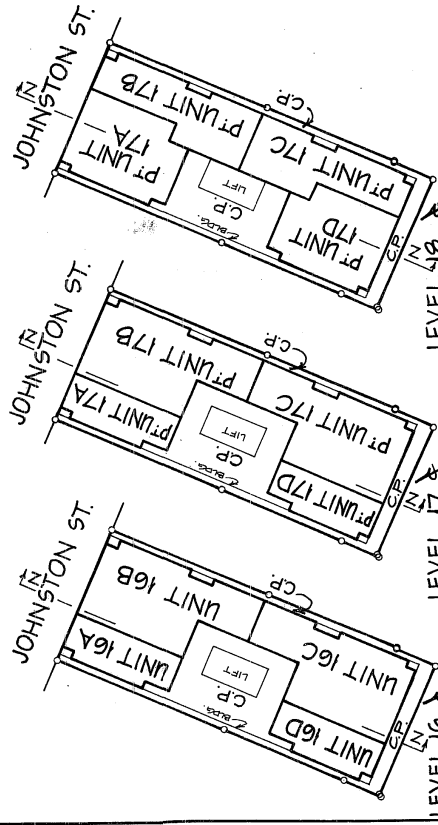

Scale ~ 1:400
SECTION Z-Z

TERRITORIAL AUTHORITY WELLINGTON CITY
Surveyed by WYNNIE PATERSON McLEOD
Scale 1:200 Date MARCH 2000

LAND DISTRICT WELLINGTON
Surveyor Bk. & Dist. VIII PORT NICHOLSON
NZMS 261 Sheet Record Map No.

UNITS ON LOT 4 D.P. 10804

Total Area _____
Compared in CT 52 / 1999 (A1)

Russell Ian Paterson
being a person entitled to practice as a registered surveyor certify that:
(a) The survey to which this document relates is accurate, and was undertaken by me or under my direction in accordance with the Survey Act 1986 and the Survey Regulations 1988;
(b) The boundaries shown on this plan have been created in accordance with the Act and the above Regulations.

Signer: *[Signature]* Date: 23.11.2000

Field Book _____
Reference Plans _____ SHEET _____
Examined _____
Approved as to Survey _____
23.11.2000
Deposited this _____
Register General of Land _____
90482
Registered 14.11.2000

SHT 3 OF 3 SHTS



**SUPPLEMENTARY RECORD SHEET
UNDER UNIT TITLES ACT 1972**

**Guaranteed Search Copy issued under Section 60 of the Land
Transfer Act 2017**

Identifier **WN58B/154**
Land Registration District **Wellington**
Date Issued 06 December 2000
Plan Number DP 90482

Subdivision of
 Lot 4 Deposited Plan 10804

Prior References
 WND2/939

Unit Titles Issued

12428	12429	25934	25935
25936	25937	25938	25939
25940	25941	26295	26296
26297	26298	35755	35756
35757	35758	35759	35760
35761	35762	35763	35764
35765	35766	35767	35768
35769	35770	35771	35772
35773	35774	35775	35776
35777	35778	35779	35780
35781	35782	35783	35784
35785	35786	35787	35788
35789	35790	35791	35792
35793	35794	35795	35796
35797	35798	35799	35800
35801	35802	35803	35804
35805	35806	35807	35808
35809	35810	35811	35812
35813	35814	35815	35816
WN58B/149	WN58B/151	WN58B/152	

Interests

OWNERSHIP OF COMMON PROPERTY

Pursuant to Section 47 Unit Titles Act 2010 -

(a) the body corporate owns the common property and

(b) the owners of all the units are beneficially entitled to the common property as tenants in common in shares proportional to the ownership interest (or proposed ownership interest) in respect of their respective units.

The above memorial has been added to Supplementary Record Sheets issued under the Unit Titles Act 1972 to give effect to Section 47 of the Unit Titles Act 2010.

B813990.4 Change of rules of the Body Corporate - 6.12.2000 at 3.31 pm

9199056.1 Notice of change of body corporate operational rules pursuant to Section 106 Unit Titles Act 2010 - 2.10.2012 at 2:10 pm

