



 **4**
  **2**
  **2**

Enquiries Over: \$875,000

More land, more sky, more ease

This is a gorgeous single-level home with a wide green outlook, and the kind of practicality that makes everyday life run more smoothly. And most importantly, the garage has pre wired EV charging capacity.

The living area is generous, with large windows, sliding doors to the deck, and enough width to create proper zones for reading, movie nights, or a full house at the weekend. The fabulous Mitsubishi Fresh Air Ventilation Ducted system ensures control of inside temperature at the flick of a remote (or from your phone.) Window treatments include remote controlled blinds in the lounge area - how convenient!

Silicon Way is tucked into a cul-de-sac known for its open outlooks, with nearby reserves, walking tracks and playgrounds, plus easy access to Summerhill Shopping Centre, Massey University and bus links into the city. Turitea School, Aokautere School, PNGHS and PNBHS are all options for the growing family.

Land Size 1269sqm
House Size 182sqm
RV\$860,000
Built 2021

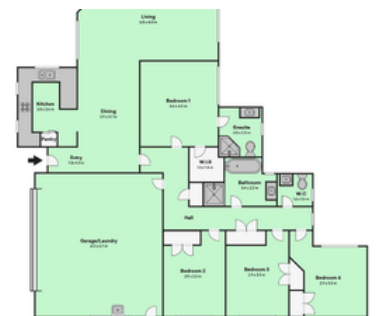



Milly Pivac

 027 3591820

 milly.p@arizto.co.nz



-  A Low Fair Commission*
-  No Upfront Costs
-  No Sale, No Fee