

Approvals

Total Area 166.7 m<sup>2</sup>

Comprised in C.T. 70A/372 (All)  
C.T. 70A/373 (All)

I, Donald Barrington von Sturmer  
Registered Surveyor and holder of an annual practising certificate (or who may act as a registered surveyor pursuant to section 25 of the Survey Act 1986) hereby certify that this plan has been made from surveys executed by me or under my directions, that both plan and survey are correct and have been made in accordance with the Survey Regulations 1972 or any regulations made in substitution thereof.  
Dated at Kaitiaki this ... day  
of ... 19 ... Signature

Field Book ... p. Traverse Book ... p.  
Reference Plans ...  
Examined ... Correct

Approved as to Survey

...../...../..... Chief Surveyor

Deposited this ..... day of ..... 19 .....

District Land Registrar

LAND DISTRICT North Auckland  
SURVEY BLK. & DIST. V Mangonui  
NZMS 261 SHT ..... RECORD MAP No 3

LOTS 1 & 2 BEING SUBDIVISION  
OF LOTS 7 & 8 D.P. 41348.

TERRITORIAL AUTHORITY For North District  
Surveyed by D.B. von Sturmer  
Scale 1: 200 Date February 1996

# Mill Bay

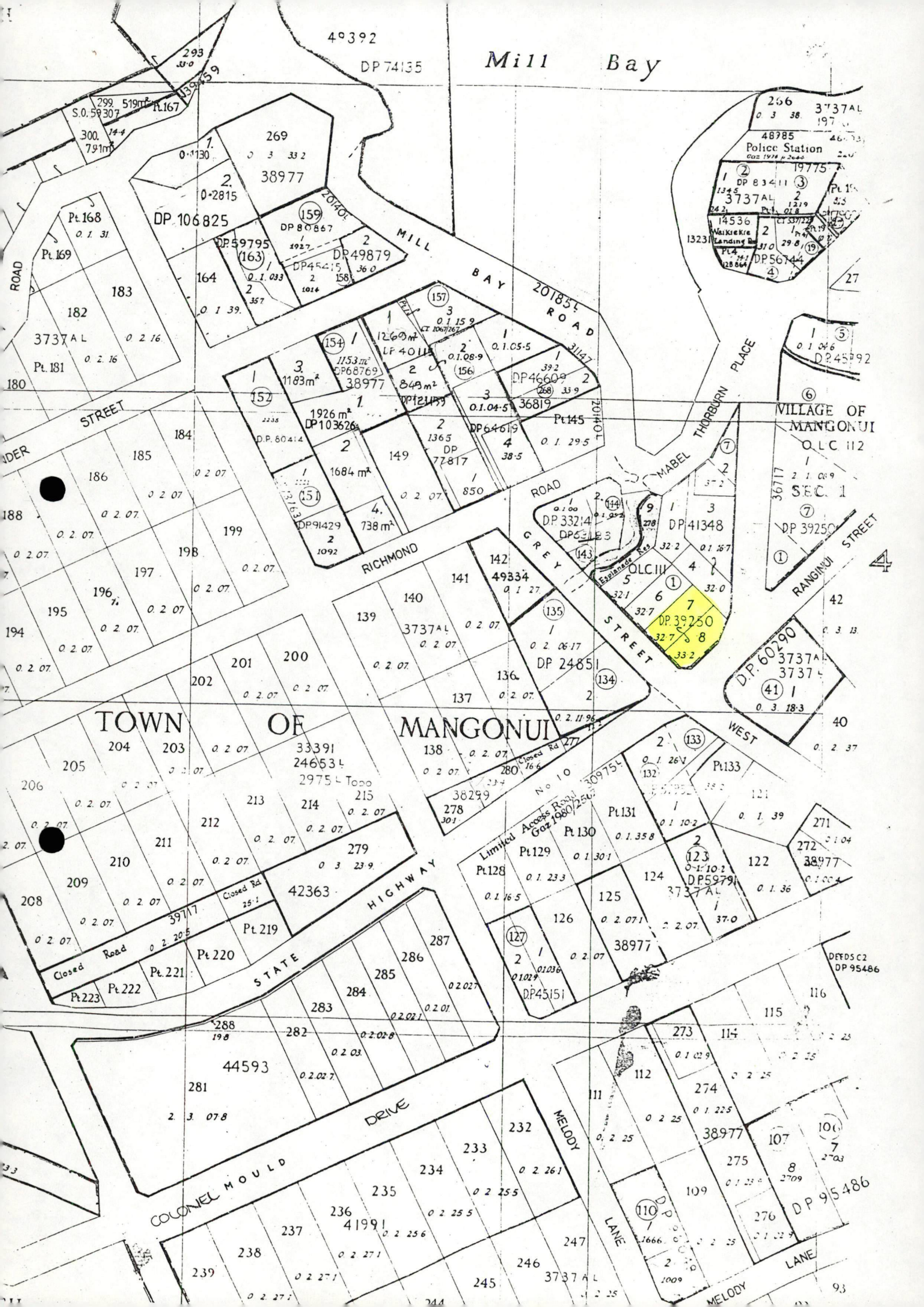

40392

DP 74135

299 519m²  
S.O. 59307  
Pt. 167

DP 106825

DP 49879  
DP 45415  
Pt. 159

256 3737AL  
0 3 38 197  
48785 46.73  
Police Station  
Gaz 1974 p. 244  
19775  
Pt. 15  
3737AL  
Pt. 12  
Pt. 11  
14536  
Pt. 10  
Pt. 9  
Pt. 8  
Pt. 7  
Pt. 6  
Pt. 5  
Pt. 4  
Pt. 3  
Pt. 2  
Pt. 1  
13231  
128664  
4

VILLAGE OF MANGONUI  
OLC II2

SEC. 1  
DP 39250

## TOWN OF MANGONUI

DP 60290  
3737AL  
3737  
41 1  
0 3 18-3

Limited Access Road  
Gaz 1980/250  
Pt. 128  
Pt. 129  
Pt. 130  
Pt. 131  
Pt. 133

COLONEL MOULD DRIVE

MELODY LANE

MELODY LANE

DP 95486