

Enhancing the quality of the environment



ENVIRONMENTAL SERVICES

WANGANUI DISTRICT COUNCIL

APPLICATION

for P.I.M / Building Consent

This application is for a: (tick the appropriate box)

- Project Information Memorandum - PIM (preliminary application for a Building Consent)
- Building Consent
- Alteration to Approved Plan

BC 12884

(A) Owner

Name: Mr Willis 36751

Mailing Address: RDA Wanganui

Phone: 345 2346 Fax: _____

(B) Designer

Name: _____

Mailing Address: _____

Phone: _____ Fax: _____

(C) Builder

Name: Palmers Plumbing (463)

Mailing Address: 293 Victoria Ave

Phone: 345 5891 Fax: _____

(D) Craftsman Plumber

Neville Palmer

(E) Registered Drainlayer

CONTACT PERSON i.e. A B C D E (Circle one)

Project

Description of PROJECT and USE: Instill (241)
Loggia Repairs Fire

Project Location

Street Address/Rural No.: 1656A Harkness Rd

Durable Life of Project (i.e. 5, 15, 50+ years)

7 yrs

Value of Project Work

(include all labour & materials)

\$ 2000 (Incl. G.S.T)

Consent Fees to be paid by? Palmers Plumbing

Code Compliance Certificate to be sent to? _____

Floor Area of Project

New Residential Dwellings or
New Commercial Only _____ m²

Signed by (or on behalf of) the applicant

Signature: [Signature]

owner, builder, plumber, designer, agent

Date: 4/9/98 (circle appropriate one)

Office use only

LEGAL DESCRIPTION

WDC Property No 26132
 Valuation Roll No 12880-459-02
 Lot(s) 2 DP 7993
 Section _____ Block _____
 Survey District _____

FEES APPLICABLE

Building Consent Application \$	_____
Building Consent Issue \$	_____
P.I.M \$	_____
Non-Notified Appl. Fee \$	_____
Prepaid Crossing \$	_____
Prepaid Sewer Connection \$	_____
Prepaid Water Connection \$	_____
Stormwater Connection \$	_____
Building Research Levy \$	_____
BIA Levy \$	_____
Additional Charges \$	_____
Total Fees (Incl. G.S.T) \$	65.00

PTO

The information will be included in a Public Register of Consents issued which is available for public perusal under the Privacy Act 1993 section 54. This may result in receipt by the Owner of trade advertising.

Project Details

The project involves the following:

(tick each applicable box, if any, and attach two (2) copies of any relevant information)

- (1) Location in relation to legal boundaries, and external dimensions of new, relocated or altered buildings
- (2) New provisions to be made for vehicular access and on-site parking, ie: a new crossing
- (3) Provisions to be made in building over or adjacent to any road or public place, ie: hoardings, signs
- (4) New provisions to be made for disposing of stormwater and wastewater
- (5) Precautions to be taken where building work is to take place over existing drains or sewers or in close proximity to wells or watermains
- (6) New connections to public utilities, ie: new drainage or water connections
- (7) Provisions to be made for any demolition work. ie: the protection of the public, suppression of dust, disposal of debris, disconnection from public utilities and suppression of noise
- (8) Any cultural heritage significance of the building or building site, including whether it is on a marae

Project Documents (provided with this application)

- Plans & Specifications
- (22) Producer Statements (ie: truss design, design review) - specify:
- (23) Other Documents - specify:

Inspections

- (26) By Wanganui District Council
- (27) Other - specify (ie: Design Engineer):

for office use only							
Unit	Checks				Inspections	Approved	
	Initials	Date	Initials	Date		No.	Initials
Administration	<i>[Signature]</i>	6/8					
Planning							
Building						<i>[Signature]</i>	7/8
Drainage							
Water							
Structural							
Plumbing/Drainage							
Roading							
Health							
Dangerous Goods							

Approved for issue of P.I.M./B Building Consent

District Building Controller: *[Signature]* Date: 1/0 AUG 1998

4-8-98.

Mr Wills

1656a Karikohape Rd

Wangarei

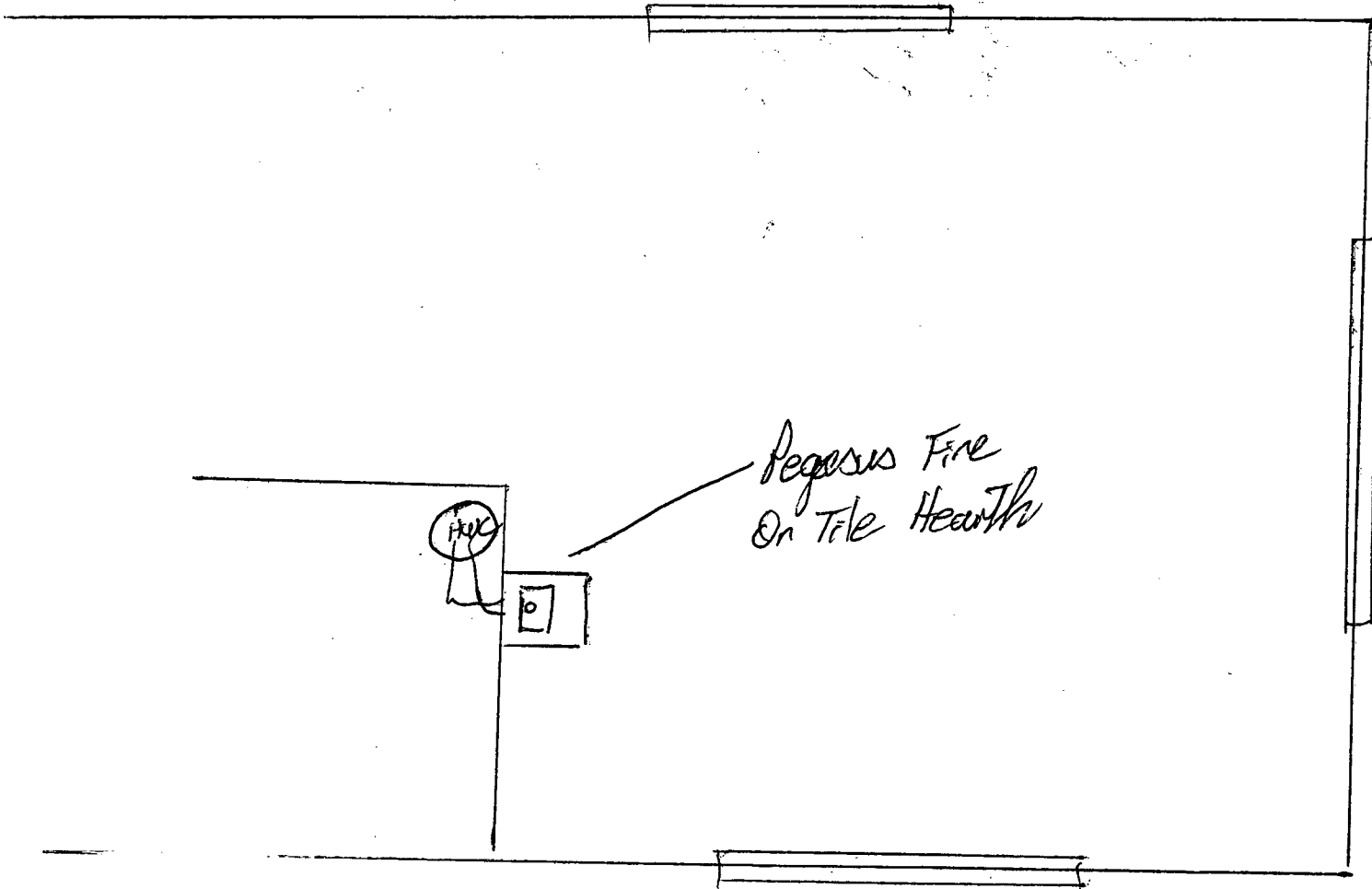

Pegasus Fire
On Tile Hearth

APPROVED

12884

Consent No.

Hearth Requirements

The Pegasus requires a hearth of minimum dimensions of 860mm wide by 865mm deep. The hearth must extend at least 300mm forward of the door of the heater and at least 100mm to each side of the heater. The hearth must be constructed of masonry of at least 50mm thickness, or any suitable fire retardant board, i.e. Micore 160*, Woodtex* or Rockboard, covered by tiles, slate or marble, or any alternative thermal insulation of equivalent K-value. A provision has been made at the rear of the pedestal for seismic restraint by bolting through the two holes through the hearth and floor.

* Refer to manufacturer's instructions.

Clearance Requirements

The Pegasus has been tested to the New Zealand Standard NZS 7421:1990 and all installations must be in accordance with the minimum clearances to combustibles indicated in these instructions.

The minimum clearances to combustibles may be reduced if the combustible walls are shielded with an approved non-combustible material. Details of suitable shielding materials and appropriate clearance reduction factors are presented in Section 3 of NZS 7421:1985 or 1990.

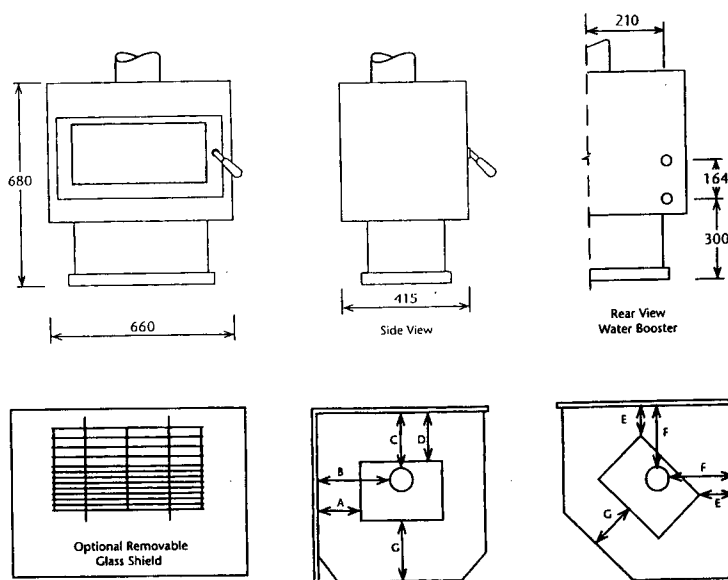

APPROVED

12884

Consent No.

Clean Air Certification No. 9117

Minimum clearance to combustibles in millimetres NZS 7421:1990

New Zealand	A	B	C	D	E	F	G
Without flue shield	275	530	510	425	200	480	300

Minimum clearance to combustibles in millimetres NZS 7421:1990

New Zealand	A	B	C	D	E	F	G
With stainless flue shield	200	455	235	150	50	330	300

Minimum clearance to combustibles in millimetres AS:2918 Australian Std

Australia	A	B	C	D	E	F	G
With 900mm stainless flue shield	300	535	210	100	100	380	300