



**RECORD OF TITLE
UNDER LAND TRANSFER ACT 2017
FREEHOLD**

**Guaranteed Search Copy issued under Section 60 of the Land
Transfer Act 2017**



R. W. Muir
Registrar-General
of Land

Identifier 155338
Land Registration District Hawkes Bay
Date Issued 03 August 2004

Prior References
HBA1/759

Estate Fee Simple
Area 903 square metres more or less
Legal Description Lot 1 Deposited Plan 337845
Registered Owners
Lisa Jane Ellis and Napier Independent Trustees (2008) Limited

Interests

Subject to a right of way over parts marked A, E and G and to sewerage rights over parts marked B, D and F on DP 337845 created by Transfer 160448

Appurtenant hereto is a right of way created by Transfer 160448

Subject to sewerage rights over parts marked C and D on DP 337845 created by Transfer 152710

Appurtenant hereto are sewerage, electric power and telephone line rights created by Transfer 152710

Appurtenant hereto are sewage rights created by Transfer 160447

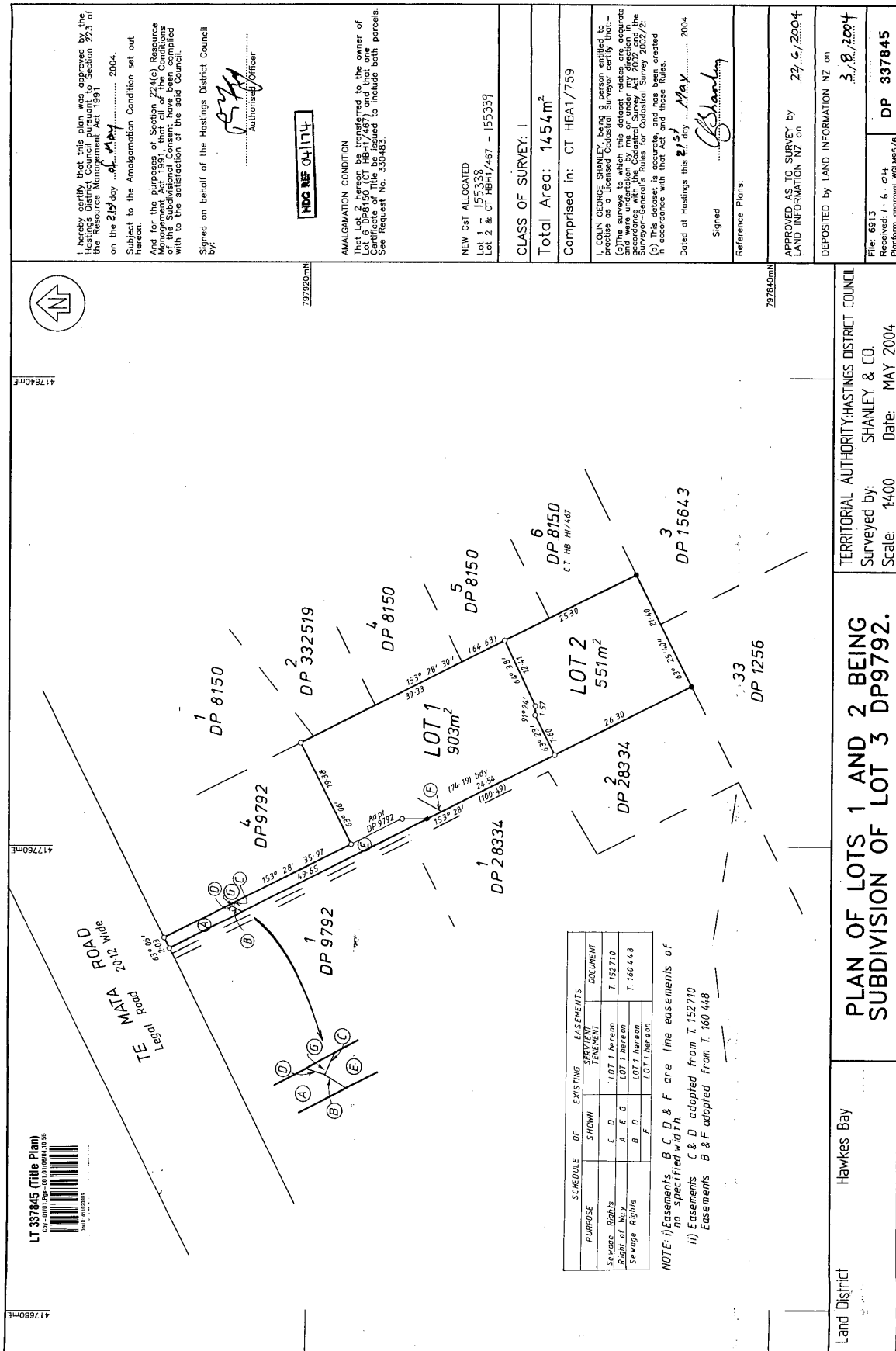

41760mE

41760mE

41760mE

LT 337845 (Title Plan)
 City Plan No. 160/01/00001/15/36
 DATE 15/05/2004

I hereby certify that this plan was approved by the Hastings District Council on the 23rd day of May 2004.
 Subject to the Amalgamation Condition set out hereon.
 And for the purposes of Section 224(C) Resource Management Act 1991, the Amalgamation Condition of the Subdivisional Consent, have been compiled with to the satisfaction of the said Council.

Signed on behalf of the Hastings District Council
 [Signature]
 Authorised Officer

HDC REF 041174

AMALGAMATION CONDITION
 That Lot 2 herein be transferred to the owner of Lot 6 DP8150 (CT HBH/467) and that one See Request No. 330483.

NEW CST ALLOCATED
 Lot 1 - 155338
 Lot 2 & CT HBH/467 - 155339

CLASS OF SURVEY: 1
 Total Area: 1454m²
 Comprised in: CT HBA1/759

I, COLIN GEORGE SHANLEY, being a person entitled to practise as a Licensed Cadastral Surveyor certify that the survey and the preparation of this plan were undertaken by me or under my direction in accordance with the Cadastral Survey Act 2002, and that the survey and the preparation of this plan were carried out in accordance with that Act and those Rules created in accordance with that Act and those Rules.

Dated at Hastings this 21st day of May 2004
 Signed [Signature]
 Reference Plans:

APPROVED AS TO SURVEY BY LAND INFORMATION NZ on 23/05/2004

DEPOSITED BY LAND INFORMATION NZ on 31/05/2004
 File: 6913
 Received: 16/04
 Platform approval WCLM95/6
DP 337845

PURPOSE	SHOWN	EXISTING	EASEMENTS	SERVIENT TENEMENT	DOCUMENT
Swathe Rights	C, D	LOT 1 hereon		LOT 1 hereon	T. 152710
Right of Way	A, E, G	LOT 1 hereon		LOT 1 hereon	T. 160448
Swathe Rights	B, D, F	LOT 1 hereon		LOT 1 hereon	

NOTE: i) Easements B, C, D, & F are line easements of no specified width.
 ii) Easements C & D adopted from T. 152710
 Easements B & F adopted from T. 160448

TERRITORIAL AUTHORITY-HASTINGS DISTRICT COUNCIL
 Surveyed by: SHANLEY & CO.
 Scale: 1:400 Date: MAY 2004

PLAN OF LOTS 1 AND 2 BEING SUBDIVISION OF LOT 3 DP9792.

Land District: Hawkes Bay