



Legend:

DCC Foul Sewer	
DCC Stormwater	
DCC Water	
Proposed Foul Sewer Lateral	
Proposed Stormwater Lateral	
Proposed Water Lateral	
Proposed Stage 2 Easements	
Existing Easements	

DO NOT SCALE - IF IN DOUBT, ASK

ORIGINAL SIZE A3

Note, Council has not reviewed and makes no statement as to whether any other building work (other than those for which this consent is granted) either existing or proposed, referred to or shown on the application, plan, diagram or specification, comply with the NZ Building Code or has been legally established.

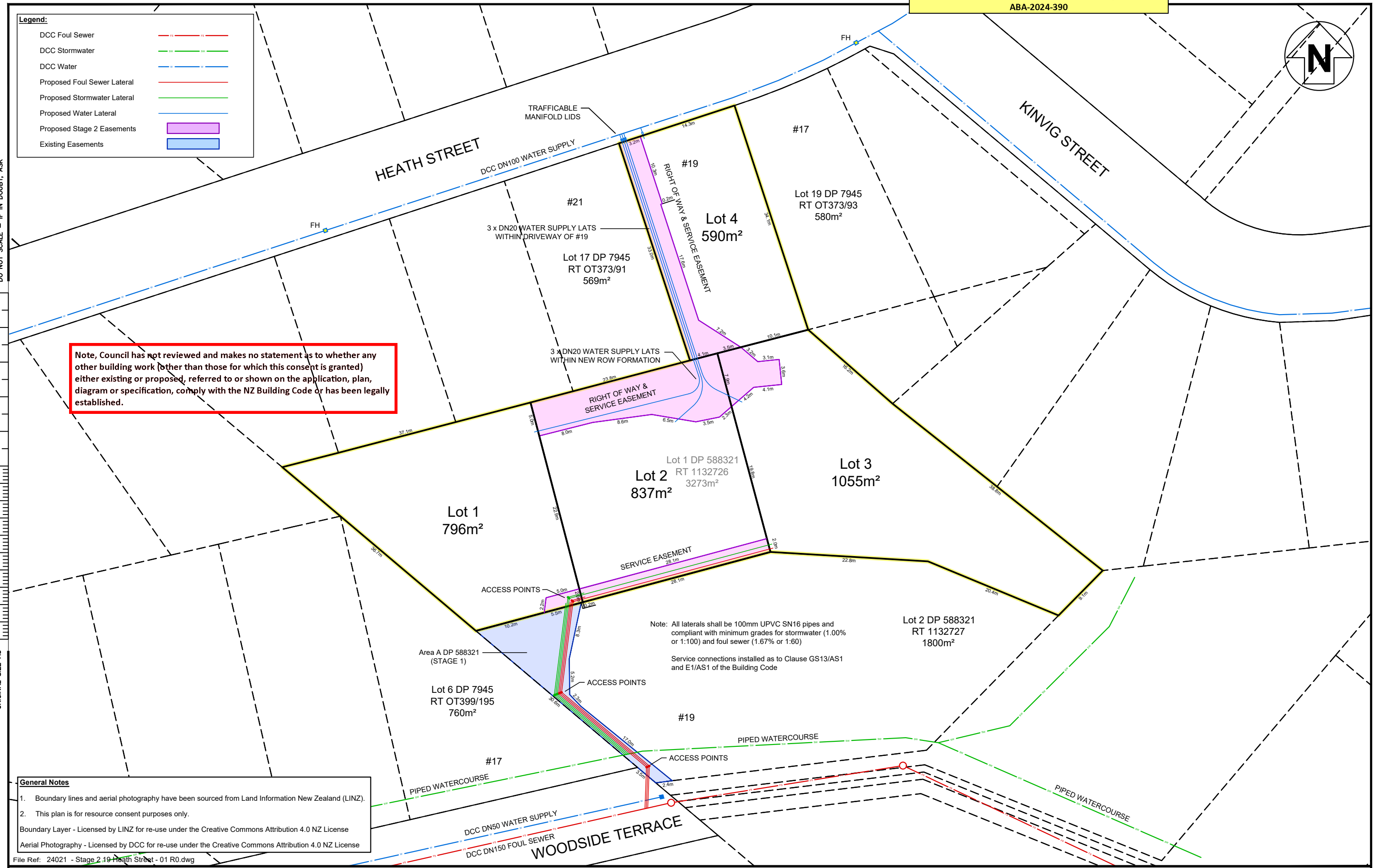

General Notes

- Boundary lines and aerial photography have been sourced from Land Information New Zealand (LINZ).
- This plan is for resource consent purposes only.

Boundary Layer - Licensed by LINZ for re-use under the Creative Commons Attribution 4.0 NZ License
Aerial Photography - Licensed by DCC for re-use under the Creative Commons Attribution 4.0 NZ License

File Ref: 24021 - Stage 2 19 Heath Street - 01 R0.dwg

Prepared For:
HEATH STREET HOLDINGS LIMITED

No.	Amendments	Drawn	Date
R1	Additional notes for access points, pipe class and gradients	CD	13/06/24
R2	Access points added, revised plan note	CD	13/06/24

19 HEATH STREET, DUNEDIN

PROPOSED SERVICING LAYOUT

STAGE 2 - LOTS 1-4 BEING A SUBDIVISION OF LOT 1 DP 588321

Project No.: 24046	Surveyed:
Scale: 1:500 (A3)	Designed:
Date: 24 APR 2024	Drawn: CD
Sheet: 01	Checked:

Surveying Consultants

TL Survey Services Limited
P.O. Box 901 DUNEDIN
Phone (03) 477 1133