

WAITOTARA COUNTY COUNCIL
BUILDING BY-LAWS
APPLICATION FOR BUILDING PERMIT

Date 2nd Sept. 1970.

To The Building Inspector
 WAITOTARA COUNTY COUNCIL.

I hereby apply for permission to Erect a growing house.

(Describe proposed work)

at Brunswick Rd. Wanganui according to locality plan, detailed plans elevations, cross sections and specifications of building deposited herewith.

PARTICULARS OF LAND: Lot No. 3 D.P. 2187 Section 288 R.D.W.R.

Block III S.D. Westmere Township

Riding Brunswick - Westmere Asst. No. 1288/494.

Length of Boundaries Area 5a. OR. 36p.

PARTICULARS OF NEW BUILDING: FOUNDATION _____ WALLS Plastic.

ROOF Netting & Plastic

Area of Ground Floor 950 sq. ft. Squar

Area of Building Squar

ESTIMATED VALUE: Buildi

\$200

Plumbi
 Draina
 Not

FEES DUE BEFORE ISSUE OF PERMIT

RECEIPT No.

1. BUILDING (INSPECTION) FEE	\$ 1-00	398 ^D
2. CROSSING FEE	\$	
3. WATER CONNECTION	\$	
4. DEPOSIT—RE DAMAGE TO FOOTPATH OR KERB	\$	
TOTAL FEES TO COUNTY	\$ 1-00	398 ^D
PLUS BUILDING RESEARCH LEVY (Over \$3000)	\$	
GRAND TOTAL	\$ 1-00	

Proposed purposes for which every part of building is to be intended for use or occupation for a separate purpose).

Name of OWNER: R. L. Robottom

Postal Address Brunswick Rd. R.D.1. Wanganui Telephone 36490.

Name of BUILDER As Above

Postal Address Telephone

Name of Plumber and or Drainlayer _____

Signature of Applicant R. L. Robottom
 (Builder or Owner)

NOTE: A separate application and fee is payable on any plumbing and drainage work. Attach Plan, Site Plan, Specifications.

FOR OFFICE USE ONLY

No. of Application 85 Fee \$ _____

Approved A. F. Puklowski Receipt No. _____

Date 4/9/70 Date of Receipt _____

Permit No. B071786

Date Issued 4/9/70

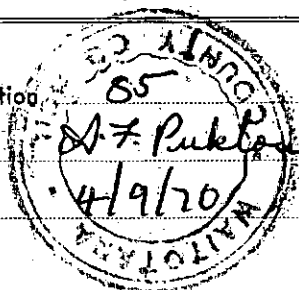

WAITOTARA COUNTY COUNCIL

MEMORANDUM.

ISSUE OF BUILDING PERMIT

To the County Clerk,

Re:- Building Application No

85

Owner

R. J. Robolton

Builder

As above

The above application has been approved and the permit will be issued when the following Fees have been paid.

1.	Building (Inspection) Fee	\$ <u>1.00</u>
2.	Crossing Fee	\$ <u>-</u>
3.	Water Connection	\$ <u>-</u>
4.	Deposit - Re Damage to Footpath or Kerb	\$ <u>-</u>
5.	Building Research Levy (Over \$3000)	\$ <u>-</u>
	TOTAL	\$ <u>1.00</u>

NOTE:

Plumbing and Drainage fee is also payable.

DATE

4/9/70

A. F. Puklowski INSPECTOR.

The Fees Above have been paid and the details placed upon original and duplicate application.

RECEIPT NUMBER/S

398D

DATE

4 September

M. Dakling CLERK

Proposed, Plastic House, for R.L. Robottom, Brunswick Rd. R.R.1 Wanganui
Front and Side Elevation

Netting top
Plastic centre
Netting Bottom

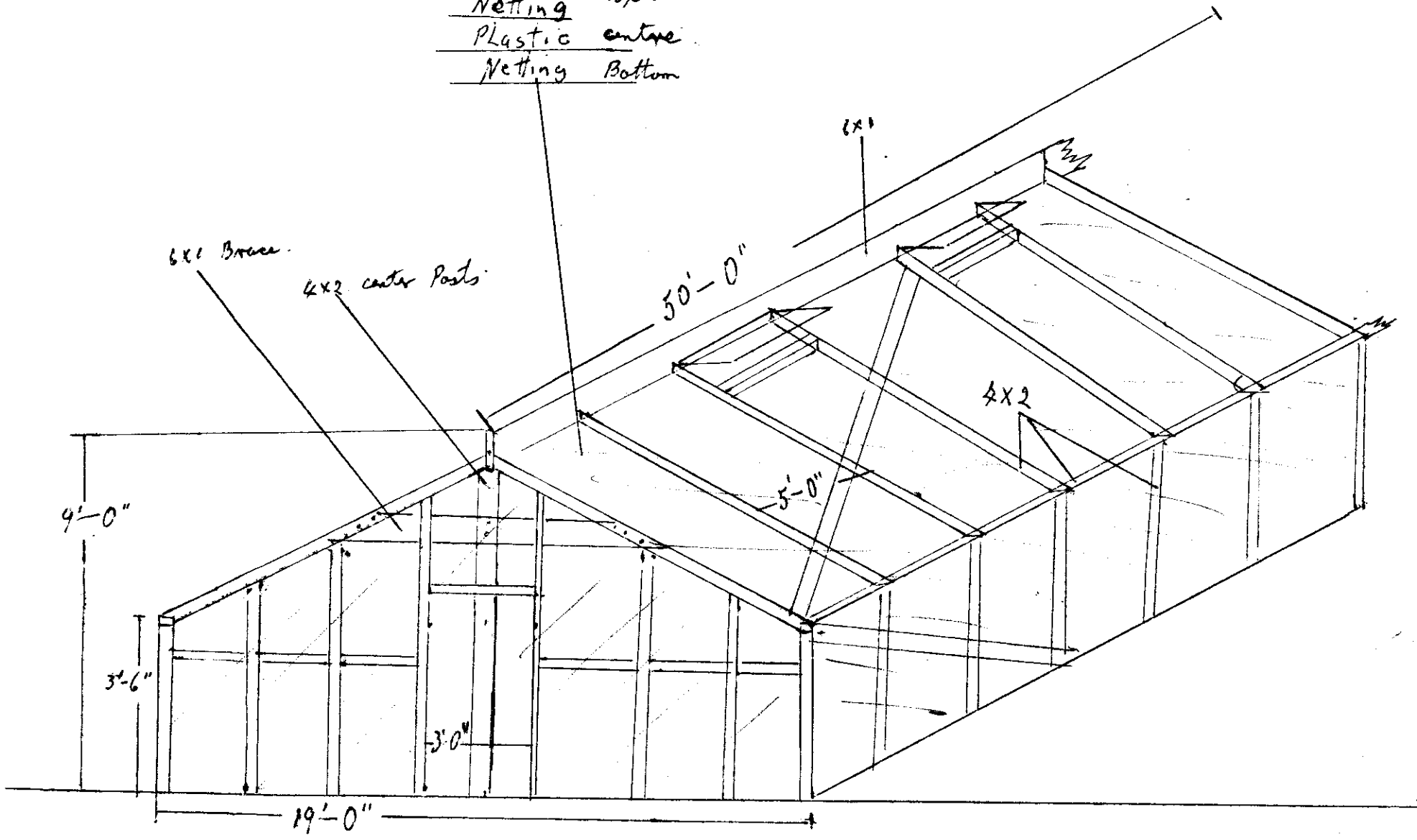

Site Plan for Plastic House

Brunswick Road

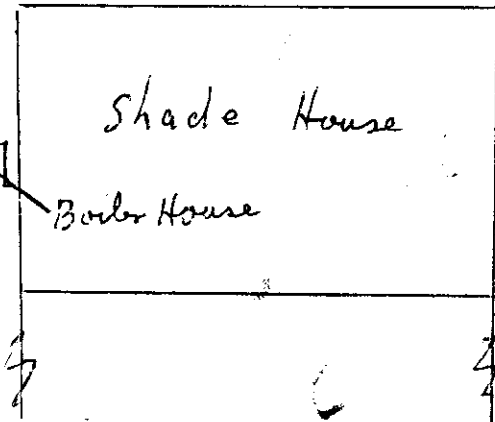
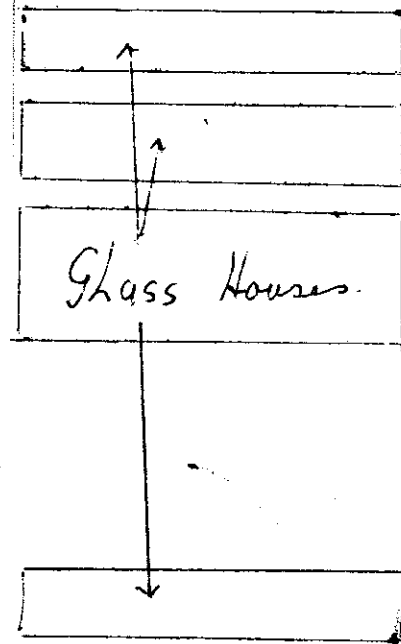
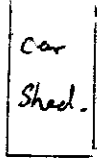

Property much more than 40'-00"

